

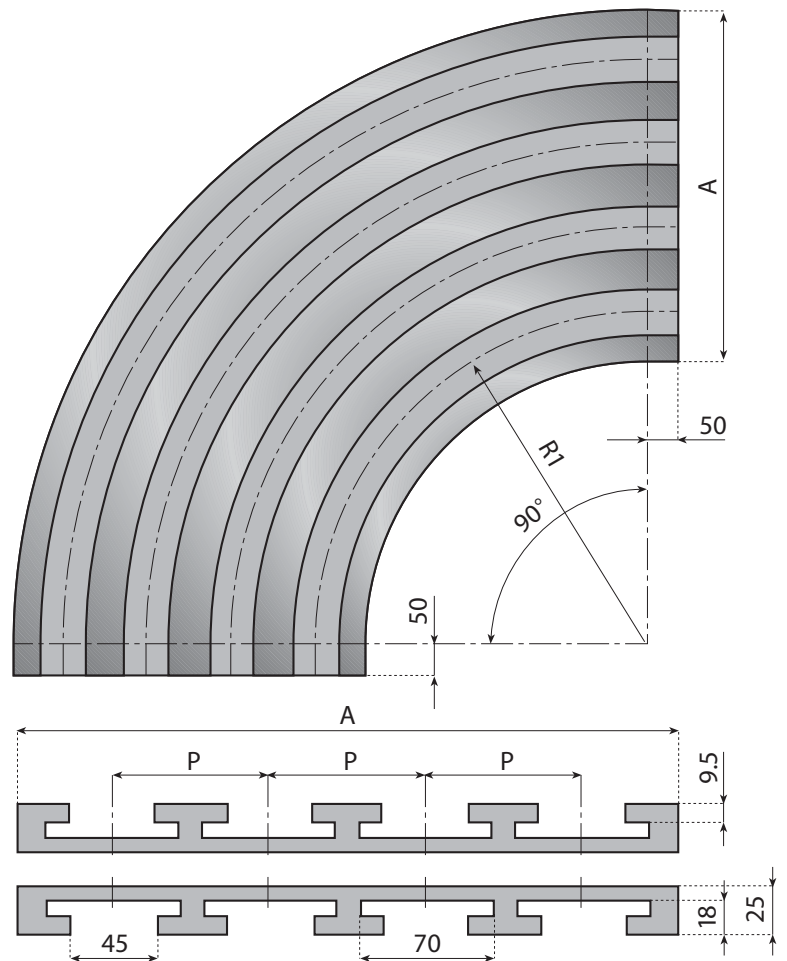

# CORNER TRACKS for chains series

878 TAB - 879 TAB - 880 TAB - 881 R TAB - 881 TAB - 8810 TAB



## CORNER TRACKS for chains series

878 TAB - 879 TAB - 880 TAB

881 R TAB - 881 TAB - 8810 TAB

• More tracks available on request.

**Material:** Ultra High Molecular Weight Polyethylene to provide minimum friction and reliable long term performance.

**Note:** max. continuous service temperature in air 90°C.  
Water absorption coefficient = 0.

**Colour:** black.

**Supply:** corner tracks are supplied complete with carry and return plates.



For chains type see pages 28 → 29  
55 - 56  
80 - 81  
90 - 91

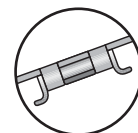

**For steel chains, type:**  
881 R TAB • 881 TAB  
8810 TAB • 881 TAB VG

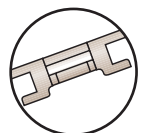

**For plastic chains, type:**  
878 TAB • 879 TAB  
880 TAB • 878 TAB VG  
879 TAB VG

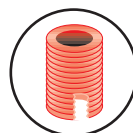

### Inserts:

The corner tracks can be supplied with M8 or M10 brass inserts to your detailed drawing



### Corner tracks Special Dimensions

On request corner tracks with special dimensions can be produced.



**For further information contact our Engineering Department.**

# CORNER TRACKS

## Tab Chains K325 Pitch 85 mm

Tracks	Total Width TL mm	Radius R1 = 500	Radius R1 = 610	Radius R1 = 650	Radius R1 = 800	Radius R1 = 1000
1	100	19017	19125	19131	19137	19143
2	185	19149	19154	19159	19164	19169
3	270	19150	19155	19160	19165	19170
4	355	19151	19156	19161	19166	19171
5	440	19152	19157	19162	19167	19172
6	525	19153	19158	19163	19168	19173

## Tab Chains K325 Pitch 88 mm

Tracks	Total Width TL mm	Radius R1 = 500	Radius R1 = 610	Radius R1 = 650	Radius R1 = 800	Radius R1 = 1000
1	100	19017	19125	19131	19137	19143
2	188	19120	19126	19132	19138	19144
3	276	19121	19127	19133	19139	19145
4	364	19122	19128	19134	19140	19146
5	452	19123	19129	19135	19141	19147
6	540	19124	19130	19136	19142	19148

## Tab Chains K325 - K350 Pitch 90 mm

Tracks	Total Width TL mm	Radius R1 = 500	Radius R1 = 610	Radius R1 = 650	Radius R1 = 800	Radius R1 = 1000
1	100	19017	19125	19131	19137	19143
2	190	19465	19470	19475	19480	19485
3	280	19466	19471	19476	19481	19486
4	370	19467	19472	19477	19482	19487
5	460	19468	19473	19478	19483	19488
6	550	19469	19474	19479	19484	19489

## Tab Chains K450 Pitch 120 mm

Tracks	Total Width TL mm	Radius R1 = 500	Radius R1 = 610	Radius R1 = 650	Radius R1 = 800	Radius R1 = 1000
1	130	-	19018	19175	19177	19179
2	250	-	19174	19176	19178	19180
3	370	-	19445	19449	19453	19457
4	490	-	19446	19450T	19454	19458
5	610	-	19447	19451T	19455	19459
6	730	-	19448	19452T	19456	19460T

## Tab Chains K750 Pitch 195 mm

Tracks	Total Width TL mm	Radius R1 = 500	Radius R1 = 610	Radius R1 = 650	Radius R1 = 800	Radius R1 = 1000
1	200	-	19181	19183	19185	19187
2	395	-	19182	19184	19186	19188
3	590	-	19490	19492	19494	19496
4	785	-	19491	19493	19495	19497

# CORNER TRACKS for chains series 879 - 880 - 881 - 8810

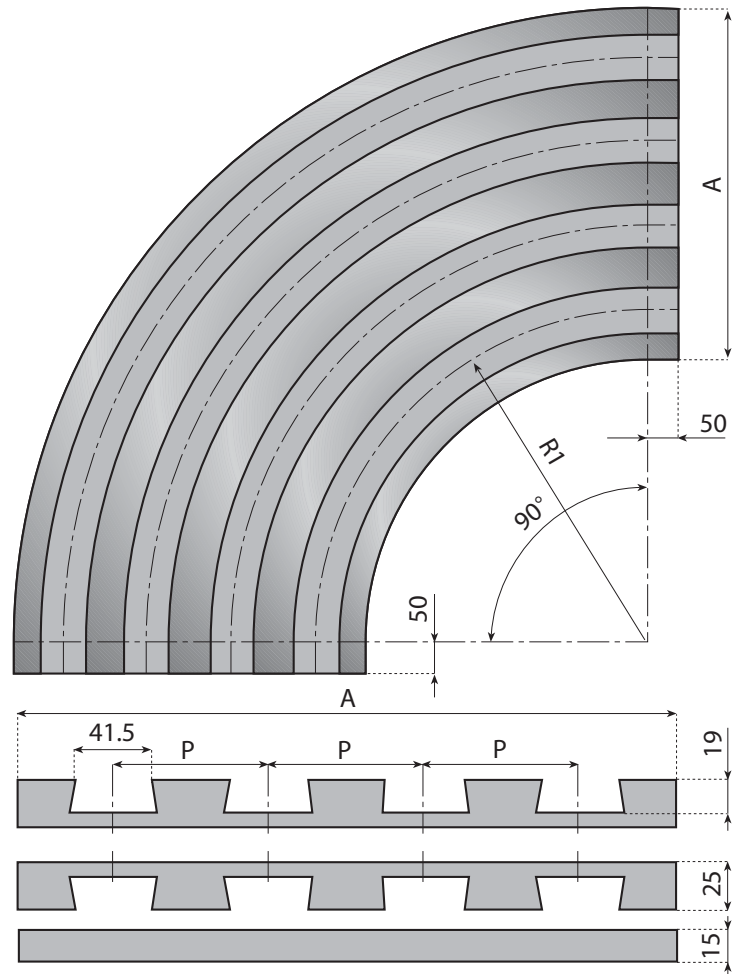

## CORNER TRACKS for chains series 879 - 880 - 881 - 8810

• More tracks available on request.

**Material:** Ultra High Molecular Weight Polyethylene to provide minimum friction and reliable long term performance.

**Note:** max. continuous service temperature in air 90°C.  
Water absorption coefficient = 0.

**Colour:** black.

**Supply:** corner tracks are supplied complete with carry and return plates.



For chains type  
see pages  
26 - 27  
42 - 54

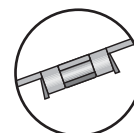

**For steel chains, type:**  
881 • 8810  
881 VG

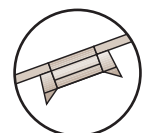

**For plastic chains, type:**  
879 • 880

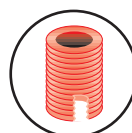

**Inserts:**  
The corner tracks can be supplied with M8 or M10 brass inserts to your detailed drawing



**Corner tracks  
Special Dimensions**  
On request corner tracks with special dimensions can be produced.



**For further  
information contact our  
Engineering  
Department.**

# CORNER TRACKS

## Chains K325 Pitch 85 mm

Tracks	Total Width TL mm	Radius R1 = 500	Radius R1 = 610	Radius R1 = 650	Radius R1 = 800	Radius R1 = 1000
1	100	19015	19279	19285	19291	19297
2	185	19303	19308	19313	19318	19323
3	270	19304	19309	19314	19319	19324
4	355	19305	19310	19315	19320	19325
5	440	19306	19311	19316	19321	19326
6	525	19307	19312	19317	19322	19327

## Chains K325 Pitch 88 mm

Tracks	Total Width TL mm	Radius R1 = 500	Radius R1 = 610	Radius R1 = 650	Radius R1 = 800	Radius R1 = 1000
1	100	19015	19279	19285	19291	19297
2	188	19274	19280	19286	19292	19298
3	276	19275	19281	19287	19293	19299
4	364	19276	19282	19288	19294	19300
5	452	19277	19283	19289	19295	19301
6	540	19278	19284	19290	19296	19302

## Chains K325 - K350 Pitch 90 mm

Tracks	Total Width TL mm	Radius R1 = 500	Radius R1 = 610	Radius R1 = 650	Radius R1 = 800	Radius R1 = 1000
1	100	19015	19279	19285	19291	19297
2	190	19914	19919	19924	19929	19934
3	280	19915	19920	19925	19930	19935
4	370	19916	19921	19926	19931	19936
5	460	19917	19922	19927	19932	19937
6	550	19918	19923	19928	19933	19938

## Chains K450 Pitch 120 mm

Tracks	Total Width TL mm	Radius R1 = 500	Radius R1 = 610	Radius R1 = 650	Radius R1 = 800	Radius R1 = 1000
1	130	-	19016	19330	19332	19334
2	250	-	19329	19331	19333	19335
3	370	-	19896	19897	19898	19899
4	490	-	19901	19904	19907	19910
5	610	-	19902	19905	19908	19911
6	730	-	19903	19906	19909	19912

## Chains K750 Pitch 195 mm

Tracks	Total Width TL mm	Radius R1 = 500	Radius R1 = 610	Radius R1 = 650	Radius R1 = 800	Radius R1 = 1000
1	200	-	19336	19338	19340	19342
2	395	-	19337	19339	19341	19343
3	590	-	19939	19941	19943	19945
4	785	-	19940	19942	19944	19946

# CORNER TRACKS for chains series

## 882 TAB - LBP 882 TAB - 882 TAB VG

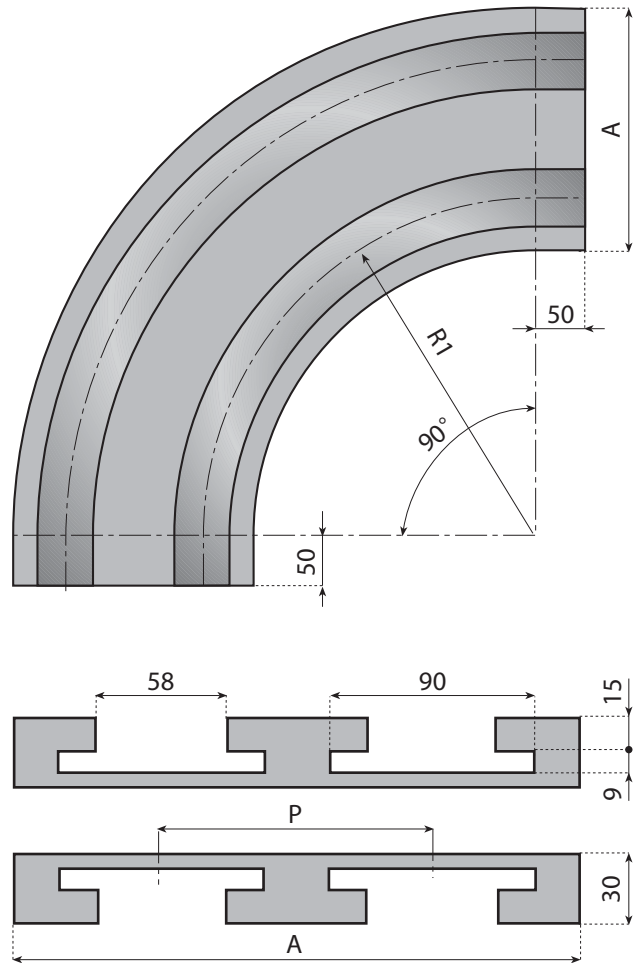

### CORNER TRACKS for chains series 882 TAB - LBP 882 TAB - 882 TAB VG

• More tracks available on request.

**Material:** Ultra High Molecular Weight Polyethylene to provide minimum friction and reliable long term performance.

**Note:** max. continuous service temperature in air 90°C.  
Water absorption coefficient = 0.

**Colour:** black.

**Supply:** corner tracks are supplied complete with carry and return plates.



**For further information contact our**  
Engineering  
Department.

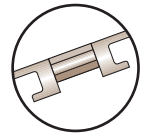

**For plastic chains type:**  
882 TAB • 882 TAB VG  
LBP 882 TAB

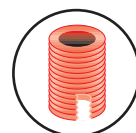

**Inserts:**  
The corner tracks can be supplied with M8 or M10 brass inserts to your detailed drawing



**Corner tracks Special Dimensions**  
On request corner tracks with special dimensions can be produced.



For chains type see pages 59 - 68 → 71 - 83

# CORNER TRACKS

## Tab Chains K450 Pitch 120 mm

Tracks	Total Width TL mm	Radius R1 = 610	Radius R1 = 650	Radius R1 = 800	Radius R1 = 1000
1	130	19102	19190	19192	19194
2	250	19189	19191	19193	19195
3	370	19950	19954	19958	19962
4	490	19951	19955	19959	19963
5	610	19952	19956	19960	19964
6	730	19953	19957	19961	19965

## Tab Chains K750 Pitch 195 mm

Tracks	Total Width TL mm	Radius R1 = 610	Radius R1 = 650	Radius R1 = 800	Radius R1 = 1000
1	200	19103	19197	19199	19201
2	395	19196	19198	19200	19202
3	590	19966	19968	19970	19972
4	785	19967	19969	19971	19973

## Tab Chains K1000 Pitch 260 mm

Tracks	Total Width TL mm	Radius R1 = 610	Radius R1 = 650	Radius R1 = 800	Radius R1 = 1000
1	270	19104	19204	19206	19208
2	530	19203	19205	19207	19209
3	790	19974	19976	19978	19980
4	1050	19975	19977	19979	19981

## Tab Chains K1200 Pitch 310 mm

Tracks	Total Width TL mm	Radius R1 = 610	Radius R1 = 650	Radius R1 = 800	Radius R1 = 1000
1	320	19105	19211	19213	19215
2	630	19210	19212	19214	19216
3	940	19982	19984	19986	19988
4	1250	19983	19985	19987	19989

# CORNER TRACKS for chains series 882 BEVEL

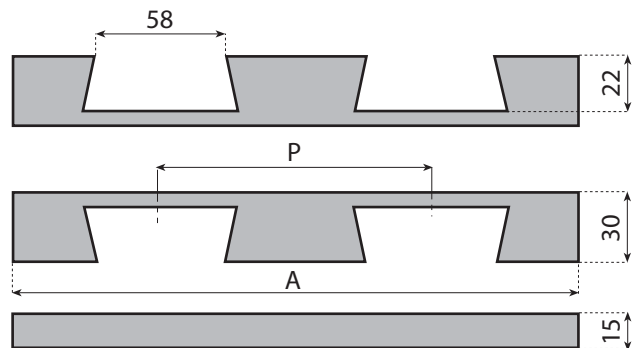
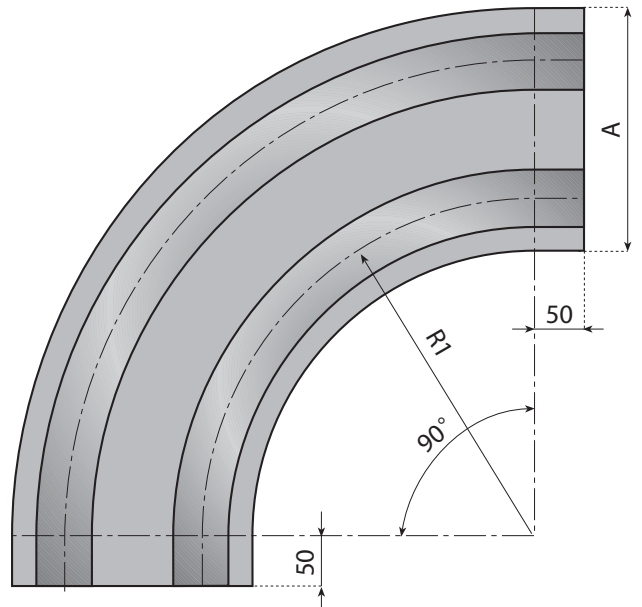

## CORNER TRACKS for chains series 882 BEVEL

• More tracks available on request.

**Material:** Ultra High Molecular Weight Polyethylene to provide minimum friction and reliable long term performance.

**Note:** max. continuous service temperature in air 90°C.  
Water absorption coefficient = 0.

**Colour:** black.

**Supply:** corner tracks are supplied complete with carry and return plates.

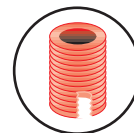

### Inserts:

The corner tracks can be supplied with M8 or M10 brass inserts to your detailed drawing

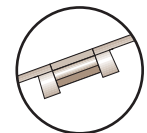

**For plastic chains, type:**  
882 BEVEL



### Corner tracks Special Dimensions

On request corner tracks with special dimensions can be produced.



**For further information contact our**  
Engineering Department.



For chains type see pages 58



# CORNER TRACKS

## Bevel Chains K450 Pitch 120 mm

Tracks	Total Width TL mm	Radius R1 = 610	Radius R1 = 650	Radius R1 = 800	Radius R1 = 1000
1	130	190001	190007	190013	190019
2	250	190002	190008	190014	190020
3	370	190003	190009	190015	190021
4	490	190004	190010	190016	190022
5	610	190005	190011	190017	190023
6	730	190006	190012	190018	190024

## Bevel Chains K750 Pitch 195 mm

Tracks	Total Width TL mm	Radius R1 = 610	Radius R1 = 650	Radius R1 = 800	Radius R1 = 1000
1	200	190025	190029	190033	190037
2	395	190026	190030	190034	190038
3	590	190027	190031	190035	190039
4	785	190028	190032	190036	190040

## Bevel Chains K1000 Pitch 260 mm

Tracks	Total Width TL mm	Radius R1 = 610	Radius R1 = 650	Radius R1 = 800	Radius R1 = 1000
1	270	190041	190045	190049	190053
2	530	190042	190046	190050	190054
3	790	190043	190047	190051	190055
4	1050	190044	190048	190052	190056

# CORNER TRACKS for chains series 1863 - 1873 - 1874

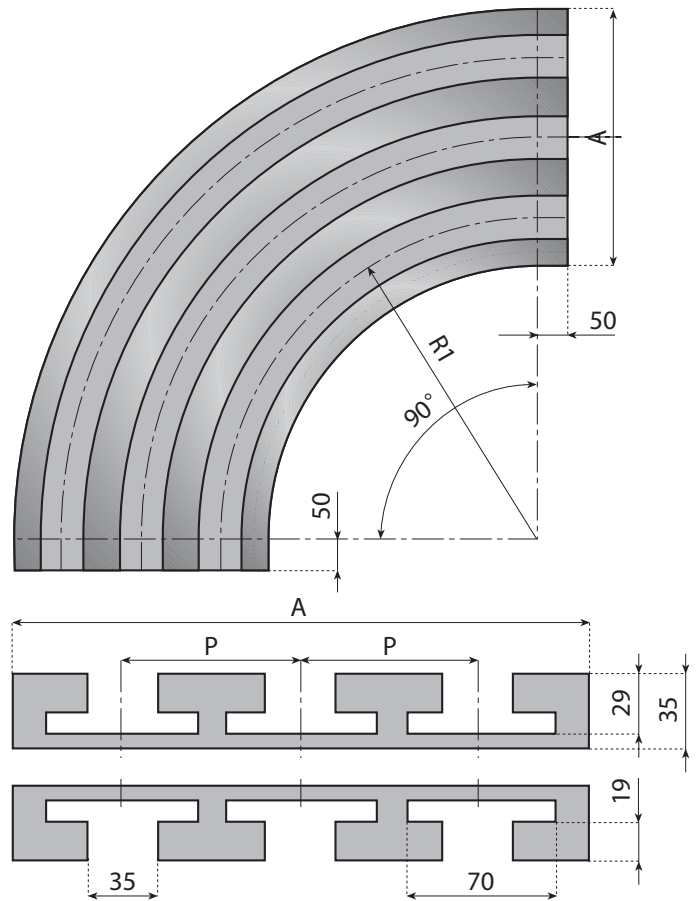

## CORNER TRACKS for chains series 1863 - 1873 - 1874

• More tracks available on request.

**Material:** Ultra High Molecular Weight Polyethylene to provide minimum friction and reliable long term performance.

**Note:** max. continuous service temperature in air 90°C.  
Water absorption coefficient = 0.

**Colour:** black.

**Supply:** corner tracks are supplied complete with carry and return plates.



For chains type  
see pages  
33 - 85  
88 → 100

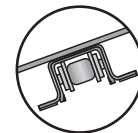

**For steel  
chains, type:**  
1874 • 1874 GS

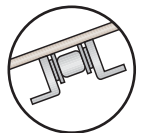

**For plastic  
chains, type:**  
1863 • 1873  
1873 VG • 1873 GS

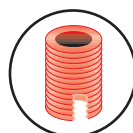

**Inserts:**  
The corner tracks can be  
supplied with M8 or M10 brass  
inserts to your detailed drawing



**Corner tracks  
Special Dimensions**  
On request corner tracks with  
special dimensions can be produced.



**For further  
information contact our  
Engineering  
Department.**

### Chains K225 Pitch 70 mm

Tracks	Total Width TL mm	Radius R1 = 380	Radius R1 = 500	Radius R1 = 610	Radius R1 = 800	Radius R1 = 1000
1	75	190060	190064	190068	190072	190076
2	145	190061	190065	190069	190073	190077
3	215	190062	190066	190070	190074	190078
4	285	190063	190067	190071	190075	190079

### Chains K325 Pitch 85 mm

Tracks	Total Width TL mm	Radius R1 = 380	Radius R1 = 500	Radius R1 = 610	Radius R1 = 800	Radius R1 = 1000
1	100	190080	19217	19221	19225	19229
2	185	190081	19218	19222	19226	19230
3	270	190082	19219	19223	19227	19231
4	355	190083	19220	19224	19228	19232

### Chains K325 Pitch 90 mm

Tracks	Total Width TL mm	Radius R1 = 500	Radius R1 = 610	Radius R1 = 650	Radius R1 = 800	Radius R1 = 1000
1	100	19217	19221	190092	19225	19229
2	190	190085	190089	190093	190097	190101
3	280	190086	190090	190094	190098	190102
4	370	190087	190091	190095	190099	190103

### Chains K450 Pitch 120 mm

Tracks	Total Width TL mm	Radius R1 = 380	Radius R1 = 500	Radius R1 = 610	Radius R1 = 800	Radius R1 = 1000
1	130	190104	19233	19235	19237	19239
2	250	190105	19234	19236	19238	19240
3	370	190106	190108	190110	190112	190114
4	490	190107	190109	190111	190113	190115

### Chains K600 Pitch 160 mm

Tracks	Total Width TL mm	Radius R1 = 500	Radius R1 = 610	Radius R1 = 650	Radius R1 = 800	Radius R1 = 1000
1	170	19241	19243	190116	19245	19247
2	330	19242	19244	190117	19246	19248
3	490	190118	190120	190122	190124	190126
4	650	190119	190121	190123	190125	190127

### Chains K750 Pitch 195 mm

Tracks	Total Width TL mm	Radius R1 = 500	Radius R1 = 610	Radius R1 = 650	Radius R1 = 800	Radius R1 = 1000
1	200	19249	19251	190128	19253	19255
2	395	19250	19252	190129	19254	19256
3	590	190130	190132	190134	190136	190138
4	785	190131	190133	190135	190137	190139

### Chains K1000 Pitch 260 mm

Tracks	Total Width TL mm	Radius R1 = 500	Radius R1 = 610	Radius R1 = 650	Radius R1 = 800	Radius R1 = 1000
1	270	19257	19259	190140	19261	19263
2	530	19258	19260	190141	19262	19264

### Chains K1200 Pitch 310 mm

Tracks	Total Width TL mm	Radius R1 = 610	Radius R1 = 650	Radius R1 = 750	Radius R1 = 800	Radius R1 = 1000
1	320	19267	19265	190142	19269	19271
2	630	19268	19266	190143	19270	19272

# COMPACT CORNER TRACKS for chains series

## 878 TAB - 879 TAB - 880 TAB - 881 TAB - 881 R TAB - 881O TAB

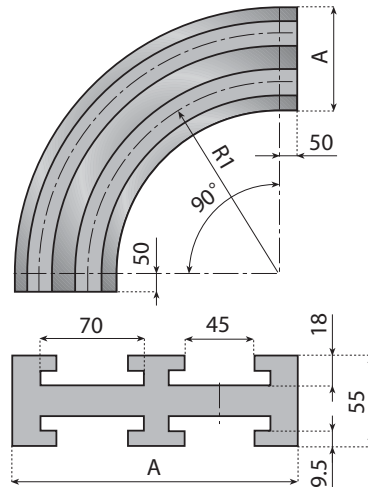

For chains type see pages 28 - 29 55 - 56 80 - 81

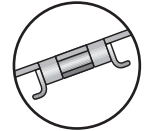

**For steel chains, type:** 881 R TAB • 881 TAB 881O TAB • 881 TAB VG



**For further information contact our Engineering Department.**

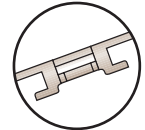

**For plastic chains, type:** 878 TAB • 879 TAB • 880 TAB 878 TAB VG • 879 TAB VG

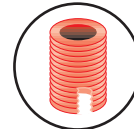

**Inserts:**

The corner tracks can be supplied with M8 or M10 brass inserts to your detailed drawing



**Corner tracks Special Dimensions**

On request corner tracks with special dimensions can be produced.

**Material:** Ultra High Molecular Weight Polyethylene to provide minimum friction and reliable long term performance.

**Note:** max. continuous service temperature in air 90°C. Water absorption coefficient = 0.

**Colour:** black.

**Supply:** 1 piece.

FOR CHAINS WIDTH	CODE	A	R1	Pitch
K325	19106	100	500	90
	19107	190		
K450	19108	130	610	120
	19109	250		

# COMPACT CORNER TRACKS for chains series

## 879 - 880 - 881 - 881O

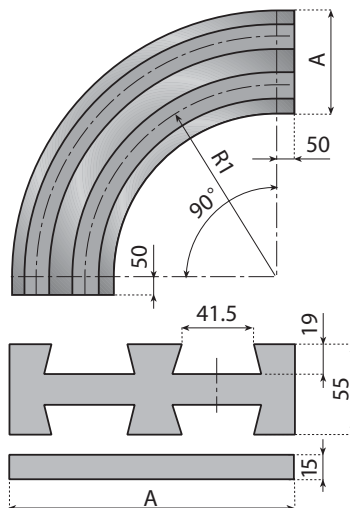

For chains type see pages 26 - 27 42 - 54

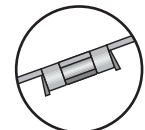

**For steel chains, type:** 881 • 881O • 881 VG



**For further information contact our Engineering Department.**

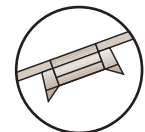

**For plastic chains, type:** 879 • 880

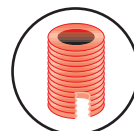

**Inserts:**

The corner tracks can be supplied with M8 or M10 brass inserts to your detailed drawing



**Corner tracks Special Dimensions**

On request corner tracks with special dimensions can be produced.

**Material:** Ultra High Molecular Weight Polyethylene to provide minimum friction and reliable long term performance.

**Note:** max. continuous service temperature in air 90°C. Water absorption coefficient = 0.

**Colour:** black.

**Supply:** 2 pieces.

FOR CHAINS WIDTH	CODE	A	R1	Pitch
K325	19106B	100	500	90
	19107B	190		
K450	19108B	130	610	120
	19109B	250		

## CORNER TRACKS for chains series 1843

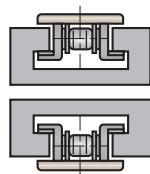
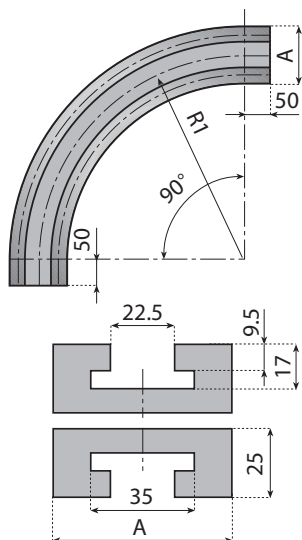

For further information contact our Engineering Department.

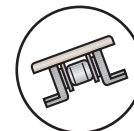

For plastic chains, type: 1843

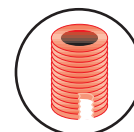

**Inserts:**

The corner tracks can be supplied with M8 or M10 brass inserts to your detailed drawing



**Corner tracks Special Dimensions**

On request corner tracks with special dimensions can be produced.



For chains type see page 100

**Material:** Ultra High Molecular Weight Polyethylene to provide minimum friction and reliable long term performance.

**Note:** max. continuous service temperature in air 90°C. Water absorption coefficient = 0.

**Colour:** black.

**Supply:** corner tracks are supplied complete with carry and return plates.

FOR CHAINS WIDTH	CODE	A	R1
K125	19396	50	300
	19397		500
K200	19396L	70	300
	19397L		500

## CORNER TRACKS for chains series LBP 882 K375

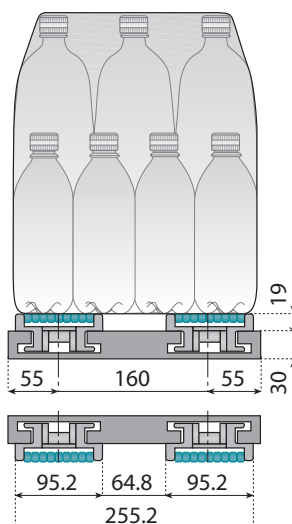
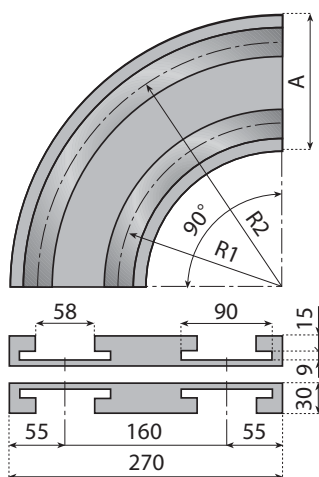

For further information contact our Engineering Department.

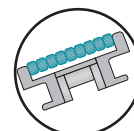

For plastic chains, type: LBP 882 K375

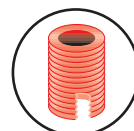

**Inserts:**

The corner tracks can be supplied with M8 or M10 brass inserts to your detailed drawing



**Corner tracks Special Dimensions**

On request corner tracks with special dimensions can be produced.



For chains type see pages 68 - 69

**Material:** Ultra High Molecular Weight Polyethylene to provide minimum friction and reliable long term performance.

**Note:** max. continuous service temperature in air 90°C. Water absorption coefficient = 0.

**Colour:** black.

**Supply:** corner tracks are supplied complete with carry and return plates.

FOR CHAINS WIDTH	CODE	A	TRACKS	R1	R2
K375	19101	270	2	700	860

# CORNER TRACKS for chains series 1883

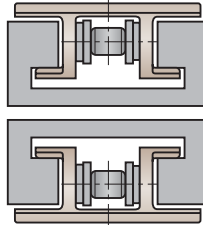
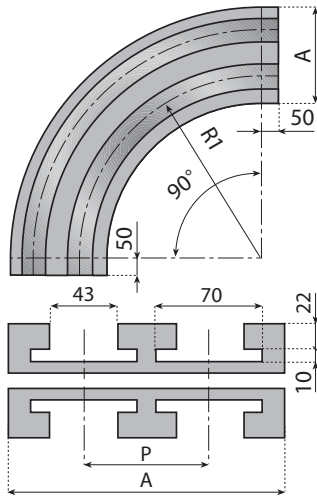

For further information contact our Engineering Department.

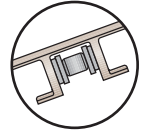

For plastic chains, type: 1883

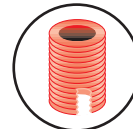

Inserts:

The corner tracks can be supplied with M8 or M10 brass inserts to your detailed drawing



Corner tracks Special Dimensions

On request corner tracks with special dimensions can be produced.



For chains type see page 104

**Material:** Ultra High Molecular Weight Polyethylene to provide minimum friction and reliable long term performance.

**Note:** max. continuous service temperature in air 90°C. Water absorption coefficient = 0.

**Colour:** black.

**Supply:** corner tracks are supplied complete with carry and return plates.

FOR CHAINS WIDTH	CODE	A	R1	Pitch
K325	19110	100	750	90
	19111	190		

# CORNER TRACKS for chains series HMGK 50 TAB M1 - HMGK 50 TAB M2 - HMGK 50 TAB M3

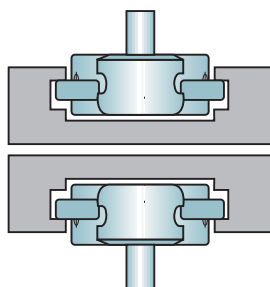
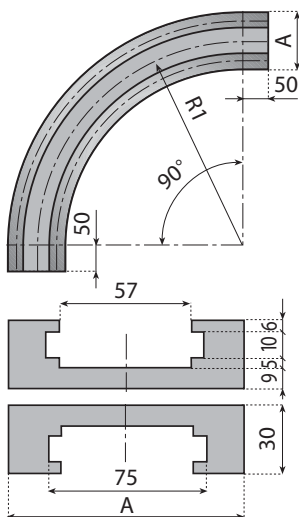

For further information contact our Engineering Department.

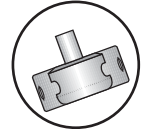

For plastic chains, type: HMGK 50 TAB M1 HMGK 50 TAB M2 HMGK 50 TAB M3

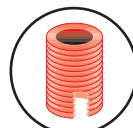

Inserts:

The corner tracks can be supplied with M8 or M10 brass inserts to your detailed drawing



Corner tracks Special Dimensions

On request corner tracks with special dimensions can be produced.



For chains type see page 111

**Material:** Ultra High Molecular Weight Polyethylene to provide minimum friction and reliable long term performance.

**Note:** max. continuous service temperature in air 90°C. Water absorption coefficient = 0.

**Colour:** black.

**Supply:** corner tracks are supplied complete with carry and return plates.

FOR CHAINS WIDTH	CODE	A	R1
HMGK 50 TAB M1 HMGK 50 TAB M2 HMGK 50 TAB M3	19112	100	250

## CORNER TRACKS for cardanic chains series

1701 TAB - 1701 TAB OP - 7000 TAB - 7001 TAB - 7005 TAB

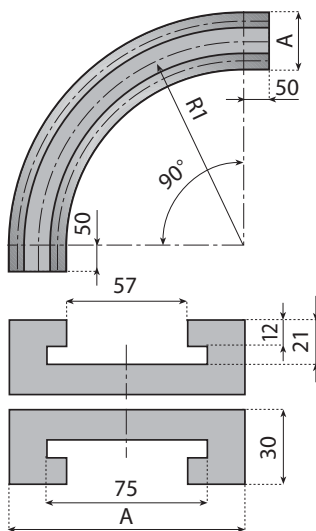

For further information contact our Engineering Department.

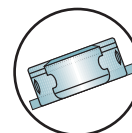

For plastic chains, type: 1701 TAB - 1701 TAB OP 7000 TAB - 7001 TAB 7005 TAB

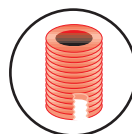

**Inserts:**

The corner tracks can be supplied with M8 or M10 brass inserts to your detailed drawing



**Corner tracks Special Dimensions**

On request corner tracks with special dimensions can be produced.



For chains type see pages 109 → 116

FOR CHAINS WIDTH	CODE	A	R1
K55	19390	100	250
	19391		500

**Material:** Ultra High Molecular Weight Polyethylene to provide minimum friction and reliable long term performance.

**Note:** max. continuous service temperature in air 90°C. Water absorption coefficient = 0.

**Colour:** black.

**Supply:** corner tracks are supplied complete with carry and return plates.

## CORNER TRACKS for cardanic chains series

1700 - 1702 (M) - HMGK (FN-MS-P-M) 7000 - 7001 - 7005

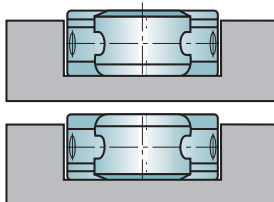
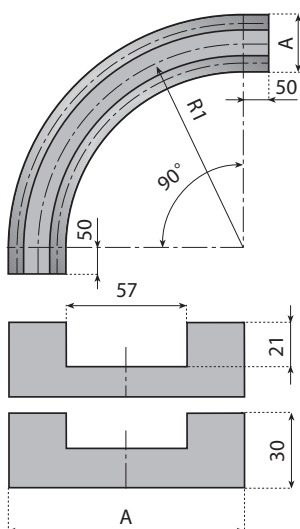

For further information contact our Engineering Department.

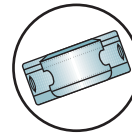

For plastic chains, type: 1700 - 1702(M) HMGK (FN-MS-P-M) 7000 - 7001 - 7005

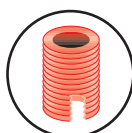

**Inserts:**

The corner tracks can be supplied with M8 or M10 brass inserts to your detailed drawing



**Corner tracks Special Dimensions**

On request corner tracks with special dimensions can be produced.



For chains type see pages 106 → 116

FOR CHAINS WIDTH	CODE	A	R1
K55	19113	100	250
	19114		500

**Material:** Ultra High Molecular Weight Polyethylene to provide minimum friction and reliable long term performance.

**Note:** max. continuous service temperature in air 90°C. Water absorption coefficient = 0.

**Colour:** black.

**Supply:** corner tracks are supplied complete with carry and return plates.

## CORNER TRACKS for chains series HMGK 50 TAB H1 - HMGK 50 TAB H2

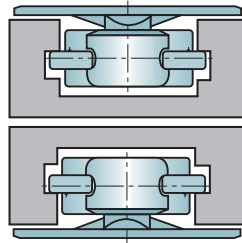
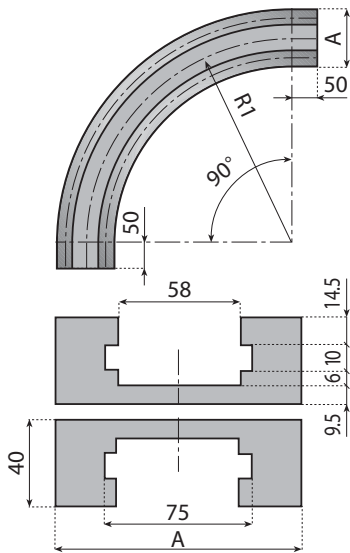

**For further information contact our Engineering Department.**

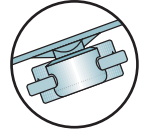

**For plastic chains, type: HMGK 50 TAB H1 HMGK 50 TAB H2**

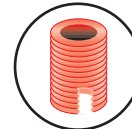

**Inserts:**

The corner tracks can be supplied with M8 or M10 brass inserts to your detailed drawing



**Corner tracks**

**Special Dimensions**

On request corner tracks with special dimensions can be produced.



For chains type see page 113

**Material:** Ultra High Molecular Weight Polyethylene to provide minimum friction and reliable long term performance.

**Note:** max. continuous service temperature in air 90°C. Water absorption coefficient = 0.

**Colour:** black.

**Supply:** corner tracks are supplied complete with carry and return plates.

FOR CHAINS WIDTH	CODE	A	R1
HMGK 50 TAB H1	19115	110	250
HMGK 50 TAB H2	19116	200	500

## CORNER TRACKS for chains series HMGK 50 TAB P1 - HMGK 50 TAB P2

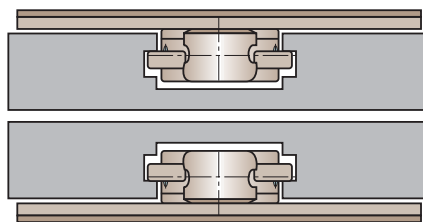
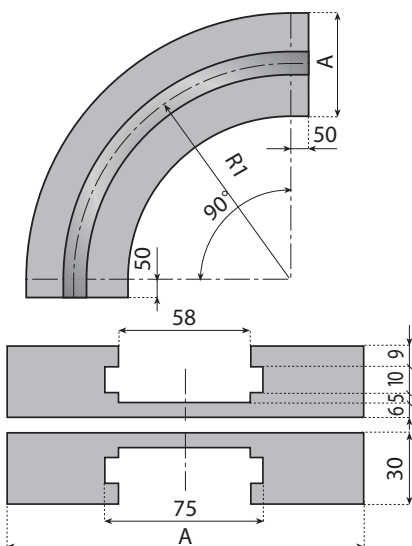

**For further information contact our Engineering Department.**

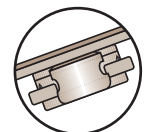

**For plastic chains, type: HMGK 50 TAB P1 HMGK 50 TAB P2**

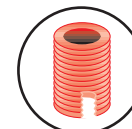

**Inserts:**

The corner tracks can be supplied with M8 or M10 brass inserts to your detailed drawing



**Corner tracks**

**Special Dimensions**

On request corner tracks with special dimensions can be produced.



For chains type see page 112

**Material:** Ultra High Molecular Weight Polyethylene to provide minimum friction and reliable long term performance.

**Note:** max. continuous service temperature in air 90°C. Water absorption coefficient = 0.

**Colour:** black.

**Supply:** corner tracks are supplied complete with carry and return plates.

FOR CHAINS WIDTH	CODE	A	R1
HMGK 50 TAB P1	19117	200	550
HMGK 50 TAB P2	19118	270	





# STRAIGHT TRACK SECTION for chains series

878 TAB - 879 TAB - 880 TAB - 881 R TAB - 881 TAB - 881O TAB

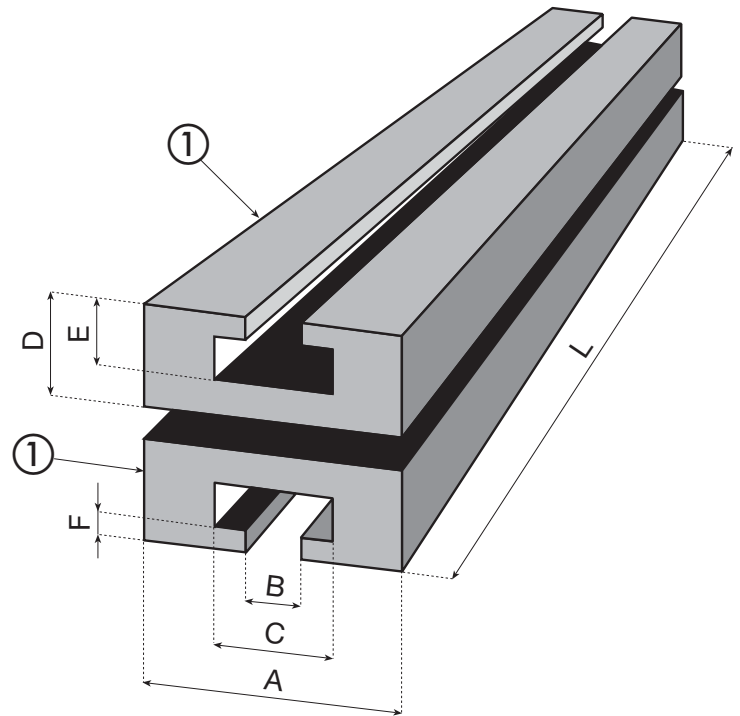

## STRAIGHT TRACK SECTION for chains series

**878 TAB - 879 TAB - 880 TAB**  
**881 R TAB - 881 TAB - 881O TAB**

• More tracks available on request.

**Material:** Ultra High Molecular Weight Polyethylene to provide minimum friction and reliable long term performance.

**Note:** max. continuous service temperature in air 90°C.  
Water absorption coefficient = 0.

**Colour:** black.

**Supply:** 1 piece.

 For chains type  
see pages  
28 → 29  
55 - 56  
80 - 81

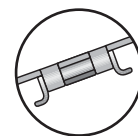

**For steel chains, type:**  
881 R TAB • 881 TAB  
881O TAB • 881 TAB VG

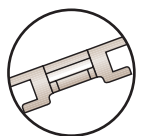

**For plastic chains, type:**  
878 TAB • 879 TAB  
880 TAB • 878 TAB VG  
879 TAB VG

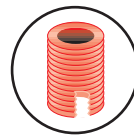

**Inserts:**  
The straight tracks section can be supplied with M8 or M10 brass inserts to your detailed drawing



**Straight tracks section  
Special Dimensions**  
On request straight tracks section with special dimensions can be produced.



**For further  
information contact our  
Engineering  
Department.**

① STRAIGHT TRACK SECTION - 1 PIECE								
FOR CHAIN WIDTH	CODE	A	B	C	D	E	F	L
K325	<b>19350</b>	100						
K450	<b>19351</b>	130	45	67	25	18	9.5	2000
K750	<b>19352</b>	200						

# STRAIGHT TRACK SECTION for chains series 879 - 880 - 881 - 8810

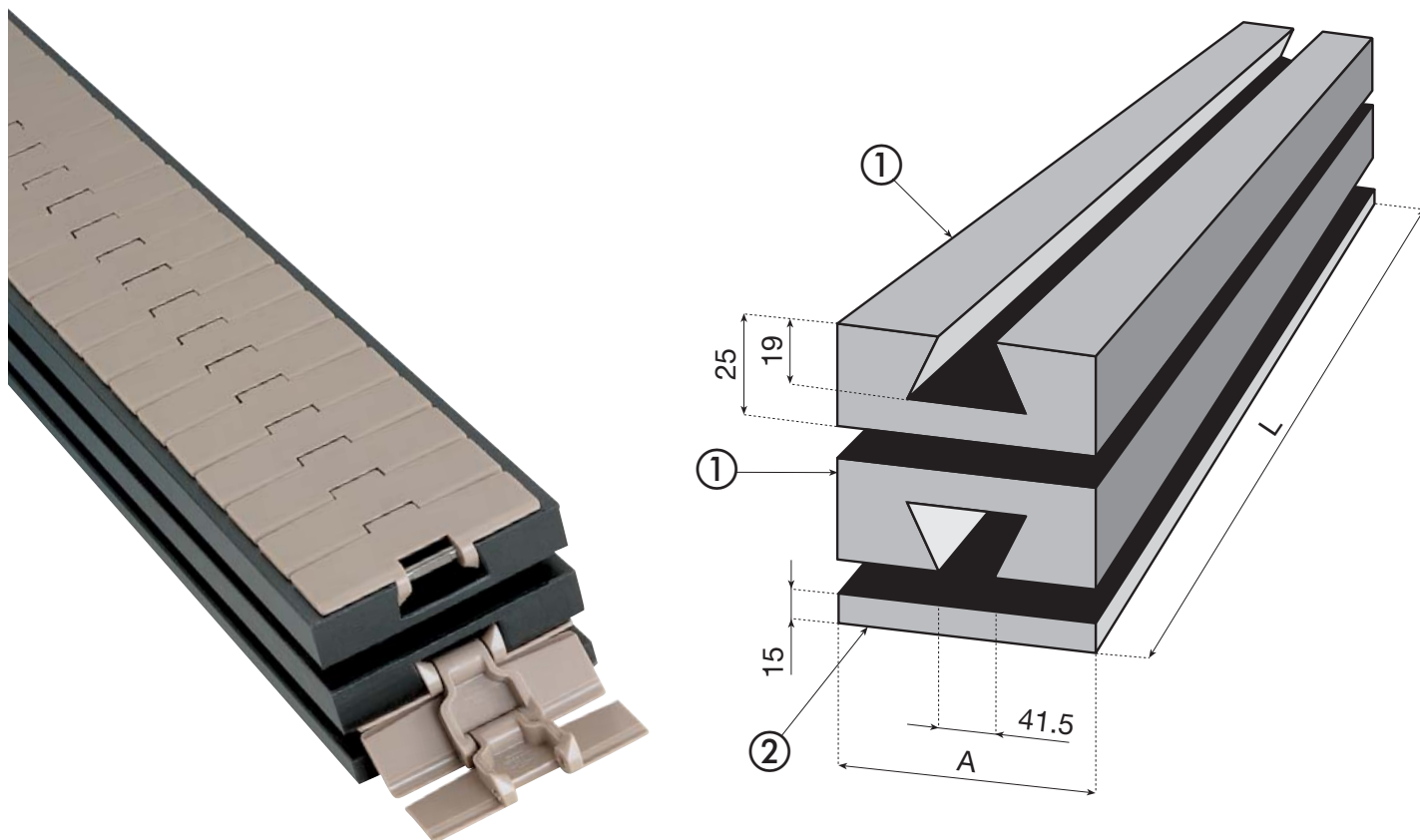

## STRAIGHT TRACK SECTION for chains series 879 - 880 - 881 - 8810



For chains type  
see pages  
26 - 27  
42 - 54

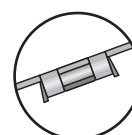

**For steel chains, type:**  
881 • 8810  
881 VG

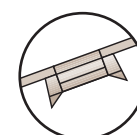

**For plastic chains, type:**  
879 • 880

• More tracks available on request.

**Material:** Ultra High Molecular Weight Polyethylene to provide minimum friction and reliable long term performance.

**Note:** max. continuous service temperature in air 90°C.  
Water absorption coefficient = 0.

**Colour:** black.

**Supply:** 1 piece; carry return sections and return plates are supplied separately.

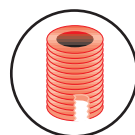

**Inserts:**

The straight tracks section can be supplied with M8 or M10 brass inserts to your detailed drawing



**Straight tracks section  
Special Dimensions**

On request straight tracks section with special dimensions can be produced.



**For further information contact our Engineering Department.**

① CARRY/RETURN TRACK SECTION - 1 PIECE			
FOR CHAIN WIDTH	CODE	A	L
K325	19370	100	
K450	19372	130	2000
K750	19374	200	

② RETURN PLATE - 1 PIECE			
FOR CHAIN WIDTH	CODE	A	L
K325	19371	100	
K450	19373	130	2000
K750	19375	200	

# STRAIGHT TRACK SECTION for chains series 882 TAB - LBP 882 TAB - 882 TAB VG

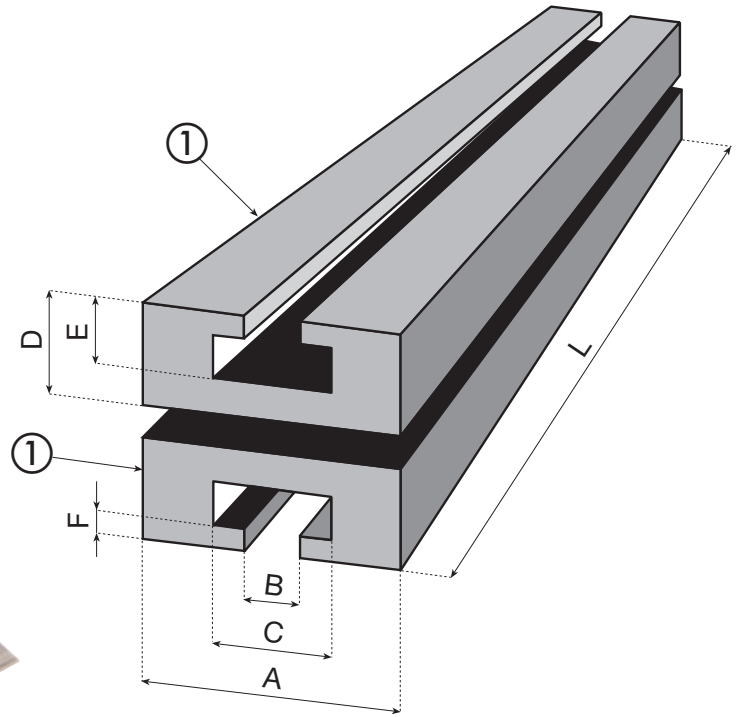

## STRAIGHT TRACK SECTION for chains series 882 TAB - LBP 882 TAB - 882 TAB VG

• More tracks available on request.

**Material:** Ultra High Molecular Weight Polyethylene to provide minimum friction and reliable long term performance.

**Note:** max. continuous service temperature in air 90°C.  
Water absorption coefficient = 0.

**Colour:** black.

**Supply:** 1 piece.



For chains type  
see pages  
59 - 68 → 71 - 83

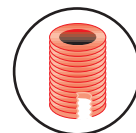

### Inserts:

The straight tracks section can be supplied with M8 or M10 brass inserts to your detailed drawing

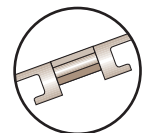

### For plastic chains, type:

882 TAB • LBP 882 TAB  
882 TAB VG



### Straight tracks section Special Dimensions

On request straight tracks section with special dimensions can be produced.



### For further information contact our

Engineering Department.

① STRAIGHT TRACK SECTION - 1 PIECE								
FOR CHAIN WIDTH	CODE	A	B	C	D	E	F	L
K375	19359	110						
K450	19360	130						
K750	19361	200	60	84	30	24	15	2000
K1000	19362	270						
K1200	19363	320						

# STRAIGHT TRACK SECTION for chains series 882 BEVEL

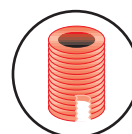
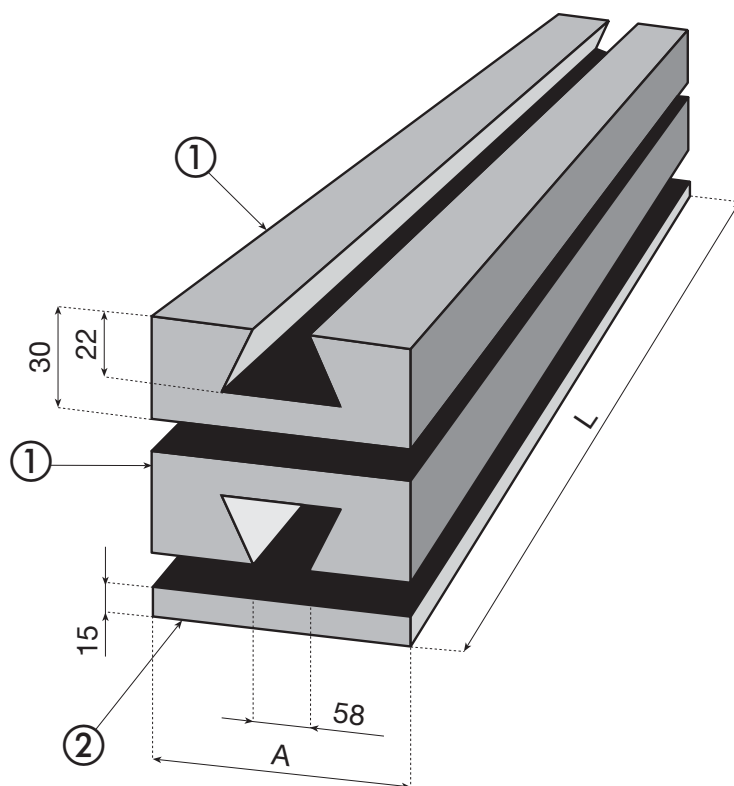

**Inserts:**

The straight tracks section can be supplied with M8 or M10 brass inserts to your detailed drawing

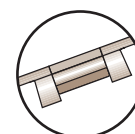

**For plastic chains, type:**  
882 BEVEL



**Straight tracks section  
Special Dimensions**

On request straight tracks section with special dimensions can be produced.



**For further information contact our Engineering Department.**

## STRAIGHT TRACK SECTION for chains series 882 BEVEL

• More tracks available on request.

**Material:** Ultra High Molecular Weight Polyethylene to provide minimum friction and reliable long term performance.



For chains type see page 58

**Note:** max. continuous service temperature in air 90°C.  
Water absorption coefficient = 0.

**Colour:** black.

**Supply:** 1 piece; carry return sections and return plates are supplied separately.

① CARRY/RETURN TRACK SECTION - 1 PIECE			
FOR CHAIN WIDTH	CODE	A	L
K450	19353	130	
K750	19354	200	2000
K1000	19355	270	

② RETURN PLATE - 1 PIECE			
FOR CHAIN WIDTH	CODE	A	L
K450	19373	130	
K750	19375	200	2000
K1000	19358	270	

# STRAIGHT TRACK SECTION for chains series 1863 - 1873 - 1874

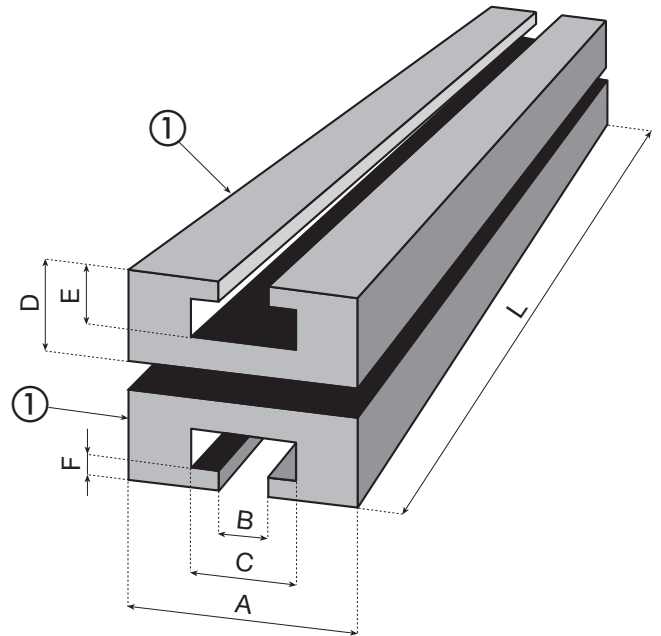

For chains type  
see pages  
33 - 85 - 88  
92 - 93  
101 - 103

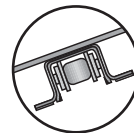

For steel  
chains, type:  
1874 • 1874 GS

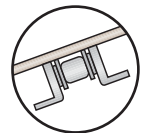

For plastic  
chains, type:  
1863 • 1873  
1873 VG • 1873 GS

## STRAIGHT TRACK SECTION for chains series 1863 - 1873 - 1874

- More tracks available on request.

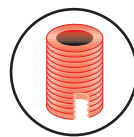

**Inserts:**  
The straight tracks section can be supplied with M8 or M10 brass inserts to your detailed drawing



**Straight tracks section  
Special Dimensions**  
On request straight tracks section with special dimensions can be produced.



**For further  
information contact our  
Engineering  
Department.**

**Material:** Ultra High Molecular Weight Polyethylene to provide minimum friction and reliable long term performance.

**Note:** max. continuous service temperature in air 90°C.  
Water absorption coefficient = 0.

**Colour:** black.

**Supply:** 1 piece.

① STRAIGHT TRACK SECTION - 1 PIECE								
FOR CHAIN WIDTH	CODE	A	B	C	D	E	F	L
K225	<b>19406</b>	75		67				
K325	<b>19400</b>	100						
K450	<b>19401</b>	130						
K600	<b>19402</b>	170	35	70	35	29	19	2000
K750	<b>19403</b>	200						
K1000	<b>19404</b>	270						
K1200	<b>19405</b>	320						

# COMPACT STRAIGHT TRACK SECTION for chains series 878 TAB - 879 TAB - 880 TAB - 881 R TAB - 881 TAB - 881O TAB

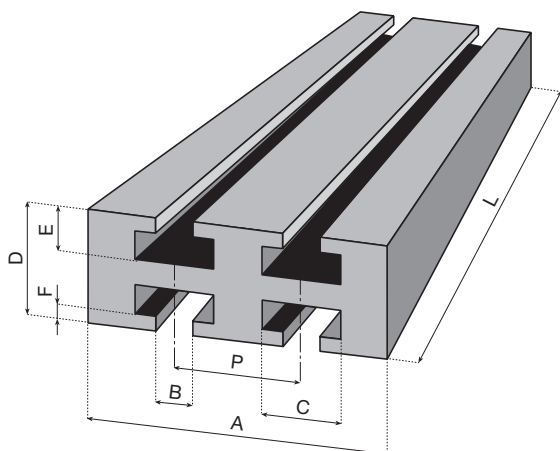

For chains type see pages 28 → 29  
55 - 56  
80 - 81

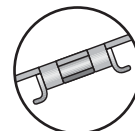

**For steel chains, type:**  
881 R TAB • 881 TAB  
881O TAB • 881 TAB VG

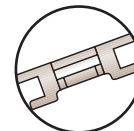

**For plastic chains, type:**  
878 TAB • 879 TAB  
880 TAB • 878 TAB VG  
879 TAB VG

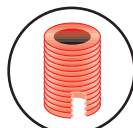

**Inserts:**  
The straight tracks section can be supplied with M8 or M10 brass inserts to your detailed drawing



**Straight tracks section Special Dimensions**  
On request straight tracks section with special dimensions can be produced.



**For further information contact our Engineering Department.**

**Material:** Ultra High Molecular Weight Polyethylene to provide minimum friction and reliable long term performance.

**Note:** max. continuous service temperature in air 90°C. Water absorption coefficient = 0.

**Colour:** black.

**Supply:** 1 piece.

FOR CHAIN WIDTH	CODE	A	B	C	D	E	F	P	L
K325	19424	100	45	67	55	18	9.5	90	2000
	19425	190						120	
K450	19426	130	45	67	55	18	9.5	90	2000
	19427	250						120	

# COMPACT STRAIGHT TRACK SECTION for chains series 879 - 880 - 881 - 881O

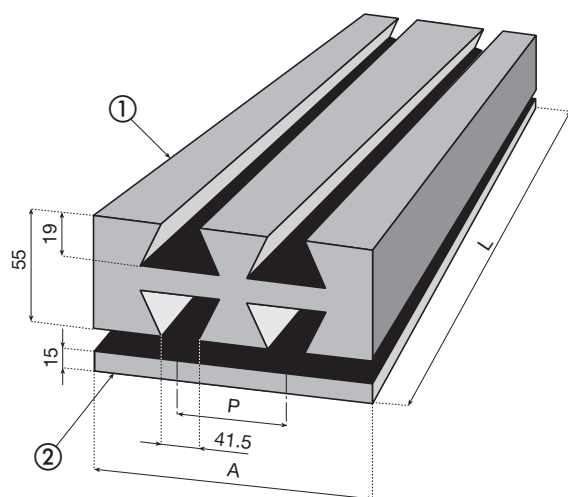

For chains type see pages 26 - 27  
42 - 54

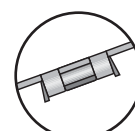

**For steel chains, type:**  
881 • 881O  
881 VG

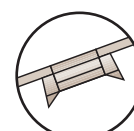

**For plastic chains, type:**  
879 • 880

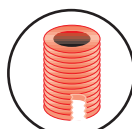

**Inserts:**  
The straight tracks section can be supplied with M8 or M10 brass inserts to your detailed drawing



**Straight tracks section Special Dimensions**  
On request straight tracks section with special dimensions can be produced.



**For further information contact our Engineering Department.**

**Material:** Ultra High Molecular Weight Polyethylene to provide minimum friction and reliable long term performance.

**Note:** max. continuous service temperature in air 90°C. Water absorption coefficient = 0.

**Colour:** black.

**Supply:** 1 piece; carry return sections and return plates are supplied separately.

① CARRY RETURN - 1 PIECE					② RETURN PLATE 1 PIECE				
FOR CHAIN WIDTH	CODE	A	P	L	FOR CHAIN WIDTH	CODE	A	P	L
K325	19428	100	90	2000	K325	19371	100	90	2000
	19429	190				19433	190		
K450	19430	130	120	2000	K450	19373	130	120	2000
	19431	250				19435	250		

# STRAIGHT TRACK SECTION for chains series 879 M - 879 M VG - 880 M - 881 M

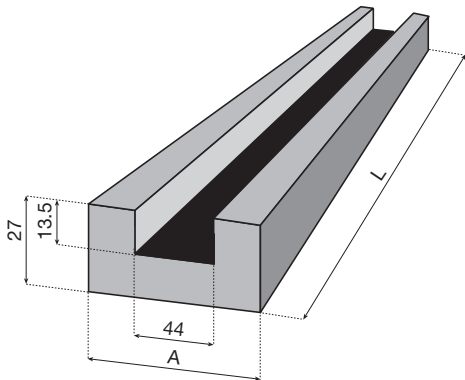

For chains type see pages 30 - 31 - 57 - 82

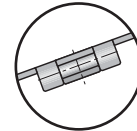

For steel chains, type: 881 M

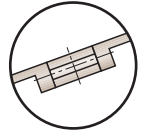

For plastic chains, type: 879 M • 879 M VG 880 M

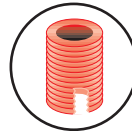

#### Inserts:

The straight tracks section can be supplied with M8 or M10 brass inserts to your detailed drawing



#### Straight tracks section Special Dimensions

On request straight tracks section with special dimensions can be produced.



For further information contact our Engineering Department.

**Material:** Ultra High Molecular Weight Polyethylene to provide minimum friction and reliable long term performance.

**Note:** max. continuous service temperature in air 90°C. Water absorption coefficient = 0.

**Colour:** black.

**Supply:** 1 piece.

FOR CHAINS WIDTH	CODE	A	L
K325	19436	100	2000
	19437	111	
K450	19438	129	
K750	19439	214	

# STRAIGHT TRACK SECTION for chains series 8857 M - 8857 M VG - 882 M - LBP 882 M - 882 M VG

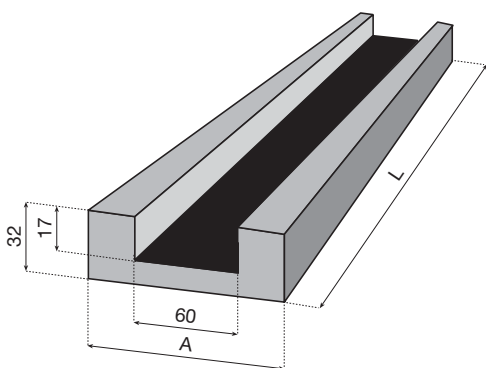

For chains type see pages 32 - 44 - 60 - 72 - 78 - 84

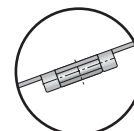

For steel chains, type: 8857 M 8857 M VG

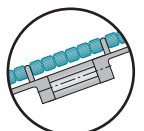

For plastic chains, type: 882 M • LBP 882 M 882 M VG

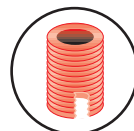

#### Inserts:

The straight tracks section can be supplied with M8 or M10 brass inserts to your detailed drawing



#### Straight tracks section Special Dimensions

On request straight tracks section with special dimensions can be produced.



For further information contact our Engineering Department.

**Material:** Ultra High Molecular Weight Polyethylene to provide minimum friction and reliable long term performance.

**Note:** max. continuous service temperature in air 90°C. Water absorption coefficient = 0.

**Colour:** black.

**Supply:** 1 piece.

FOR CHAINS WIDTH	CODE	A	L
K750	19440	200	2000
K1000	19441	270	
K1200	19442	320	



# STRAIGHT TRACK SECTION for chains series 1843

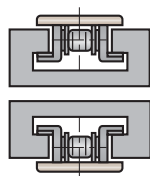
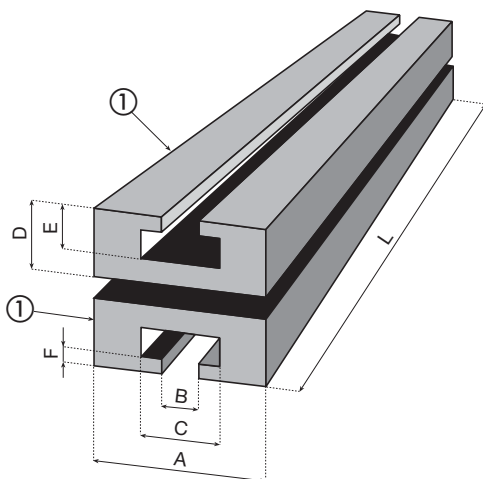

**For further information contact our Engineering Department.**

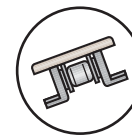

**For plastic chains, type: 1843**

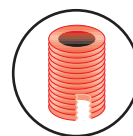

**Inserts:**

The straight tracks section can be supplied with M8 or M10 brass inserts to your detailed drawing



**Straight tracks section Special Dimensions**

On request straight track section with special dimensions can be produced.



For chains type see page 100

**Material:** Ultra High Molecular Weight Polyethylene to provide minimum friction and reliable long term performance.

**Note:** max. continuous service temperature in air 90°C. Water absorption coefficient = 0.

**Colour:** black.

**Supply:** 1 piece

① STRAIGHT TRACK SECTION - 1 PIECE								
FOR CHAIN WIDTH	CODE	A	B	C	D	E	F	L
K125	<b>19410</b>	50	22.5	35	25	19	9	2000
K200	<b>19411</b>	70	22.3	35	25	19	9	2000

# STRAIGHT TRACK SECTION for chains series 1883

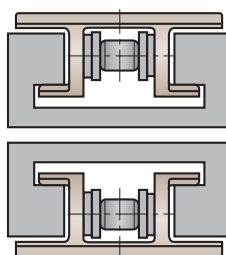
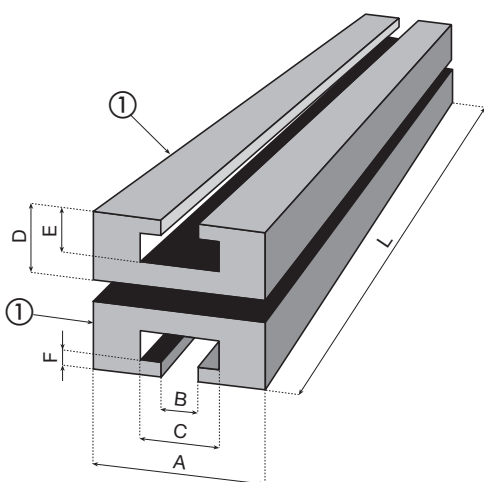

**For further information contact our Engineering Department.**

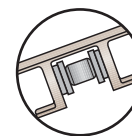

**For plastic chains, type: 1883**

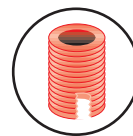

**Inserts:**

The straight tracks section can be supplied with M8 or M10 brass inserts to your detailed drawing



**Straight tracks section Special Dimensions**

On request straight tracks section with special dimensions can be produced.



For chains type see page 104

**Material:** Ultra High Molecular Weight Polyethylene to provide minimum friction and reliable long term performance.

**Note:** max. continuous service temperature in air 90°C. Water absorption coefficient = 0.

**Colour:** black.

**Supply:** 1 piece.

① STRAIGHT TRACK SECTION - 1 PIECE								
FOR CHAIN WIDTH	CODE	A	B	C	D	E	F	L
K325	<b>19412</b>	100	44	70	40	32	22	2000

# STRAIGHT TRACK SECTION for chains series

## 1701 TAB - 1701 TAB OP - 7000 TAB - 7001 TAB - 7005 TAB

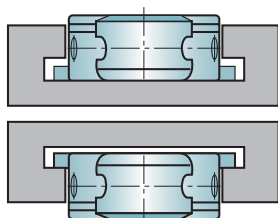
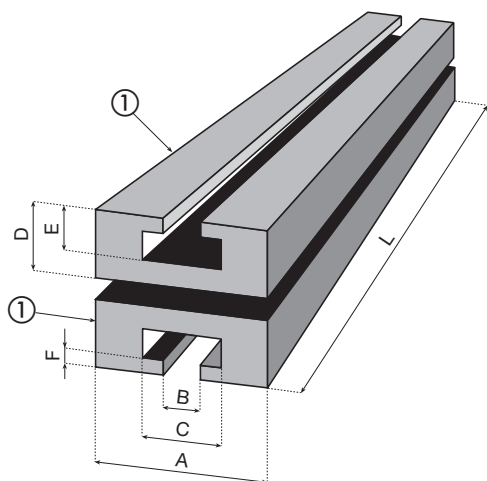

For further information contact our Engineering Department.

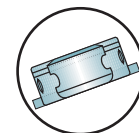

For plastic chains, type:  
1701 TAB • 1701 TAB OP  
7000 TAB • 7001 TAB • 7005 TAB

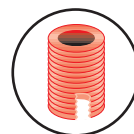

Inserts:

The straight tracks section can be supplied with M8 or M10 brass inserts to your detailed drawing



Straight tracks section  
Special Dimensions

On request straight tracks section with special dimensions can be produced.



For chains type see pages 109 → 116

**Material:** Ultra High Molecular Weight Polyethylene to provide minimum friction and reliable long term performance.

**Note:** max. continuous service temperature in air 90°C. Water absorption coefficient = 0.

**Colour:** black.

**Supply:** 1 piece.

① STRAIGHT TRACK SECTION - 1 PIECE								
FOR CHAIN WIDTH	CODE	A	B	C	D	E	F	L
K55	19386	100	58	75	30	21	12	2000

# STRAIGHT TRACK SECTION for chains series 1700

## 1702 (M) - HMGK 50 (FN-MS-P-M) - 7000 - 7001 - 7005

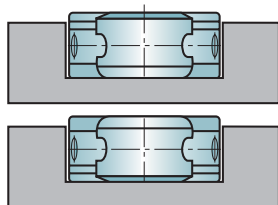
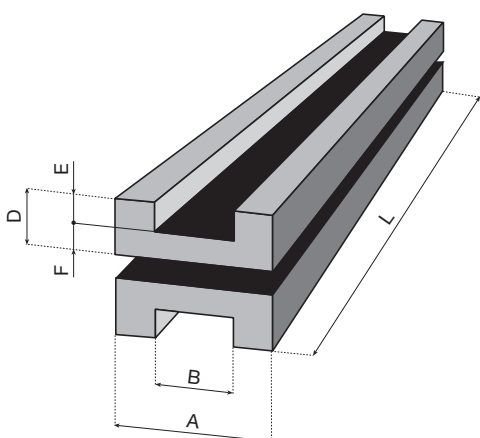

For further information contact our Engineering Department.

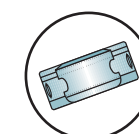

For plastic chains, type:  
1700 • 1702 (M)  
HMGK 50 (FN-MS-P-M)  
7000 • 7001 • 7005

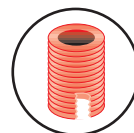

Inserts:

The straight tracks section can be supplied with M8 or M10 brass inserts to your detailed drawing



Straight tracks section  
Special Dimensions

On request straight tracks section with special dimensions can be produced.



For chains type see pages 109 → 116

**Material:** Ultra High Molecular Weight Polyethylene to provide minimum friction and reliable long term performance.

**Note:** max. continuous service temperature in air 90°C. Water absorption coefficient = 0.

**Colour:** black.

**Supply:** 1 piece.

① STRAIGHT TRACK SECTION - 1 PIECE							
FOR CHAIN WIDTH	CODE	A	B	D	E	F	L
K55	19381	100	58	30	21	9	2000

## STRAIGHT TRACK SECTION for chains series HMGK 50 TAB H1 - HMGK 50 TAB H2

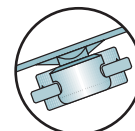
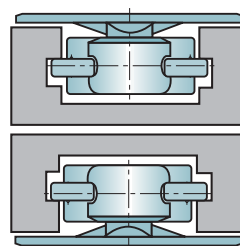
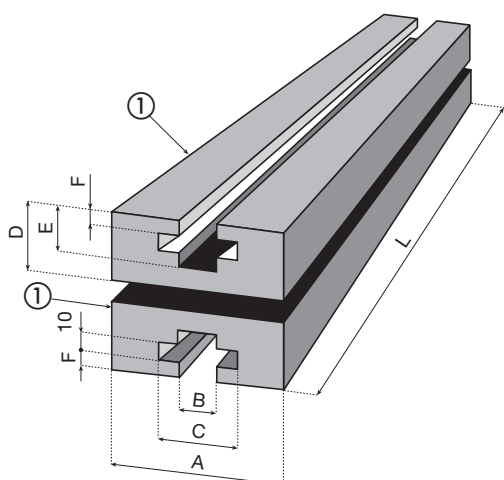

For plastic chains, type:  
HMGK 50 TAB H1  
HMGK 50 TAB H2

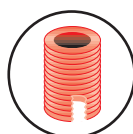

**Inserts:**

The straight tracks section can be supplied with M8 or M10 brass inserts to your detailed drawing



**Straight tracks section Special Dimensions**

On request straight track section with special dimensions can be produced.



For further information contact our Engineering Department.

**Material:** Ultra High Molecular Weight Polyethylene to provide minimum friction and reliable long term performance.

**Note:** max. continuous service temperature in air 90°C. Water absorption coefficient = 0.

**Colour:** black.

**Supply:** 1 piece.

① STRAIGHT TRACK SECTION - 1 PIECE								
FOR CHAIN WIDTH	CODE	A	B	C	D	E	F	L
HMGK 50 TAB H1	19420	110	58	75	40	30.5	14.5	2000
HMGK 50 TAB H2	19421	200						

## STRAIGHT TRACK SECTION for chains series HMGK 50 TAB P1 - HMGK 50 TAB P2

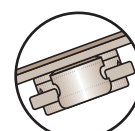
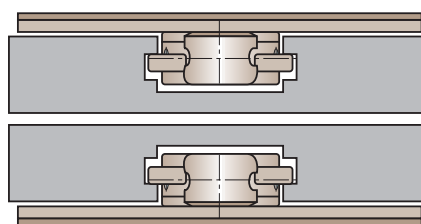
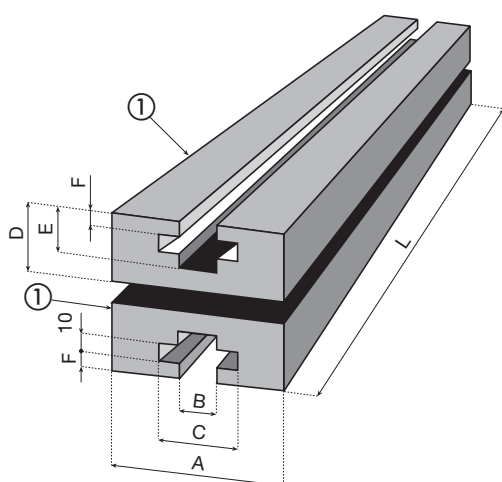

For plastic chains, type:  
HMGK 50 TAB P1  
HMGK 50 TAB P2

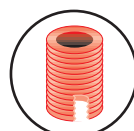

**Inserts:**

The straight tracks section can be supplied with M8 or M10 brass inserts to your detailed drawing



**Straight tracks section Special Dimensions**

On request straight tracks section with special dimensions can be produced.



For further information contact our Engineering Department.

**Material:** Ultra High Molecular Weight Polyethylene to provide minimum friction and reliable long term performance.

**Note:** max. continuous service temperature in air 90°C. Water absorption coefficient = 0.

**Colour:** black.

**Supply:** 1 piece.

① STRAIGHT TRACK SECTION - 1 PIECE								
FOR CHAIN WIDTH	CODE	A	B	C	D	E	F	L
HMGK 50 TAB P1	19422	200	58	75	30	24	9	2000
HMGK 50 TAB P2	19423	270						

# STRAIGHT TRACK SECTION for chains series

## HMGK 50 TAB M1 - HMGK 50 TAB M2 - HMGK 50 TAB M3

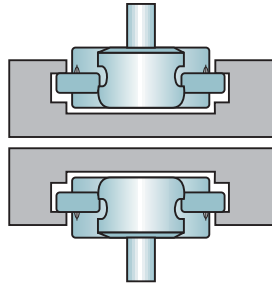
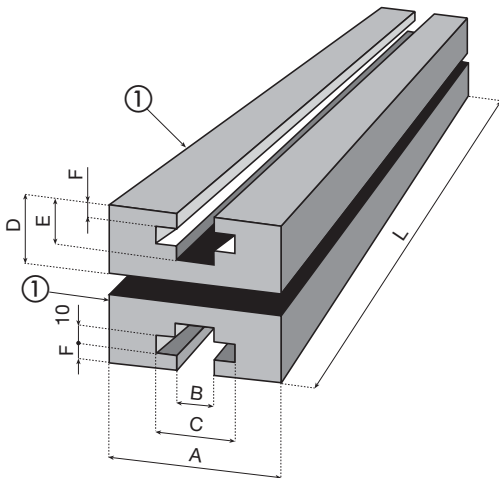

For further information contact our Engineering Department.

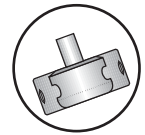

For plastic chains, type:  
HMGK 50 TAB M1  
HMGK 50 TAB M2  
HMGK 50 TAB M3

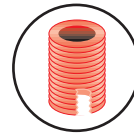

**Inserts:**  
The corner tracks can be supplied with M8 or M10 brass inserts to your detailed drawing



**Corner tracks Special Dimensions**  
On request corner tracks with special dimensions can be produced.



For chains type see page 111

**Material:** Ultra High Molecular Weight Polyethylene to provide minimum friction and reliable long term performance.

**Note:** max. continuous service temperature in air 90°C. Water absorption coefficient = 0.

**Colour:** black.

**Supply:** corner tracks are supplied complete with carry and return plates.

① STRAIGHT TRACK SECTION - 1 PIECE								
FOR CHAIN WIDTH	CODE	A	B	C	D	E	F	L
HMGK 50 TAB M1	19444	100	58	75	30	21	6	2000
HMGK 50 TAB M2								
HMGK 50 TAB M3								