

SPROCKETS for series 812 / 815 - 815 VG - 881 M

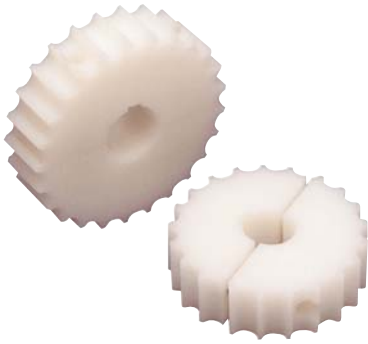

Features:

- Excellent wear and chemical resistance.
- Reduced noise level and quiet operation.
- Reinforced design.
- Completely closed structure, easier to clean and to disinfect
- The design of the sprocket ensures smooth running and long service life.
- Increased keyway strength.



For tolerances and dimensions see pages 332 - 333



For chains type see pages 20 - 21 - 30 - 31 - 36



For chemical resistance see pages 336 - 337

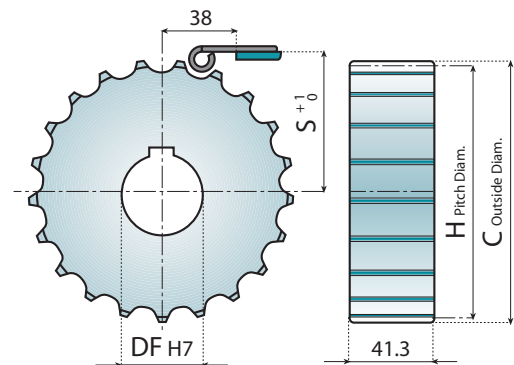
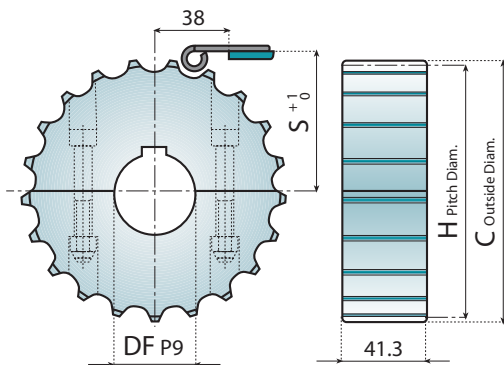

SPLIT SPROCKETS

Material: polyamide, screws in stainless steel, DIN 6885 key seat.

Notes: special shape of teeth compensates natural chain lengthening after prolonged use.



STANDARD SPROCKETS

Material: polyamide, DIN 6885 key seat.

Notes: special shape of teeth compensates natural chain lengthening after prolonged use.

CODE	Z	C mm	H mm	S mm	DF mm
12904	17	103.9	105.47	55.9	18*
12525					25
12526					30
12527					35
12528					40
12905	19	117.0	117.34	61.9	18*
12529					25
12530					30
12538					35
12539					40
12906	21	129.0	129.26	67.8	18*
12540					25
12541					30
12542					35
12543					40
12907	23	142.0	141.21	73.8	18*
12544					25
12545					30
12546					35
12547					40
12908	25	154.0	153.21	79.8	18*
12548					25
12549					30
12550					35
12551					40
121199	27	166.8	165.20	85.8	18*
121200					25
121201					30
121202					35
121203					40
121204	29	178.5	177.24	91.8	18*
121205					25
121206					30
121207					35
121208					40

CODE	Z	C mm	H mm	S mm	DF mm
12552	17	103.9	105.47	55.9	25
12553					30
12554					35
12555					40
12556					19
12557	30				
12558	35				
12559	40				
12560	21	129.0	129.26	67.8	
12561					30
12562					35
12563					40
12564					23
12565	30				
12566	35				
12567	40				
12568	25	154.0	153.21	79.8	
12569					30
12570					35
12571					40
121209					27
121210	30				
121211	35				
121212	40				
121213	29	178.5	177.24	91.8	
121214					30
121215					35
121216					40

* Plain Bore

• Sprockets in material Steel and Cast Iron on request.

IDLER WHEELS for series 812 / 815 - 815 VG - 881 M



Features:

- Excellent wear and chemical resistance.
- Reduced noise level and quiet operation.
- Reinforced design.
- Completely closed structure, easier to clean and to disinfect.
- The design of the sprocket ensures smooth running and long service life.



For tolerances and dimensions see pages 332 - 333



For chains type see pages 20 - 21 - 30 - 31 - 36



For chemical resistance see pages 336 - 337

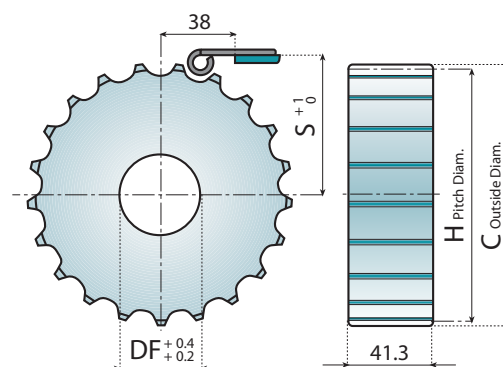
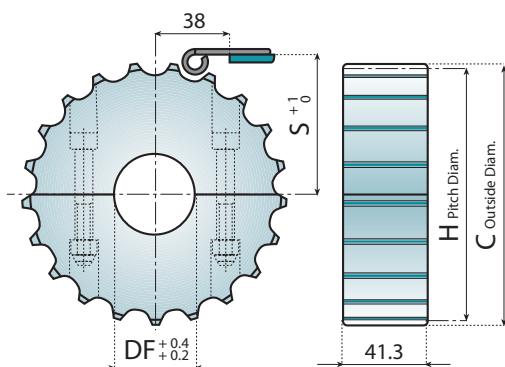

SPLIT IDLER WHEELS

Material: polyamide, screws in stainless steel.

Notes: special shape of teeth compensates natural chain lengthening after prolonged use.



STANDARD IDLER WHEELS

Material: polyamide.

Notes: special shape of teeth compensates natural chain lengthening after prolonged use.

CODE	Z	C mm	H mm	S mm	DF mm
121235					25
121236					30
121237	17	103.9	105.47	55.9	35
121238					40
121239					25
121240					30
121241	19	117.0	117.34	61.9	35
121242					40
121243					25
121244					30
121245	21	129.0	129.26	67.8	35
121246					40
121247					25
121248					30
121249	23	142.0	141.21	73.8	35
121250					40
121251					25
121252					30
121253	25	154.0	153.21	79.8	35
121254					40
121255					25
121256					30
121257	27	166.8	165.20	85.8	35
121258					40
121259					25
121260					30
121261	29	178.5	177.24	91.8	35
121262					40

CODE	Z	C mm	H mm	S mm	DF mm
12572G					18*
12572					25
12573	17	103.9	105.47	55.9	30
12574					35
12575					40
12576G					18*
12576					25
12577	19	117.0	117.34	61.9	30
12578					35
12579					40
12580G					18*
12580					25
12581	21	129.0	129.26	67.8	30
12582					35
12583					40
12584G					18*
12584					25
12585	23	142.0	141.21	73.8	30
12586					35
12587					40
12588G					18*
12588					25
12589	25	154.0	153.21	79.8	30
12590					35
12591					40
121263G					18*
121263					25
121264	27	166.8	165.20	85.8	30
121265					35
121266					40
121267G					18*
121267					25
121268	29	178.5	177.24	91.8	30
121269					35
121270					40

* Plain Bore

• Sprockets in material Steel and Cast Iron on request.

SPROCKETS for series 812 / 815 - 815 VG - 881 M

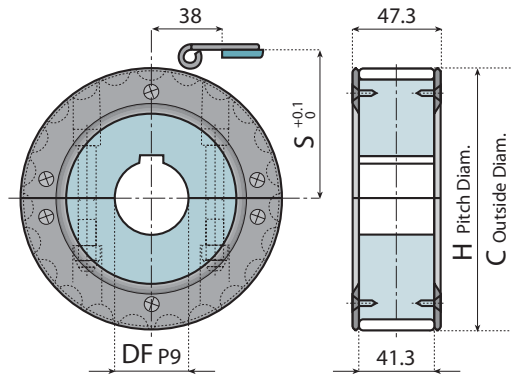

 For tolerances and dimensions see pages 332 - 333

 For chains type see pages 20 - 21 - 30 - 31 - 36

 For chemical resistance see pages 336 - 337

Features:

- Excellent wear and chemical resistance.
- Reduced noise level and quiet operation.
- Reinforced design.
- Completely closed structure, easier to clean and to disinfect.
- The design of the sprocket ensures smooth running and long service life.
- Increased keyway strength.



SPLIT SPROCKETS

Material: polyamide, screws in stainless steel, DIN 6885 key seat.

Notes: special shape of teeth compensates natural chain lengthening after prolonged use.

CODE	Z	C mm	H mm	S mm	DF mm
12906A	21	129.0	129.26	67.8	18*
12540A					25
12541A					30
12542A					35
12543A					40
12907A	23	142.0	141.21	73.8	18*
12544A					25
12545A					30
12546A					35
12547A					40
12908A	25	154.0	153.21	79.8	18*
12548A					25
12549A					30
12550A					35
12551A					40

* Plain Bore

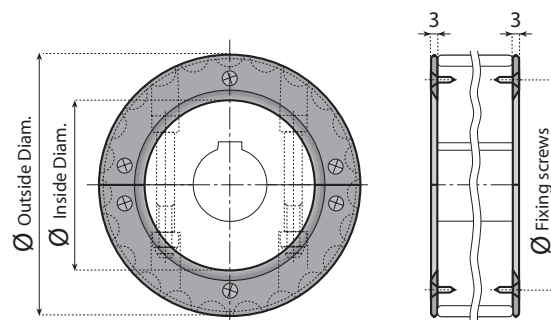

 For chemical resistance see pages 336 - 337

GUIDE RINGS

Material: reinforced polyamide; screws in stainless steel.

Supply: 4 sectors and 12 screws.

CODE	Z	Ø Outside	Ø Inside	Ø Fixing screws
12790B	21	129.25	79	104
12790N				
12791B	23	142	92	116
12791N				
12792B	25	154	104	128
12792N				

SPROCKETS for series 812 / 815 - 815 VG - 881 M



Features:

- Excellent wear and chemical resistance.
- Reduced noise level and quiet operation.
- Reinforced design.
- Completely closed structure, easier to clean and to disinfect.
- Easy replacement of toothed sections without removing the hub.



For tolerances and dimensions see pages 332 - 333



For chains type see pages 20 - 21 - 30 - 31 - 36



For chemical resistance see pages 336 - 337

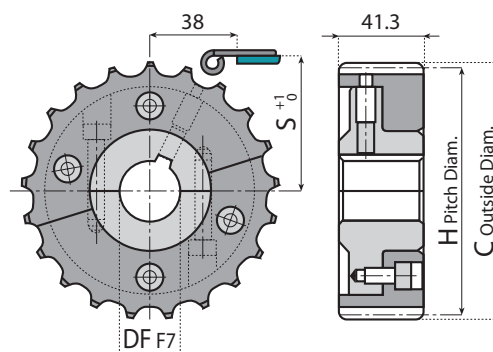
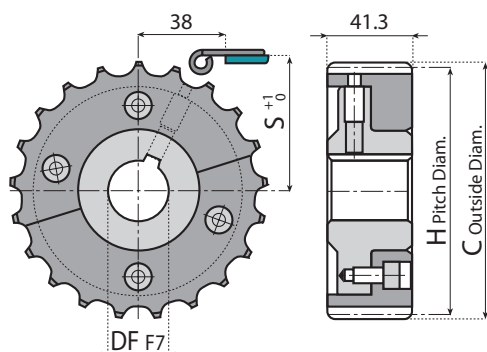

DRIVE SPROCKET IN 3 PIECES

Material: hub in stainless steel AISI 304; screws and pins in stainless steel; toothed sections in polyamide.

Notes: DIN 6885 key seat, axial locking on the shaft with screws M8.



DRIVE SPROCKET IN 4 PIECES

Material: hub in stainless steel AISI 304; screws and pins in stainless steel; toothed sections in polyamide.

Notes: DIN 6885 key seat, axial locking on the shaft with screws M8.

CODE	Z	C mm	H mm	S mm	DF mm
12160	21	129.0	129.26	67.8	30
12161					40
12162	23	142.0	141.21	73.8	30
12163					40
12164	25	154.0	153.21	79.8	30
12165					40

CODE	Z	C mm	H mm	S mm	DF mm
12166	21	129.0	129.26	67.8	30
12167					40
12168	23	142.0	141.21	73.8	30
12169					40
12170	25	154.0	153.21	79.8	30
12171					40

SPROCKETS and IDLER WHEELS for series 812 / 815 - 815 VG - 881 M



SPLIT SPROCKETS

Material: reinforced polyamide, screws in stainless steel, nuts in nickel plated brass, DIN 6885 key seat.



For tolerances and dimensions see pages 332 - 333



For chains type see pages 20 - 21 - 30 - 31 - 36



For chemical resistance see pages 336 - 337

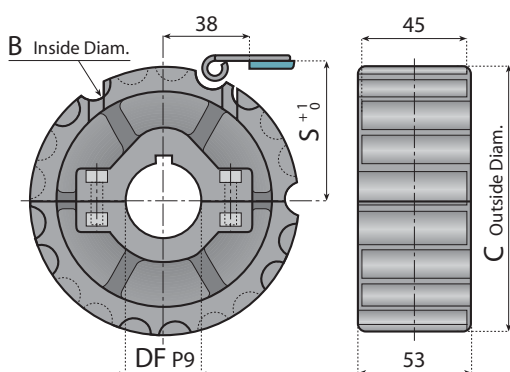

CODE	Z	B mm	C mm	S mm	DF mm
12053					25
12054					30
12055	21	116.1	129	67.8	35
12056					40
12093					45
12099					25
12100					30
12101	23	128.1	142	73.8	35
12102					40
12103					45
12065					25
12066					30
12067	25	140.1	154	79.8	35
12068					40
12094					45



SPLIT IDLER WHEELS

Material: polyamide, screws in stainless steel, nut in nickel plated brass.



For tolerances and dimensions see pages 332 - 333



For chains type see pages 20 - 21 - 30 - 31 - 36



For chemical resistance see pages 336 - 337

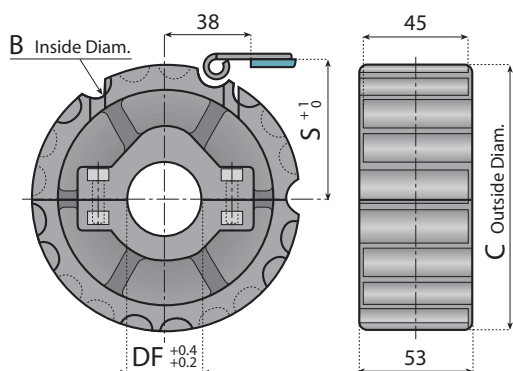

CODE	Z	B mm	C mm	S mm	DF mm
121080					25
121081					30
121082	21	116.1	129	67.8	35
121083					40
121084					45
121085					25
121086					30
121087	23	128.1	142	73.8	35
121088					40
121089					45
121090					25
121091					30
121092	25	140.1	154	79.8	35
121093					40
121094					45

SPROCKETS for series 812 / 815 - 815 VG - 881 M



DRIVE SPROCKETS

Material: reinforced polyamide, screws in stainless steel; DIN 6885 key seat.



For tolerances and dimensions see pages 332 - 333



For chains type see pages 20 - 21 - 30 - 31 - 36



For chemical resistance see pages 336 - 337

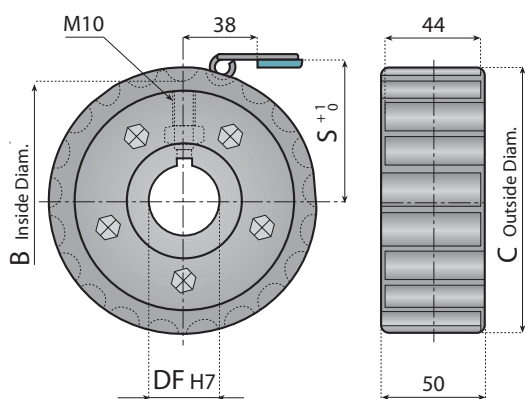

CODE	z	B mm	C mm	H mm	S mm	DF mm
12001						25
12002	19	104.2	117.0	117.34	61.9	30
12003						35
12004						40
12005						25
12006	21	116.1	129.0	129.26	67.8	30
12007						35
12008						40
12009						25
12010	23	128.1	142.0	141.21	73.8	30
12011						35
12012						40
12013						25
12014	25	140.1	154.0	153.2	79.8	30
12015						35
12016						40

IDLER WHEELS for series 812 / 815 - 815 VG - 881 M



Features:

- Excellent wear and chemical resistance.
- Reduced noise level and quiet operation.
- Reinforced design.
- Completely closed structure, easier to clean and to disinfect.
- Recyclable.
- Quickly replaceable.
- Convenient.



For tolerances and dimensions see pages 332 - 333



For chains type see pages 20 - 21 - 30 - 31 - 36



For chemical resistance see pages 336 - 337

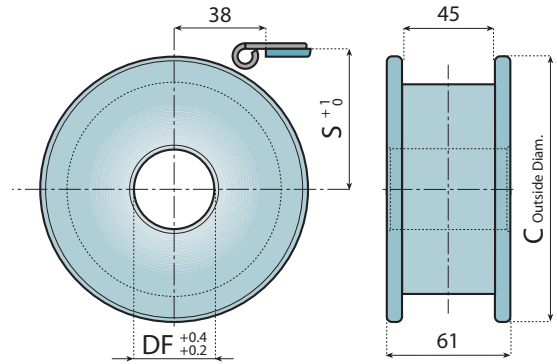
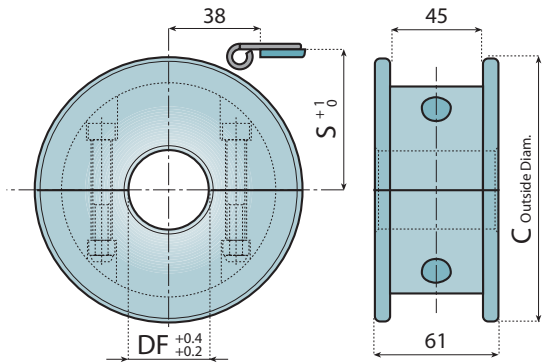

SPLIT IDLER WHEELS

Material: polyamide, screws in stainless steel.



STANDARD IDLER WHEELS

Material: polyamide.

CODE	Z equiv.	C mm	S mm	DF mm
12608	17	104.0	56.2	20
12609				25
12610				30
12611				35
12612				40
12613	19	117.0	62.6	20
12614				25
12615				30
12616				35
12618				40
12617	21	129.8	68.6	20
12619				25
12620				30
12621				35
12622				40
12623	23	142.2	74.6	20
12624				25
12625				30
12626				35
12627				40
12628	25	154.7	80.5	20
12629				25
12630				30
12631				35
12632				40
121357	27	167.2	88.5	20
121358				25
121359				30
121360				35
121361				40
121362	29	179.3	92.8	20
121363				25
121364				30
121365				35
121366				40

CODE	Z equiv.	C mm	S mm	DF mm
12633	17	104.0	56.2	20
12634				25
12635				30
12636				35
12637				40
12638	19	117.0	62.6	20
12639				25
12640				30
12641				35
12642				40
12643	21	129.8	68.6	20
12644				25
12645				30
12646				35
12647				40
12648	23	142.2	74.6	20
12649				25
12650				30
12651				35
12652				40
12653	25	154.7	80.5	20
12654				25
12655				30
12656				35
12657				40
121367	27	167.2	88.5	20
121368				25
121369				30
121370				35
121371				40
121372	29	179.3	92.8	20
121373				25
121374				30
121375				35
121376				40

IDLER WHEELS for series 812 / 815 - 815 VG - 881 M



IDLER WHEELS with Low Friction Bushing

Material: ultrasonic welded cover in reinforced polyamide.

Bushing in Low Friction and

Low Corrosion resin.

Idler body in self-lubricating polyamide.



For tolerances and dimensions see pages 332 - 333



For chains type see pages 20 - 21 - 30 - 31 - 36



For chemical resistance see pages 336 - 337

**Corrosion
Resistant**

Colour: black and green.

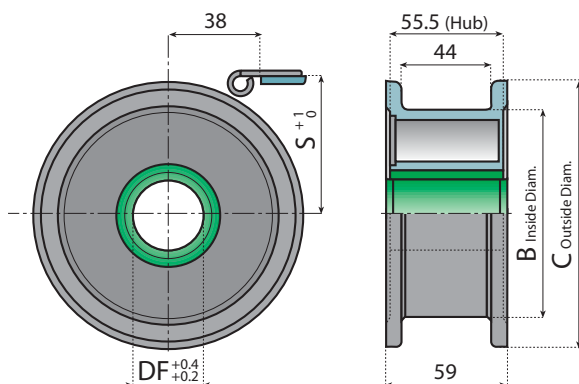

CODE	Z equiv.	B mm	C mm	S mm	DF mm
12866					25
12867					30
12868	21	103.5	129.5	68.6	35
12869					40
12874					25
12875					30
12876	23	103.5	143.0	74.6	35
12877					40
12870					25
12871					30
12872	25	122	154.5	80.5	35
12873					40



REINFORCED IDLER WHEELS

Material: self-lubricating polyamide.

Colour: grey or black

Notes: reinforced version, high wear and chemical resistance, recyclable.



For tolerances and dimensions see pages 332 - 333



For chains type see pages 20 - 21 - 30 - 31 - 36



For chemical resistance see pages 336 - 337

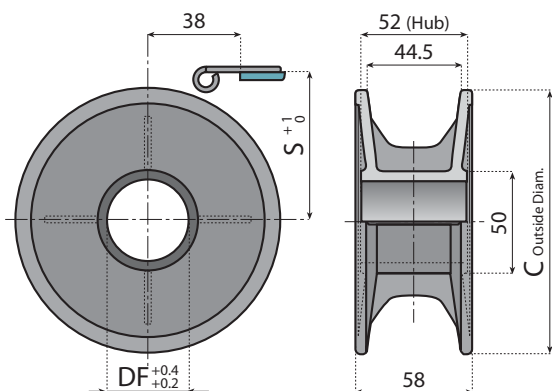

CODE		Z equiv.	C mm	S mm	DF mm
Grey	Black				
12208	12208B				25
12209	12209B				30
12210	12210B	19	117.0	62.6	35
12211	12211B				40
12200	12200B				25
12201	12201B				30
12202	12202B	21	129.8	68.6	35
12203	12203B				40
12212	12212B				25
12213	12213B				30
12214	12214B	23	142.2	74.6	35
12215	12215B				40
12204	12204B				25
12205	12205B				30
12206	12206B	25	154.7	80.5	35
12207	12207B				40

IDLER WHEELS for series 812 / 815 - 815 VG - 881 M



SPLIT IDLER WHEELS

Material: self-lubricating polyamide, screws in stainless steel.

Colour: grey or black.

Notes: quickly replaceable, reinforced version, high wear and chemical resistance, recyclable.



For tolerances and dimensions see pages 332 - 333



For chains type see pages 20 - 21 - 30 - 31 - 36



For chemical resistance see pages 336 - 337

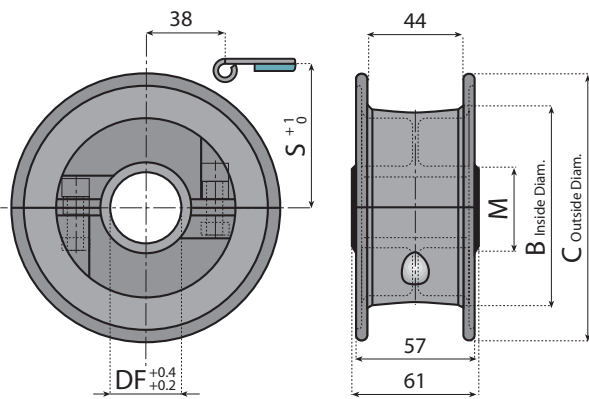

CODE		Z equiv.	M mm	B mm	C mm	S mm	DF mm
Grey	Black						
12077	12077B	21	35	97	129.8	68.6	25
12078	12078B		40				30
12079	12079B		45				35
12080	12080B		50				40
12081	12081B	25	35	102	154.7	80.5	25
12082	12082B		40				30
12083	12083B		45				35
12084	12084B		50				40



IDLER WHEELS

Material: self-lubricating polyamide, screws in zinc plated steel.



For tolerances and dimensions see pages 332 - 333



For chains type see pages 20 - 21 - 30 - 31 - 36

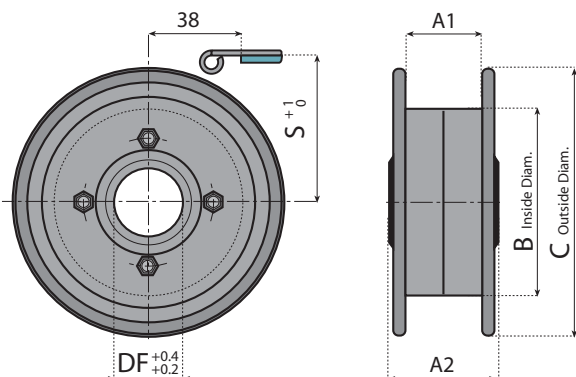

CODE	Z equiv.	A1 mm	A2 mm	B mm	C mm	S mm	DF mm
12676	15	48	83	58	90	48.2	30
12677							35
12678							40
12679							45
12278	17	44	52	71	106	56.2	25
12279							30
12680	19	44	60	80	118	62.6	25
12681							30
12682							35
12683							40
12684	21	44	60	80	129.8	68.6	25
12685							30
12686							35
12687							40
12688	23	44	60	108	142.5	74.6	25
12689							30
12690							35
12691							40
12692	25	44	60	108	155	80.5	25
12693							30
12694							35
12695							40

SPROCKETS for series 815 MINI



Features:

- Excellent wear and chemical resistance.
- Reduced noise level and quiet operation.
- Reinforced design.
- Completely closed structure, easier to clean and to disinfect.
- The design of the sprocket ensures smooth running and long service life.
- Increased keyway strength.

 For tolerances and dimensions see pages 332 - 333

 For chemical resistance see pages 336 - 337

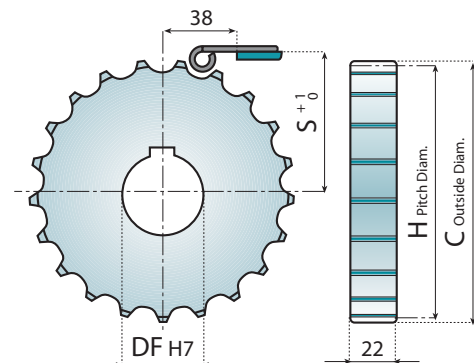
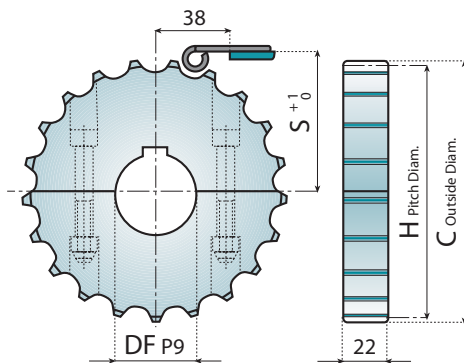

SPLIT SPROCKETS

Material: polyamide, screws in stainless steel,
DIN 6885 key seat.

Notes: special shape of teeth compensates natural chain lengthening after prolonged use.



STANDARD SPROCKETS

Material: polyamide, DIN 6885 key seat.

Notes: special shape of teeth compensates natural chain lengthening after prolonged use.

CODE	Z	C mm	H mm	S mm	DF mm
122000					18*
122001					25
122002	19	117.0	117.34	61.9	30
122003					35
122004					40
122005					18*
122006					25
122007	21	129.0	129.26	67.8	30
122008					35
122009					40
122010					18*
122011					25
122012	23	142.0	141.21	73.8	30
122013					35
122014					40
122015					18*
122016					25
122017	25	154.0	153.21	79.8	30
122018					35
122019					40

CODE	Z	C mm	H mm	S mm	DF mm
122020					25
122021	19	117.0	117.34	61.9	30
122022					35
122023					40
122024					25
122025	21	129.0	129.26	67.8	30
122026					35
122027					40
122028					25
122029	23	142.0	141.21	73.8	30
122030					35
122031					40
122032					25
122033	25	154.0	153.21	79.8	30
122034					35
122035					40

* Plain Bore

IDLER WHEELS for series 815 MINI



Features:

- Excellent wear and chemical resistance.
- Reduced noise level and quiet operation.
- Reinforced design.
- Completely closed structure, easier to clean and to disinfect.
- The design of the sprocket ensures smooth running and long service life.



For tolerances and dimensions see pages 332 - 333



For chemical resistance see pages 336 - 337

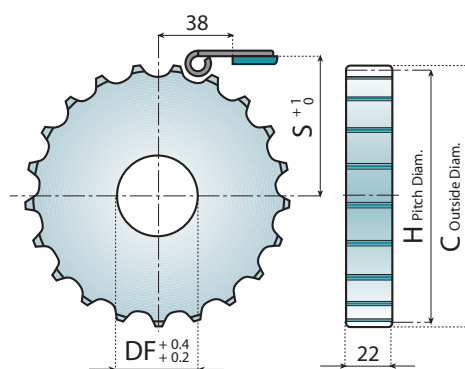
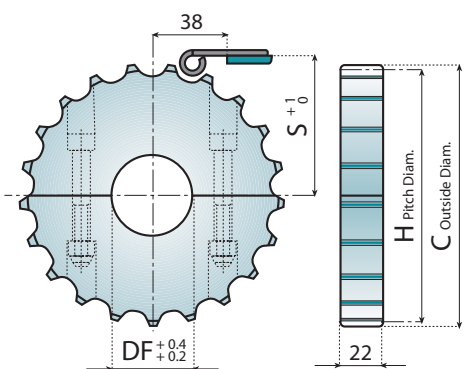

SPLIT IDLER WHEELS

Material: polyamide, screws in stainless steel.

Notes: special shape of teeth compensates natural chain lengthening after prolonged use.



STANDARD IDLER WHEELS

Material: polyamide.

Notes: special shape of teeth compensates natural chain lengthening after prolonged use.

CODE	Z	C mm	H mm	S mm	DF mm
122036					25
122037	19	117.0	117.34	61.9	30
122038					35
122039					40
122040					25
122041	21	129.0	129.26	67.8	30
122042					35
122043					40
122044					25
122045	23	142.0	141.21	73.8	30
122046					35
122047					40
122048					25
122049	25	154.0	153.21	79.8	30
122050					35
122051					40

CODE	Z	C mm	H mm	S mm	DF mm
122052G					18*
122052	19	117.0	117.34	61.9	25
122053					30
122054					35
122055					40
122056G					18*
122056	21	129.0	129.26	67.8	25
122057					30
122058					35
122059					40
122060G					18*
122060	23	142.0	141.21	73.8	25
122061					30
122062					35
122063					40
122064G					18*
122064	25	154.0	153.21	79.8	25
122065					30
122066					35
122067					40

* Plain Bore

IDLER WHEELS for series 815 MINI



Advantages:

- Excellent wear and chemical resistance.
- Reduced noise level and quiet operation.
- Reinforced dexeuction.
- Completely closed structure, easier to clean and to disinfect.
- Recyclable.
- Quickly replaceable.
- Convenient.



For tolerances and dimensions see pages 332 - 333



For chemical resistance see pages 336 - 337

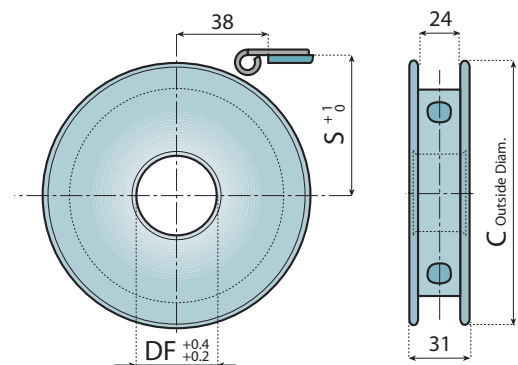
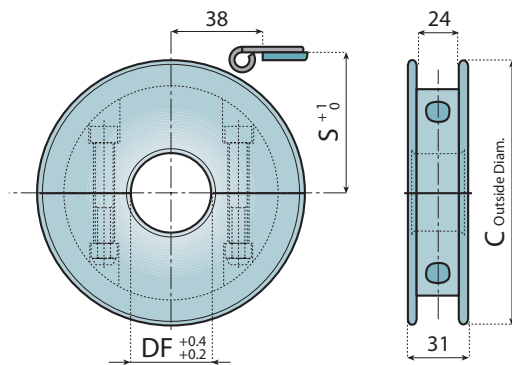

SPLIT IDLER WHEELS

Material: polyamide, screws in stainless steel.



STANDARD IDLER WHEELS

Material: polyamide.

CODE	Z equiv.	C mm	S mm	DF mm
122068				20
122069				25
122070	19	117.0	62.6	30
122071				35
122072				40
122073				20
122074				25
122075	21	129.8	68.6	30
122076				35
122077				40
122078				20
122079				25
122080	23	142.2	74.6	30
122081				35
122082				40
122083				20
122084				25
122085	25	154.7	80.5	30
122086				35
122087				40

CODE	Z equiv.	C mm	S mm	DF mm
122088				20
122089				25
122090	19	117.0	62.6	30
122091				35
122092				40
122093				20
122094				25
122095	21	129.8	68.6	30
122096				35
122097				40
122098				20
122099				25
122100	23	142.2	74.6	30
122101				35
122102				40
122103				20
122104				25
122105	25	154.7	80.5	30
122106				35
122107				40

SPROCKETS for series 800 - 802 - 805 - 805 VG



Features:

- Excellent wear and chemical resistance.
- Reduced noise level and quiet operation.
- Reinforced design.
- Completely closed structure, easier to clean and to disinfect.
- Increased keyway strength.
- The design of the sprocket ensures smooth running and long service life.

 For tolerances and dimensions see pages 332 - 333

 For chains type see pages 22 - 38

 For chemical resistance see pages 336 - 337

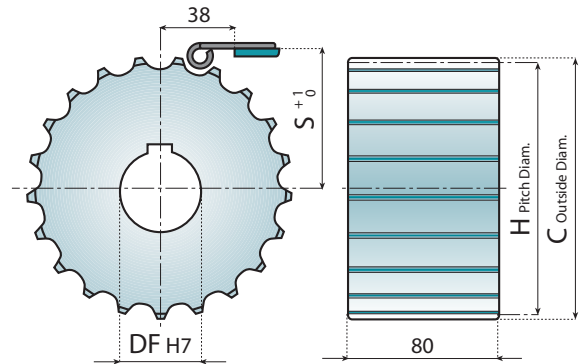
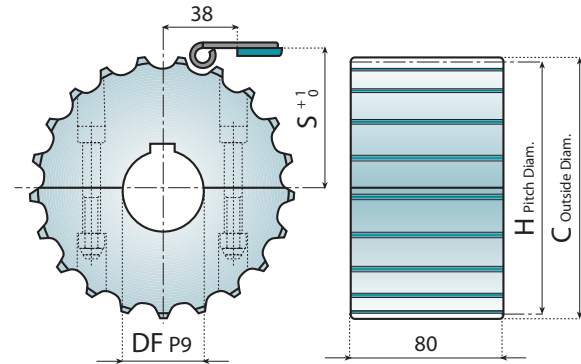

SPLIT SPROCKETS

Material: polyamide, screws in stainless steel, DIN 6885 key seat.

Notes: special shape of teeth compensates natural chain lengthening after prolonged use.



STANDARD SPROCKETS

Material: polyamide, DIN 6885 key seat.

Notes: special shape of teeth compensates natural chain lengthening after prolonged use.

CODE	Z	C mm	H mm	S mm	DF mm
12900	19	117.0	117.34	61.9	18*
12280					25
12281					30
12282					35
12283					40
12901	21	129.0	129.26	67.8	18*
12284					25
12285					30
12286					35
12287					40
12902	23	142.0	141.21	73.8	18*
12288					25
12289					30
12290					35
12291					40
12903	25	154.0	153.21	79.8	18*
12292					25
12293					30
12294					35
12295					40
121307	27	166.8	165.20	85.8	18*
121308					25
121309					30
121310					35
121311					40
121312	29	178.5	177.24	91.8	18*
121313					25
121314					30
121315					35
121316					40

CODE	Z	C mm	H mm	S mm	DF mm
12296	19	117.0	117.34	61.9	25
12297					30
12298					35
12299					40
12437					21
12438	30				
12439	35				
12440	40				
12441	23	142.0	141.21	73.8	
12442					30
12443					35
12444					40
12445					25
12446	30				
12447	35				
12448	40				
121317	27	166.8	165.20	85.8	
121318					30
121319					35
121320					40
121321					29
121322	30				
121323	35				
121324	40				

* Plain Bore

• Sprockets in material Steel and Cast Iron on request.

IDLER WHEELS for series 800 - 802 - 805 - 805 VG



Features:

- Excellent wear and chemical resistance.
- Reduced noise level and quiet operation.
- Reinforced design.
- Completely closed structure, easier to clean and to disinfect.
- The design of the sprocket ensures smooth running and long service life.

 For tolerances and dimensions see pages 332 - 333

 For chains type see pages 22 - 38

 For chemical resistance see pages 336 - 337

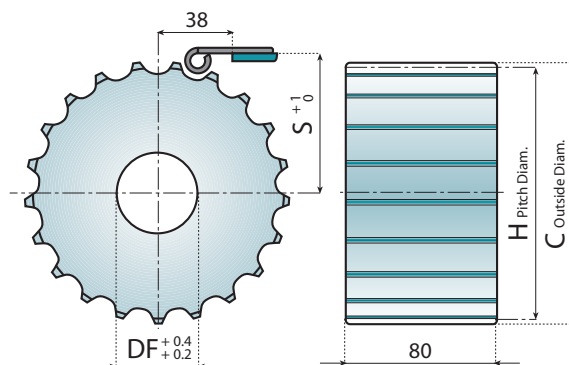
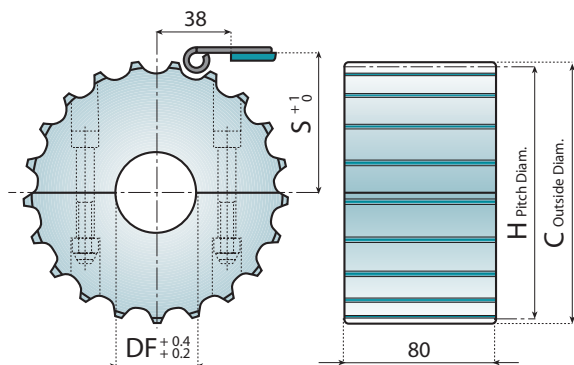

SPLIT IDLER WHEELS

Material: polyamide, screws in stainless steel.

Notes: special shape of teeth compensates natural chain lengthening after prolonged use.



STANDARD IDLER WHEELS

Material: polyamide.

Notes: special shape of teeth compensates natural chain lengthening after prolonged use.

CODE	Z	C mm	H mm	S mm	DF mm
121325					25
121326					30
121327	19	117.0	117.34	61.9	35
121328					40
121329					25
121330					30
121331	21	129.0	129.26	67.8	35
121332					40
121333					25
121334					30
121335	23	142.0	141.21	73.8	35
121336					40
121337					25
121338					30
121339	25	154.0	153.21	79.8	35
121340					40
121341					25
121342					30
121343	27	166.8	165.20	85.8	35
121344					40
121345					25
121346					30
121347	29	178.5	177.24	91.8	35
121348					40

CODE	Z	C mm	H mm	S mm	DF mm
12449G					18*
12449					25
12450	19	117.0	117.34	61.9	30
12451					35
12452					40
12453G					18*
12453					25
12454	21	129.0	129.26	67.8	30
12455					35
12456					40
12457G					18*
12457					25
12458	23	142.0	141.21	73.8	30
12459					35
12460					40
12461G					18*
12461					25
12462	25	154.0	153.21	79.8	30
12463					35
12464					40
121349G					18*
121349					25
121350	27	166.8	165.20	85.8	30
121351					35
121352					40
121353G					18*
121353					25
121354	29	178.5	177.24	91.8	30
121355					35
121356					40

* Plain Bore

• Idler wheels in material Steel and Cast Iron on request.

SPROCKETS for series 800 - 802 - 805 - 805 VG

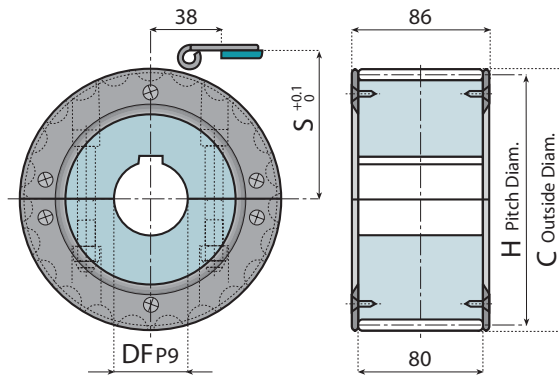

 For tolerances and dimensions see pages 332 - 333

 For chains type see pages 22 - 38

 For chemical resistance see pages 336 - 337

Features:

- Excellent wear and chemical resistance.
- Reduced noise level and quiet operation.
- Reinforced design.
- Completely closed structure, easier to clean and to disinfect.
- The design of the sprocket ensures smooth running and long service life.
- Increased keyway strength.



SPLIT SPROCKETS

Material: polyamide, screws in stainless steel, DIN 6885 key seat.

Notes: special shape of teeth compensates natural chain lengthening after prolonged use.

CODE	Z	C mm	H mm	S mm	DF mm
12901A	21	129.0	129.26	67.8	18*
12284A					25
12285A					30
12286A					35
12287A					40
12902A	23	142.0	141.21	73.8	18*
12288A					25
12289A					30
12290A					35
12291A					40
12903A	25	154.0	153.21	79.8	18*
12292A					25
12293A					30
12294A					35
12295A					40

* Plain Bore

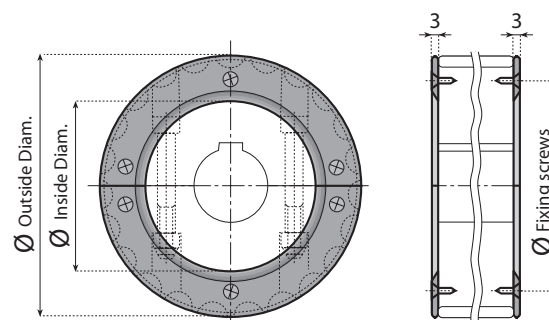

 For chemical resistance see pages 336 - 337

GUIDE RINGS

Material: reinforced polyamide; screws in stainless steel.

Supply: 4 sectors and 12 screws.

CODE	Z	Ø Outside	Ø Inside	Ø Fixing screws
12790B	21	129.25	79	104
12790N				
12791B	23	142	92	116
12791N				
12792B	25	154	104	128
12792N				

SPROCKETS for series 800 - 802 - 805 - 805 VG



Features:

- Excellent wear and chemical resistance.
- Reduced noise level and quiet operation.
- Reinforced design.
- Completely closed structure, easier to clean and to disinfect
- Recyclable.
- Quickly replaceable.

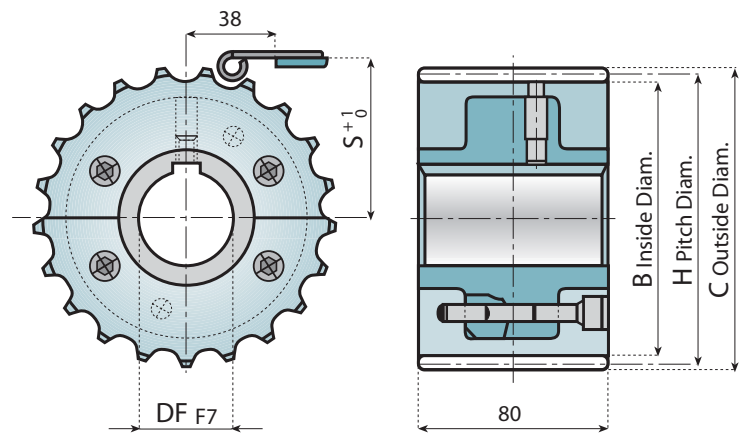

**DRIVE SPROCKET
IN 5 SECTIONS**

Material: hub in stainless steel AISI 304, screws and pins in stainless steel, toothed sections in polyamide.

Notes: DIN 6885 key seat, axial locking on the shaft with screws M8. Toothed sections can be replaced without removing the hub from the shaft.

CODE Standard	CODE Toothed Sections	Z mm	B mm	C mm	H mm	S mm	DF mm
12150	12156	21	116.1	129.0	129.26	67.8	30
12151							40
12152	12157	23	128.1	142.0	141.21	73.8	30
12153							40
12154	12158	25	140.1	154.0	153.2	79.8	30
12155							40



For tolerances and dimensions see pages 332 - 333



For chains type see pages 22 - 38

SPROCKETS and IDLER WHEELS

for series 800 - 802 - 805 - 805 VG

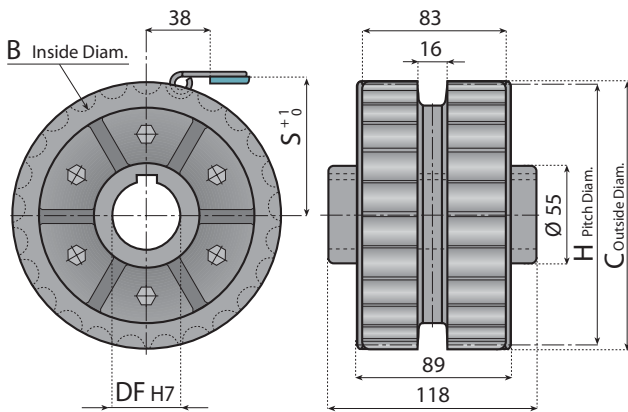

DRIVE SPROCKETS

Material: reinforced polyamide, screws in stainless steel, DIN 6885 key seat.



For tolerances and dimensions see pages 332 - 333



For chains type see pages 22 - 38



For chemical resistance see pages 336 - 337

CODE	z	B mm	C mm	H mm	S mm	DF mm
12033						25
12034	25	140.1	154	153.2	79.8	30
12035						35
12036						40

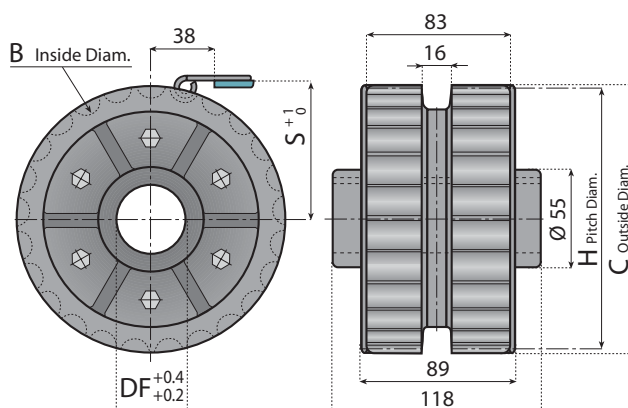

IDLER WHEELS

Material: polyamide, screws in stainless steel.



For tolerances and dimensions see pages 332 - 333



For chains type see pages 22 - 38



For chemical resistance see pages 336 - 337

CODE	z	B mm	C mm	H mm	S mm	DF mm
12037						25
12038	25	140.1	154	153.2	79.8	30
12039						35
12040						40

IDLER WHEELS for series 800 - 802 - 805 - 805 VG



Features:

- Excellent wear and chemical resistance.
- Reduced noise level and quiet operation.
- Reinforced design.
- Completely closed structure, easier to clean and to disinfect.
- The design of the sprocket ensures smooth running and long service life.
- Convenient.

 For tolerances and dimensions see pages 332 - 333

 For chains type see pages 22 - 38

 For chemical resistance see pages 336 - 337

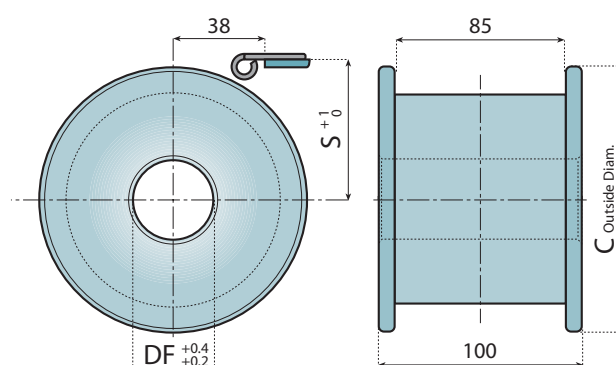
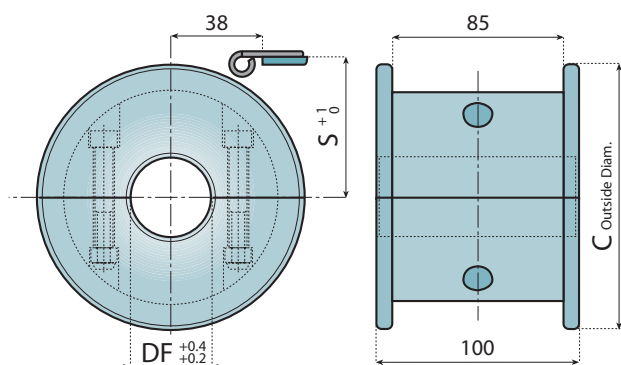

SPLIT IDLER WHEELS

Material: polyamide, screws in stainless steel.



STANDARD IDLER WHEELS

Material: polyamide.

CODE	Z equiv.	C mm	S mm	DF mm
12980				20
12981				25
12982	19	117.0	62.6	30
12983				35
12984				40
12985				20
12986				25
12987	21	129.8	68.6	30
12988				35
12989				40
12990				20
12991				25
12992	23	142.2	74.6	30
12993				35
12994				40
12995				20
12996				25
12997	25	154.7	80.5	30
12998				35
12999				40
121527				20
121528				25
121529	27	167.2	86.5	30
121530				35
121531				40
121532				20
121533				25
121534	29	179.3	92.8	30
121535				35
121536				40

CODE	Z equiv.	C mm	S mm	DF mm
12130				20
12131				25
12132	19	117.0	62.6	30
12133				35
12134				40
12135				20
12136				25
12137	21	129.8	68.6	30
12138				35
12139				40
12140				20
12141				25
12142	23	142.2	74.6	30
12143				35
12144				40
12145				20
12146				25
12147	25	154.7	80.5	30
12148				35
12149				40
121537				20
121538				25
121539	27	167.2	86.5	30
121540				35
121541				40
121542				20
121543				25
121544	29	179.3	92.8	30
121545				35
121546				40

IDLER WHEELS for series 800 - 802 - 805 - 805 VG



IDLER WHEELS

Material: self-lubricating polyamide, screws in zinc plated steel.



For tolerances and dimensions see pages 332 - 333



For chains type see pages 22 - 38



For chemical resistance see pages 336 - 337

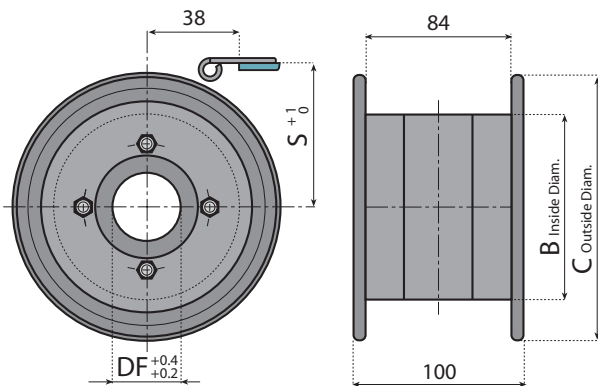

CODE	Z equiv.	B mm	C mm	S mm	DF mm
121616					25
121617	19	80	118	62.6	30
121618					35
121619					40
121620					25
121621	21	80	129.8	68.6	30
121622					35
121623					40
121624					25
121625	23	108	142.5	74.6	30
121626					35
121627					40
121628					25
121629	25	108	155	80.5	30
121630					35
121631					40

SPROCKETS for series 8157 - 8857 M - 8157 VG - 8857 M VG

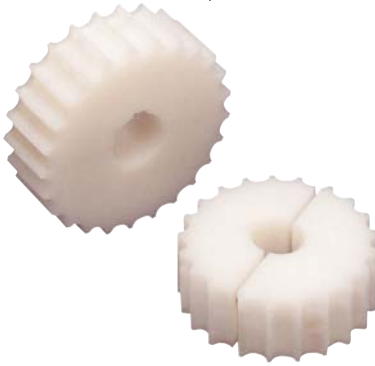

Features:

- Excellent wear and chemical resistance.
- Reduced noise level and quiet operation
- Reinforced design.
- Completely closed structure, easier to clean and to disinfect
- The design of the sprocket ensures smooth running and long service life.
- Increased keyway strength.

 For tolerances and dimensions see pages 332 - 333

 For chains type see pages 23 - 32 - 39 - 44

 For chemical resistance see pages 336 - 337

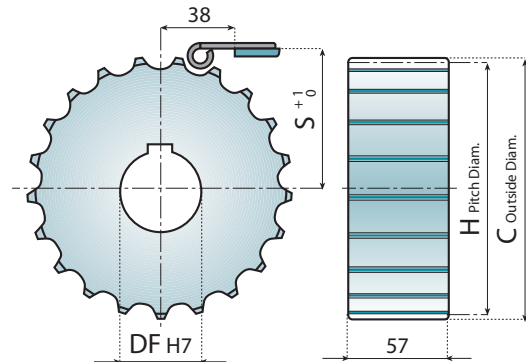
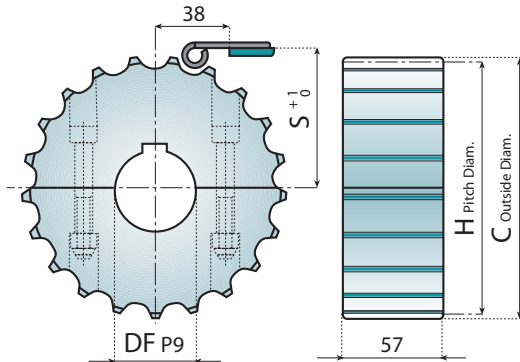

SPLIT SPROCKETS

Material: polyamide, screws in stainless steel, DIN 6885 key seat.

Notes: special shape of teeth compensates natural chain lengthening after prolonged use.



STANDARD SPROCKETS

Material: polyamide, DIN 6885 key seat.

Notes: special shape of teeth compensates natural chain lengthening after prolonged use.

CODE	Z	C mm	H mm	S mm	DF mm
121800	17	103.9	105.47	55.9	18*
121801					25
121802					30
121803					35
121804					40
121805	19	117.0	117.34	61.9	18*
121806					25
121807					30
121808					35
121809					40
121810	21	129.0	129.26	67.8	18*
121811					25
121812					30
121813					35
121814					40
121815	23	142.0	141.21	73.8	18*
121816					25
121817					30
121818					35
121819					40
121820	25	154.0	153.21	79.8	18*
121821					25
121822					30
121823					35
121824					40
121825	27	166.8	165.20	85.8	18*
121826					25
121827					30
121828					35
121829					40
121830	29	178.5	177.24	91.8	18*
121831					25
121832					30
121833					35
121834					40

CODE	Z	C mm	H mm	S mm	DF mm
121835	17	103.9	105.47	55.9	25
121836					30
121837					35
121838					40
121839					25
121840	19	117.0	117.34	61.9	30
121841					35
121842					40
121843					25
121844					30
121845	21	129.0	129.26	67.8	35
121846					40
121847					25
121848					30
121849					35
121850	23	142.0	141.21	73.8	40
121851					25
121852					30
121853					35
121854					40
121855	27	166.8	165.20	85.8	25
121856					30
121857					35
121858					40
121859					29
121860	30				
121861	35				
121862	40				

* Plain Bore

• Sprockets in material Steel on request.

IDLER WHEELS for series 8157 - 8857 M - 8157 VG - 8857 M VG



Features:

- Excellent wear and chemical resistance.
- Reduced noise level and quiet operation
- Reinforced design.
- Completely closed structure, easier to clean and to disinfect
- The design of the sprocket ensures smooth running and long service life.

 For tolerances and dimensions see pages 332 - 333

 For chains type see pages 23 - 32 - 39 - 44

 For chemical resistance see pages 336 - 337

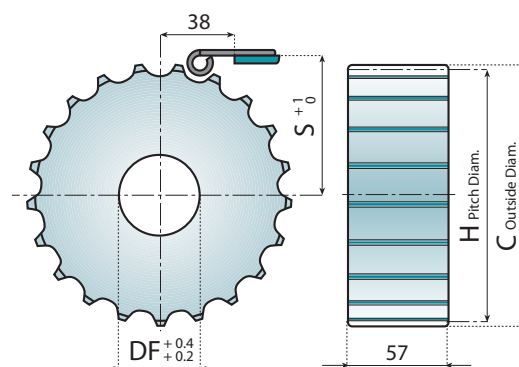
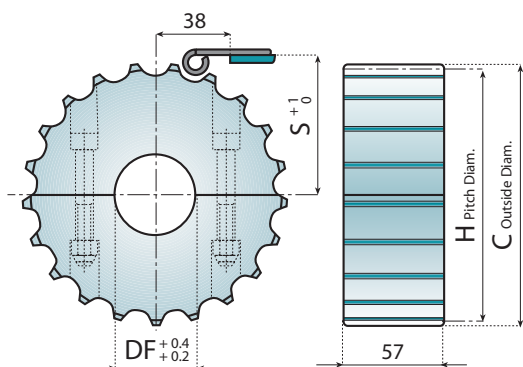

 **SPLIT IDLER WHEELS**

Material: polyamide, screws in stainless steel.

Notes: special shape of teeth compensates natural chain lengthening after prolonged use.

 **STANDARD IDLER WHEELS**

Material: polyamide.

Notes: special shape of teeth compensates natural chain lengthening after prolonged use.

CODE	Z	C mm	H mm	S mm	DF mm
121863	17	103.9	105.47	55.9	25
121864					30
121865					35
121866					40
121867	19	117.0	117.34	61.9	25
121868					30
121869					35
121870					40
121871	21	129.0	129.26	67.8	25
121872					30
121873					35
121874					40
121875	23	142.0	141.21	73.8	25
121876					30
121877					35
121878					40
121879	25	154.0	153.21	79.8	25
121880					30
121881					35
121882					40
121883	27	166.8	165.20	85.8	25
121884					30
121885					35
121886					40
121887	29	178.5	177.24	91.8	25
121888					30
121889					35
121890					40



CODE	Z	C mm	H mm	S mm	DF mm
121891G	17	103.9	105.47	55.9	18*
121891					25
121892					30
121893					35
121894	40				
121895G	19	117.0	117.34	61.9	18*
121895					25
121896					30
121897					35
121898	40				
121899G	21	129.0	129.26	67.8	18*
121899					25
121900					30
121901					35
121902	40				
121903G	23	142.0	141.21	73.8	18*
121903					25
121904					30
121905					35
121906	40				
121907G	25	154.0	153.21	79.8	18*
121907					25
121908					30
121909					35
121910	40				
121911G	27	166.8	165.20	85.8	18*
121911					25
121912					30
121913					35
121914	40				
121914G	29	178.5	177.24	91.8	18*
121915					25
121916					30
121917					35
121918	40				

* Plain Bore

• Idler wheels in material Steel on request.

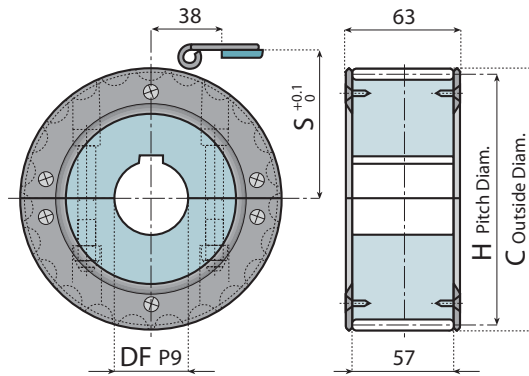
SPROCKETS for series 8157 - 8857 M - 8157 VG - 8857 M VG



-  For tolerances and dimensions see pages 332 - 333
-  For chains type see pages 23 - 32 - 39 - 44
-  For chemical resistance see pages 336 - 337

Features:

- Excellent wear and chemical resistance.
- Reduced noise level and quiet operation
- Reinforced design.
- Completely closed structure, easier to clean and to disinfect
- The design of the sprocket ensures smooth running and long service life.
- Increased keyway strength.



SPLIT SPROCKETS

Material: polyamide, screws in stainless steel, DIN 6885 key seat.

Notes: special shape of teeth compensates natural chain lengthening after prolonged use.

CODE	Z	C mm	H mm	S mm	DF mm
121810A					18*
121811A					25
121812A	21	129.0	129.26	67.8	30
121813A					35
121814A					40
121815A					18*
121816A					25
121817A	23	142.0	141.21	73.8	30
121818A					35
121819A					40
121820A					18*
121821A					25
121822A	25	154.0	153.21	79.8	30
121823A					35
121824A					40

* Plain Bore

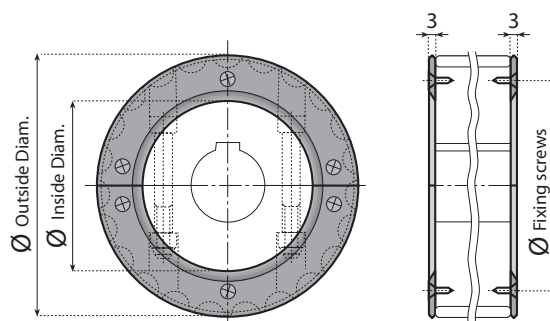

-  For chemical resistance see pages 336 - 337

GUIDE RINGS

Material: reinforced polyamide; screws in stainless steel.

Supply: 4 sectors and 12 screws.

CODE	Z	Ø Outside	Ø Inside	Ø Fixing screws
12790B				
12790N	21	129.25	79	104
12791B				
12791N	23	142	92	116
12792B				
12792N	25	154	104	128

SPROCKETS and IDLER WHEELS for series 8157 - 8857 M - 8157 VG - 8857 M VG



DRIVE SPROCKETS

Material: reinforced polyamide, screws in stainless steel, DIN 6885 key seat.



For tolerances and dimensions see pages 332 - 333



For chains type see pages 23 - 32 - 39 - 44



For chemical resistance see pages 336 - 337

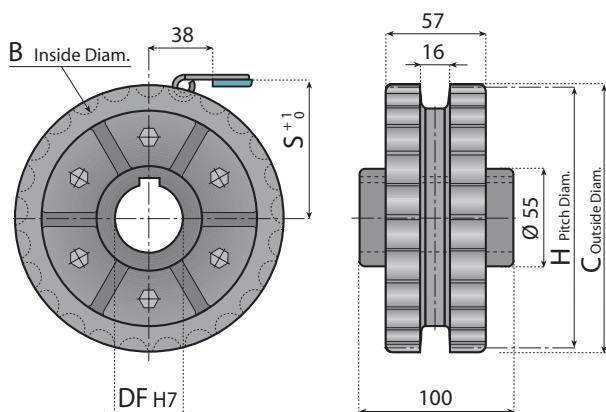

CODE	Z	B mm	C mm	H mm	S mm	DF mm
121920						25
121921	25	140.1	154	153.2	79.8	30
121922						35
121923						40



IDLER WHEELS

Material: self-lubricating polyamide, screws in stainless steel.



For tolerances and dimensions see pages 332 - 333



For chains type see pages 23 - 32 - 39 - 44



For chemical resistance see pages 336 - 337

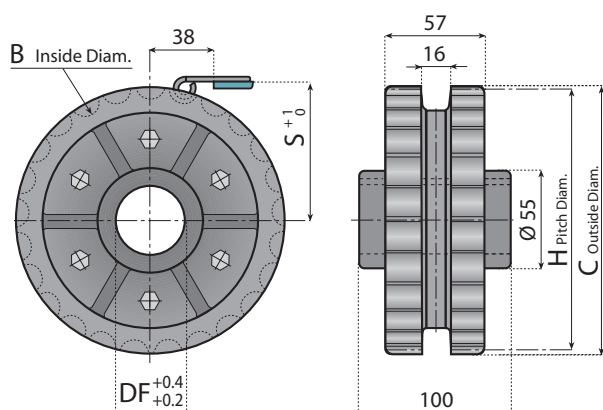

CODE	Z	B mm	C mm	H mm	S mm	DF mm
121924						25
121925	25	140.1	154	153.2	79.8	30
121926						35
121927						40

IDLER WHEELS for series 8157 - 8857 M - 8157 VG - 8857 M VG



Features:

- Excellent wear and chemical resistance.
- Reduced noise level and quiet operation
- Reinforced design.
- Completely closed structure, easier to clean and to disinfect
- Recyclable.
- Quickly replaceable.
- Convenient



For tolerances and dimensions see pages 332 - 333



For chains type see pages 23 - 32 - 39 - 44



For chemical resistance see pages 336 - 337

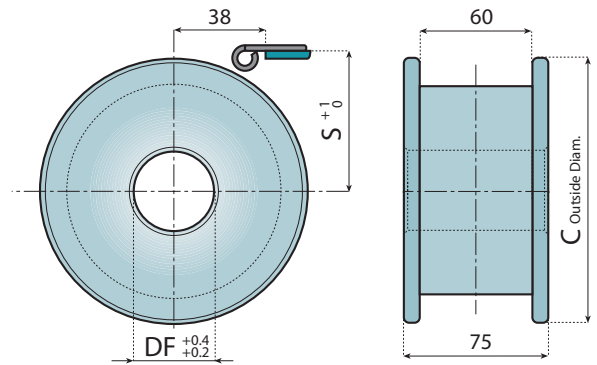
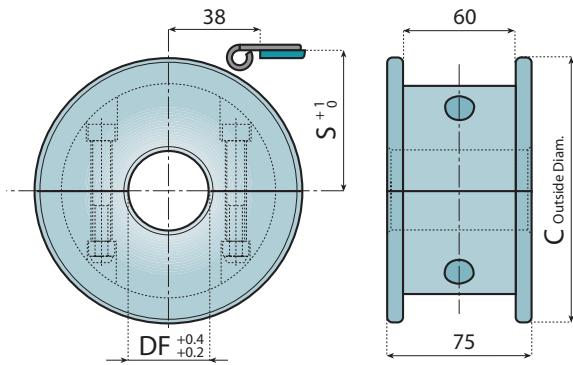

SPLIT IDLER WHEELS

Material: polyamide, screws in stainless steel.



STANDARD IDLER WHEELS

Material: polyamide.

CODE	Z equiv.	C mm	S mm	DF mm
121377	17	104.0	56.2	20
121378				25
121379				30
121380				35
121381				40
121382	19	117.0	62.6	20
121383				25
121384				30
121385				35
121386				40
121387	21	129.8	68.6	20
121388				25
121389				30
121390				35
121391				40
121392	23	142.2	74.6	20
121393				25
121394				30
121395				35
121396				40
121397	25	154.7	80.5	20
121398				25
121399				30
121400				35
121401				40
121402	27	167.2	86.5	20
121403				25
121404				30
121405				35
121406				40
121407	29	179.3	92.8	20
121408				25
121409				30
121410				35
121411				40

CODE	Z equiv.	C mm	S mm	DF mm
121412	17	104.0	56.2	20
121413				25
121414				30
121415				35
121416				40
121417	19	117.0	62.6	20
121418				25
121419				30
121420				35
121421				40
121422	21	129.8	68.6	20
121423				25
121424				30
121425				35
121426				40
121427	23	142.2	74.6	20
121428				25
121429				30
121430				35
121431				40
121432	25	154.7	80.5	20
121433				25
121434				30
121435				35
121436				40
121437	27	167.2	86.5	20
121438				25
121439				30
121440				35
121441				40
121442	29	179.3	92.8	20
121443				25
121444				30
121445				35
121446				40

IDLER WHEELS for series 8157 - 8857 M - 8157 VG - 8857 M VG



IDLER WHEELS

Material: self-lubricating polyamide,
screws in zinc plated steel.



For tolerances and
dimensions see
pages 332 - 333



For chains type see
pages
23 - 32 - 39 - 44



For chemical
resistance see
pages 336 - 337

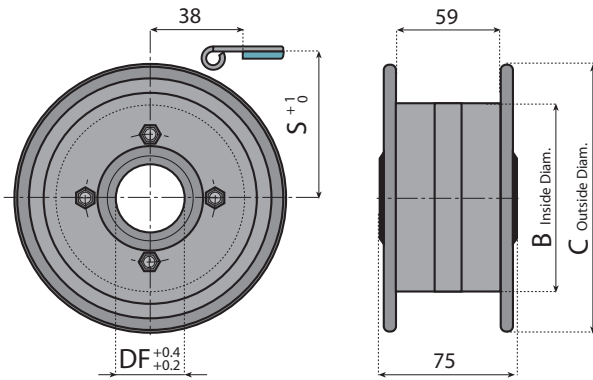

CODE	Z equiv.	B mm	C mm	S mm	DF mm
121600					25
121601					30
121602	19	80	118	62.6	35
121603					40
121604					25
121605					30
121606	21	80	129.8	68.6	35
121607					40
121608					25
121609					30
121610	23	108	142.5	74.6	35
121611					40
121612					25
121613					30
121614	25	108	155	80.5	35
121615					40

SPROCKETS for series 515



Features:

- Excellent wear and chemical resistance.
- Reduced noise level and quiet operation
- Reinforced design.
- Completely closed structure, easier to clean and to disinfect.
- The design of the sprocket ensures smooth running and long service life.
- Increased keyway strength.



For tolerances and dimensions see pages 332 - 333



For chains type see page 24



For chemical resistance see pages 336 - 337

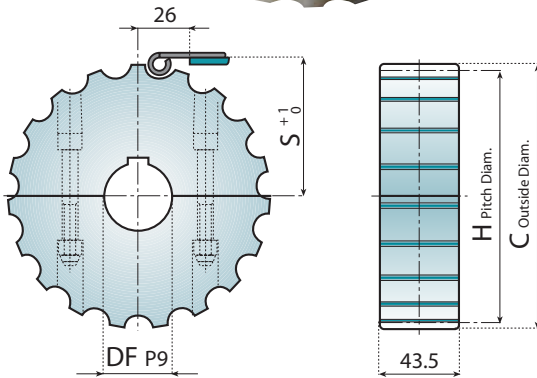

SPLIT SPROCKETS

Material: polyamide, screws in stainless steel, DIN 6885 key seat.

Notes: special shape of teeth compensates natural chain lengthening after prolonged use.

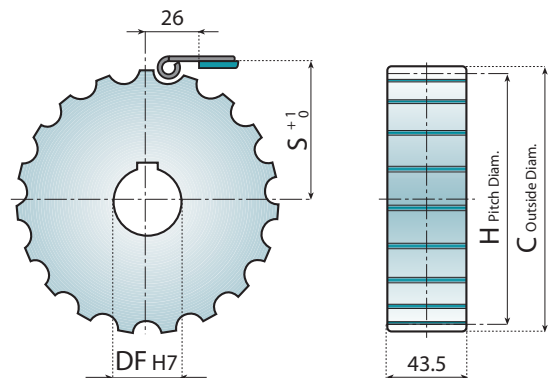

STANDARD SPROCKETS

Material: polyamide, DIN 6885 key seat.

Notes: special shape of teeth compensates natural chain lengthening after prolonged use.

CODE	Z	C mm	H mm	S mm	DF mm
121555	13	106.1	108.0	57.2	18*
121556					25
121557					30
121558					35
121559					40
121560	15	122.2	124.0	65.2	18*
121561					25
121562					30
121563					35
121564					40
121565	17	138.2	138.2	72.3	18*
121566					25
121567					30
121568					35
121569					40
121570	18	146.4	146.3	76.4	18*
121571					25
121572					30
121573					35
121574					40
121575	19	155.7	154.3	80.4	18*
121576					25
121577					30
121578					35
121579					40
121580	21	173.0	170.4	88.4	18*
121581					25
121582					30
121583					35
121584					40
121585	23	190.0	186.5	96.5	18*
121586					25
121587					30
121588					35
121589					40
121590	25	206.0	202.7	104.6	18*
121591					25
121592					30
121593					35
121594					40

CODE	Z	C mm	H mm	S mm	DF mm
121656	13	106.1	108.0	57.2	25
121657					30
121658					35
121659					40
121660					15
121661	30				
121662	35				
121663	40				
121664	17	138.2	138.2	72.3	
121665					30
121666					35
121667					40
121668					18
121669	30				
121670	35				
121671	40				
121672	19	155.7	154.3	80.4	
121673					30
121674					35
121675					40
121676					21
121677	30				
121678	35				
121679	40				
121680	23	190.0	186.5	96.5	
121681					30
121682					35
121683					40
121684					25
121685	30				
121686	35				
121687	40				

* Plain Bore

• Sprockets in material Steel on request.

IDLER WHEELS for series 515



Features:

- Excellent wear and chemical resistance.
- Reduced noise level and quiet operation
- Reinforced design.
- Completely closed structure, easier to clean and to disinfect.
- The design of the sprocket ensures smooth running and long service life.



For tolerances and dimensions see pages 332 - 333



For chains type see page 24



For chemical resistance see pages 336 - 337

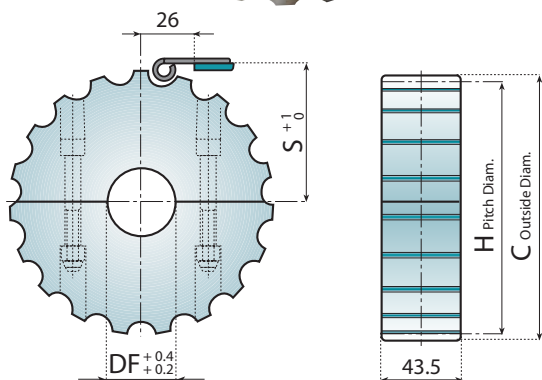

SPLIT IDLER WHEELS

Material: polyamide, screws in stainless steel.

Notes: special shape of teeth compensates natural chain lengthening after prolonged use.

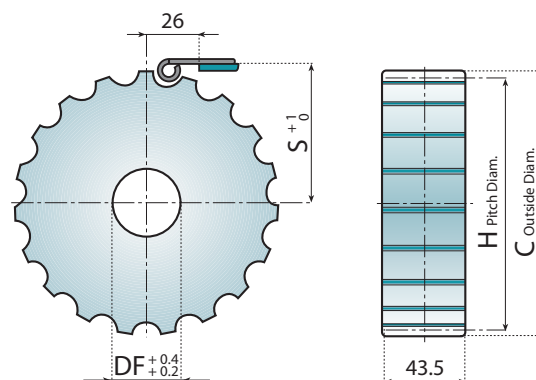

STANDARD IDLER WHEELS

Material: polyamide.

Notes: special shape of teeth compensates natural chain lengthening after prolonged use.

CODE	Z	C mm	H mm	S mm	DF mm
121688	13	106.1	108.0	57.2	25
121689					30
121690					35
121691					40
121692	15	122.2	124.0	65.2	25
121693					30
121694					35
121695					40
121696	17	138.2	138.2	72.3	25
121697					30
121698					35
121699					40
121700	18	146.4	146.3	76.4	25
121701					30
121702					35
121703					40
121704	19	155.7	154.3	80.4	25
121705					30
121706					35
121707					40
121708	21	173.0	170.4	88.4	25
121709					30
121710					35
121711					40
121712	23	190.0	186.5	96.5	25
121713					30
121714					35
121715					40
121716	25	206.0	202.7	104.6	25
121717					30
121718					35
121719					40

CODE	Z	C mm	H mm	S mm	DF mm
121720G	13	106.1	108.0	57.2	18*
121720					25
121721					30
121722					35
121723	40				
121724G	15	122.2	124.0	65.2	18*
121724					25
121725					30
121726					35
121727	40				
121728G	17	138.2	138.2	72.3	18*
121728					25
121729					30
121730					35
121731	40				
121732G	18	146.4	146.3	76.4	18*
121732					25
121733					30
121734					35
121735	40				
121736G	19	155.7	154.3	80.4	18*
121736					25
121737					30
121738					35
121739	40				
121740G	21	173.0	170.4	88.4	18*
121740					25
121741					30
121742					35
121743	40				
121744G	23	190.0	186.5	96.5	18*
121744					25
121745					30
121746					35
121747	40				
121748G	25	206.0	202.7	104.6	18*
121748					25
121749					30
121750					35
121751	40				

* Plain Bore

• Idler wheel in material Steel on request.