

SPROCKETS for series 828 - 878 TAB - 878 TAB VG - 879 879 TAB - 879 M - 879 M VG - 879 TAB VG - 880 - 880 TAB - 880 M



Features:

- Excellent wear and chemical resistance.
- Reduced noise level and quiet operation.
- Reinforced design.
- Completely closed structure, easier to clean and to disinfect.
- Increased keyway strength.
- Quickly replaceable.

 For tolerances and dimensions see pages 332 - 333

 For chains type see pages 47 - 54 → 57 80 → 82

 For chemical resistance see pages 336 - 337

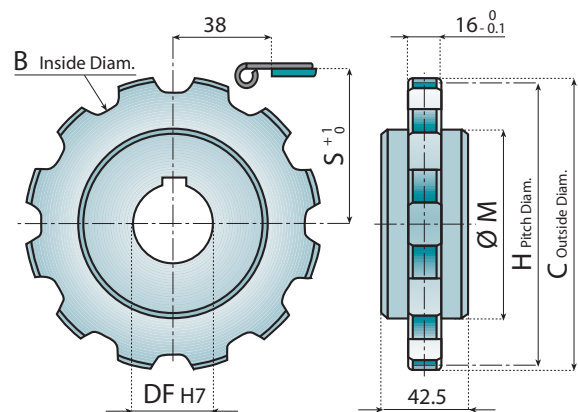
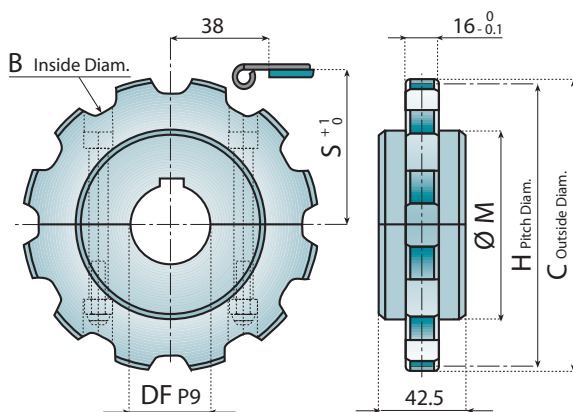

SPLIT SPROCKETS

Material: polyamide, screws in stainless steel, DIN 6885 key seat.

Notes: special shape of teeth compensates natural chain lengthening after prolonged use.



STANDARD SPROCKETS

Material: polyamide, DIN 6885 key seat.

Notes: special shape of teeth compensates natural chain lengthening after prolonged use.

CODE	Z	C mm	H mm	B mm	M mm	S mm	DF mm
12910							18*
12382							25
12383	9	110.0	111.4	95	75	59.30	30
12384							35
12385							40
12911							18*
12386							25
12387	10	122.0	123.3	107	85	65.25	30
12388							35
12389							40
12912							18*
12390							25
12391	11	135.0	135.2	119	90	71.20	30
12392							35
12393							40
12913							18*
12394							25
12395	12	147.3	147.2	131	95	77.20	30
12396							35
12397							40

CODE	Z	C mm	H mm	B mm	M mm	S mm	DF mm
12398							25
12399	9	110.0	111.4	95	75	59.30	30
12407							35
12408							40
12409							25
12410	10	122.0	123.3	107	85	65.25	30
12411							35
12412							40
12413							25
12414	11	135.0	135.2	119	90	71.20	30
12415							35
12416							40
12417							25
12418	12	147.3	147.2	131	95	77.20	30
12419							35
12420							40

* Plain Bore

IDLER WHEELS for series 828 - 878 TAB - 878 TAB VG - 879 879 TAB - 879 M - 879 M VG - 879 TAB VG - 880 - 880 TAB - 880 M



Features:

- Excellent wear and chemical resistance.
- Reduced noise level and quiet operation.
- Reinforced design.
- Completely closed structure, easier to clean and to disinfect.
- Recyclable.
- Quicly replaceable.

 For tolerances and dimensions see pages 332 - 333

 For chains type see pages 47 - 54 → 57
80 → 82

 For chemical resistance see pages 336 - 337

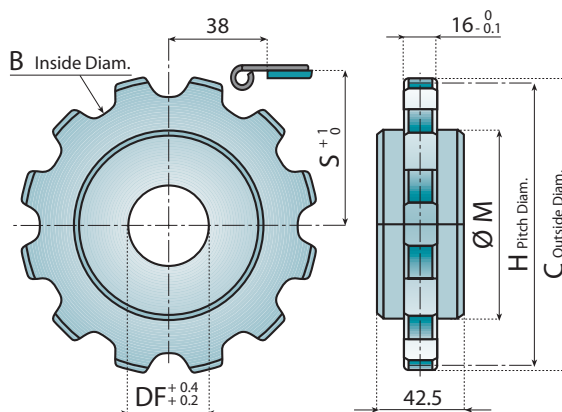
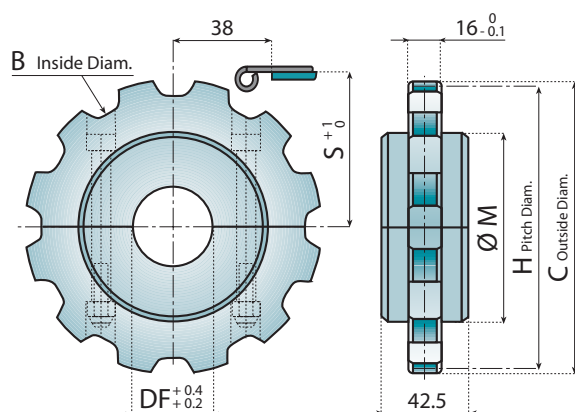

SPLIT IDLER WHEELS

Material: polyamide, screws in stainless steel.
Notes: special shape of teeth compensates natural chain lengthening after prolonged use.



STANDARD IDLER WHEELS

Material: polyamide.
Notes: special shape of teeth compensates natural chain lengthening after prolonged use.

CODE	Z	C mm	H mm	B mm	M mm	S mm	DF mm
121752							25
121753	9	110.0	111.4	95	75	59.30	30
121754							35
121755							40
121756							25
121757	10	122.0	123.3	107	85	65.25	30
121758							35
121759							40
121760							25
121761	11	135.0	135.2	119	90	71.20	30
121762							35
121763							40
121764							25
121765	12	147.3	147.2	131	95	77.20	30
121766							35
121767							40

CODE	Z	C mm	H mm	B mm	M mm	S mm	DF mm
12421G							18*
12421	9	110.0	111.4	95	75	59.30	25
12422							30
12423							35
12424							40
12425G							18*
12425	10	122.0	123.3	107	85	65.25	25
12426							30
12427							35
12428							40
12429G							18*
12429	11	135.0	135.2	119	90	71.20	25
12430							30
12431							35
12432							40
12433G							18*
12433	12	147.3	147.2	131	95	77.20	25
12434							30
12435							35
12436							40

* Plain Bore

SPROCKETS and IDLER WHEELS for series 828 - 878 TAB

878 TAB VG - 879 - 879 TAB - 879 M - 879 M VG - 879 TAB VG - 880 - 880 TAB - 880 M



SPLIT SPROCKETS

Material: reinforced polyamide, screws in stainless steel, nuts in nickel plated brass, DIN 6885 key seat.



For tolerances and dimensions see pages 332 - 333



For chains type see pages 47 - 54 → 57 80 → 82



For chemical resistance see pages 336 - 337

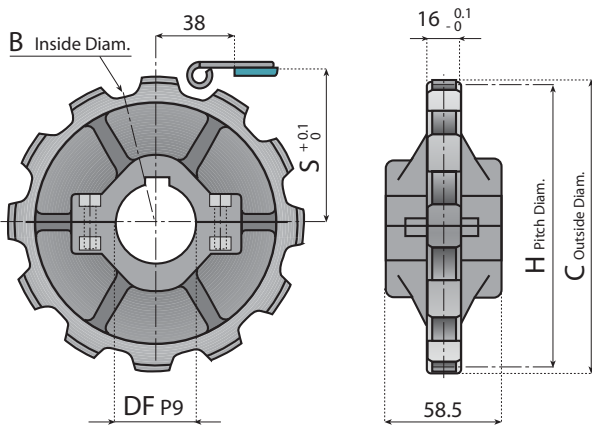

CODE	Z	B mm	C mm	H mm	S mm	DF mm
121001	10	107	122	123.3	65.25	25
121002						30
121003						35
121004						40
12400	12	131	147	146.8	77.20	25
12711						30
12401						35
12402						40



SPLIT IDLER WHEELS

Material: polyamide, screws in stainless steel, nut in nickel plated brass.



For tolerances and dimensions see pages 332 - 333



For chains type see pages 47 - 54 → 57 80 → 82



For chemical resistance see pages 336 - 337

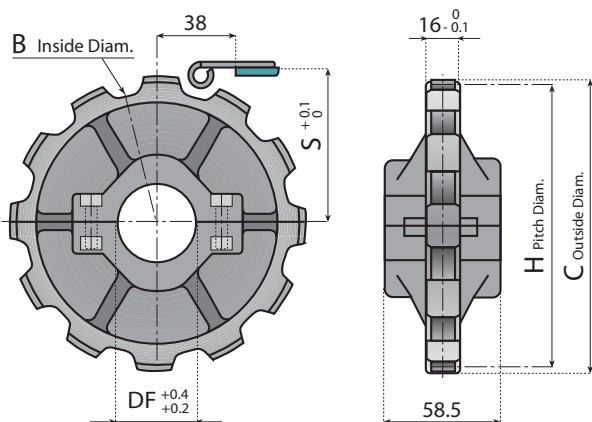



CODE	Z	B mm	C mm	H mm	S mm	DF mm
121005	10	107	122	123.3	65.25	25
121006						30
121007						35
121008						40
12403	12	131	147	146.8	77.20	25
12404						30
12405						35
12406						40

IDLER WHEELS for series 828 - 879 - 879 M - 880 M VG - 880 - 880 M



 For tolerances and dimensions see pages 332 - 333

 For chains type see pages 47 - 54 - 57 - 82

 For chemical resistance see pages 336 - 337

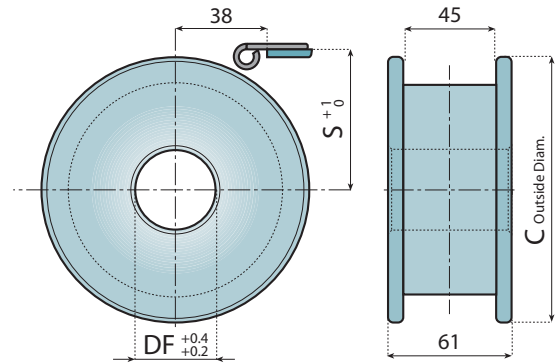
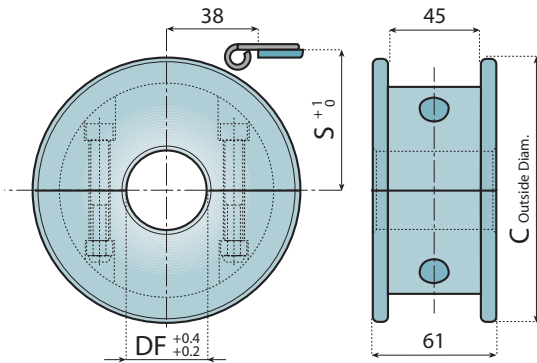

Features:

- Excellent wear and chemical resistance.
- Reduced noise level, quiet operation.
- Reinforced design.
- Completely closed structure, easier to clean and to disinfect.
- Recyclable.
- Quickly replaceable.

Features:

- Excellent wear and chemical resistance.
- Reduced noise level, quiet operation.
- Reinforced execution.
- Completely closed structure, easier to clean and to disinfect.
- Recyclable.
- Convenient.



SPLIT IDLER WHEELS

Material: polyamide, screws in stainless steel.



STANDARD IDLER WHEELS

Material: polyamide.

CODE	Z equiv.	C mm	S mm	DF mm
12613				20
12614				25
12615	9	117.0	62.6	30
12616				35
12618				40
12617				20
12619				25
12620	10	129.8	68.6	30
12621				35
12622				40
12623				20
12624				25
12625	11	142.2	74.6	30
12626				35
12627				40
12628				20
12629				25
12630	12	154.7	80.5	30
12631				35
12632				40

CODE	Z equiv.	C mm	S mm	DF mm
12638				20
12639				25
12640	9	117.0	62.6	30
12641				35
12642				40
12643				20
12644				25
12645	10	129.8	68.6	30
12646				35
12647				40
12648				20
12649				25
12650	11	142.2	74.6	30
12651				35
12652				40
12653				20
12654				25
12655	12	154.7	80.5	30
12656				35
12657				40

IDLER WHEELS for series

878 TAB - 878 TAB VG - 879 TAB - 879 TAB VG - 880 TAB



 For tolerances and dimensions see pages 332 - 333

 For chains type see pages 55 - 56 - 80 - 81

 For chemical resistance see pages 336 - 337

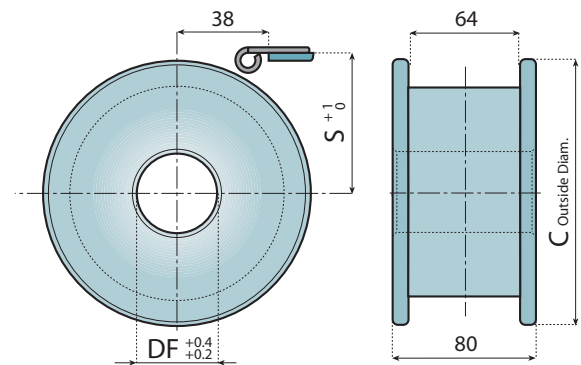
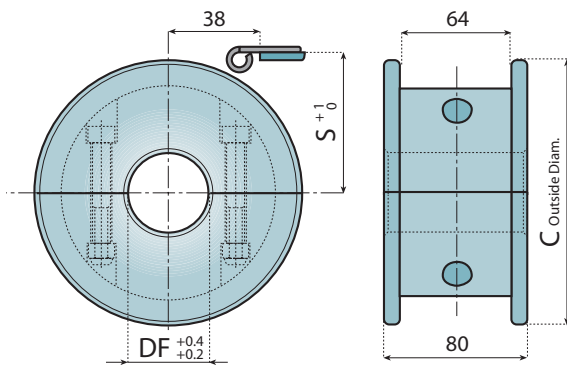

Features:

- Excellent wear and chemical resistance.
- Reduced noise level and quiet operation.
- Reinforced design.
- Completely closed structure, easier to clean and to disinfect.
- Recyclable.
- Quickly replaceable.

Features:

- Excellent wear and chemical resistance.
- Reduced noise level and quiet operation.
- Reinforced design.
- Completely closed structure, easier to clean and to disinfect.
- Recyclable.
- Convenient.



SPLIT IDLER WHEELS

Material: polyamide, screws in stainless steel.



STANDARD IDLER WHEELS

Material: polyamide.

CODE	Z equiv.	C mm	S mm	DF mm
121447	9	117.0	62.1	20
121448				25
121449				30
121450				35
121451				40
121452	10	129.8	68.5	20
121453				25
121454				30
121455				35
121456				40
121457	11	142.2	74.7	20
121458				25
121459				30
121460				35
121461				40
121462	12	154.7	80.9	20
121463				25
121464				30
121465				35
121466				40

CODE	Z equiv.	C mm	S mm	DF mm
121467	9	117.0	62.1	20
121468				25
121469				30
121470				35
121471				40
121472	10	129.8	68.5	20
121473				25
121474				30
121475				35
121476				40
121477	11	142.2	74.7	20
121478				25
121479				30
121480				35
121481				40
121482	12	154.7	80.9	20
121483				25
121484				30
121485				35
121486				40

IDLER WHEELS



IDLER WHEELS

Material: self-lubricating polyamide, screws in zinc plated steel.

Application: chains series
879 - 879 M - 879 M VG - 880 - 880 M



For tolerances and dimensions see pages 332 - 333



For chains type see pages 55 - 56 - 80 - 81



For chemical resistance see pages 336 - 337

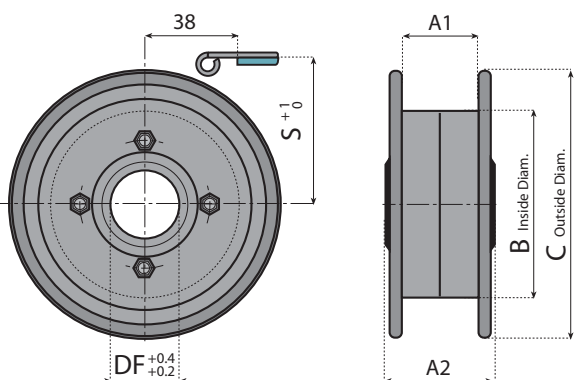

CODE	Z equiv.	A1 mm	A2 mm	B mm	C mm	S mm	DF mm
12278	8	44	52	71	106	56.2	25
12279							30
12680	9	44	60	80	118	62.6	25
12681							30
12682							35
12683							40
12684	10	44	60	80	129.8	68.6	25
12685							30
12686							35
12687							40
12688							25
12689	11	44	60	108	142.5	74.6	30
12690							35
12691							40
12692							25
12693	12	44	60	108	155	80.5	30
12694							35
12695							40



IDLER WHEELS

Material: self-lubricating polyamide, screws in zinc plated steel.

Application: chains series
878 TAB - 878 TAB VG - 879 TAB
879 TAB VG - 880 TAB



For tolerances and dimensions see pages 332 - 333



For chains type see pages 55 - 56 - 80 - 81



For chemical resistance see pages 336 - 337

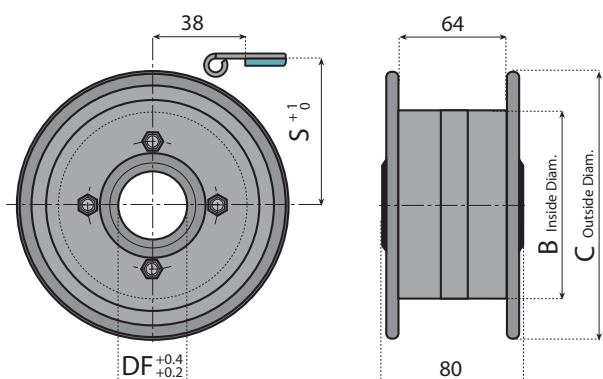

CODE	Z equiv.	B mm	C mm	S mm	DF mm
12310	9	80	118	62.6	25
12311					30
12312					35
12313					40
12314	10	80	129.8	68.6	25
12315					30
12316					35
12317					40
12318					25
12319	11	108	142.5	74.6	30
12320					35
12321					40
12322					25
12323	12	108	155	80.5	30
12324					35
12325					40

SPROCKETS

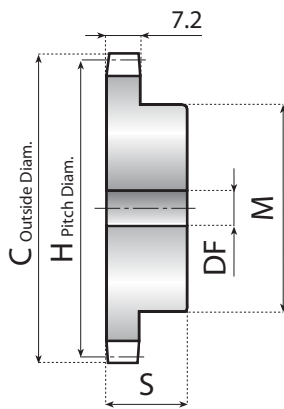

ANSI - STANDARD SPROCKETS

Material: C 45 steel.

Application: chains series
843 - 1843



For tolerances and dimensions see pages 332 - 333



For chains type see pages 96 - 100



For chemical resistance see pages 336 - 337

CODE	Z	C mm	H mm	M mm	S mm	DF mm
12001A	13	57.4	53.0	37	28	10
12002A	15	65.5	61.09	45	28	10
12003A	17	73.6	69.11	52	28	10
12004A	19	81.7	77.16	60	28	12
12005A	21	89.7	85.22	68	28	12
12006A	23	98.2	93.27	70	28	12
12007A	25	105.8	101.33	70	28	12
12008A	27	114.0	109.40	70	28	15
12009A	29	122.0	117.46	80	30	15
12010A	31	130.2	125.54	90	30	16
12011A	33	138.4	133.60	90	30	16

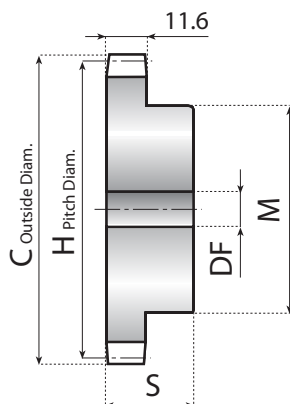

ANSI - STANDARD SPROCKETS

Material: C 45 steel.

Application: chains series
863 - 1863 - 1873 - 1874



For tolerances and dimensions see pages 332 - 333



For chains type see pages 33 - 85 → 93
101 → 103



For chemical resistance see pages 336 - 337

CODE	Z	C mm	H mm	M mm	S mm	DF mm
12012A	15	99.8	91.63	70	35	14
12013A	17	111.5	103.67	80	35	16
12014A	19	124.2	115.75	80	35	16
12015A	21	136.0	127.82	90	40	20
12016A	23	149.0	139.90	90	40	20
12017A	25	160.0	152.00	90	40	20
12018A	27	172.3	164.09	95	40	20
12019A	29	184.1	176.19	95	40	20
12020A	31	196.3	188.31	100	40	25

DRIVE AND IDLER DISK for sideflexing chains

878 TAB

TANGENTIAL SPROCKETS Z32

Plain bore $\varnothing 18$

Material: polyamide.

Colour: black.

CODE

12817



For chains type see pages 56 - 74 - 80



For chemical resistance see pages 336 - 337

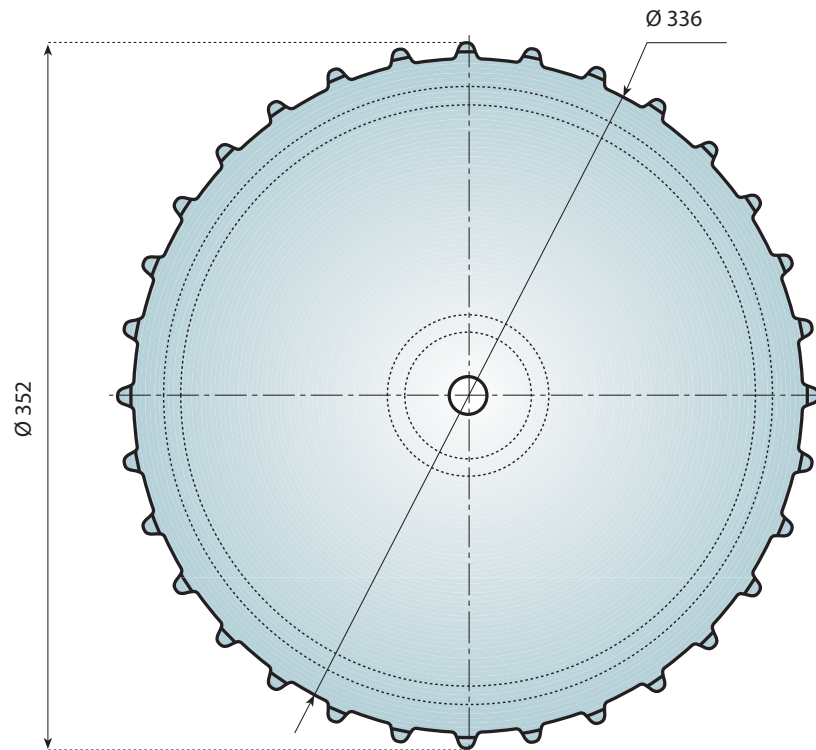
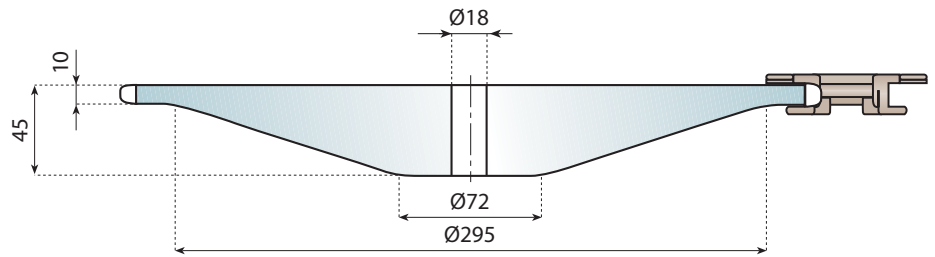

TURNING DISK

Plain bore $\varnothing 18$

Material: polyamide.

Colour: black.

CODE

12802

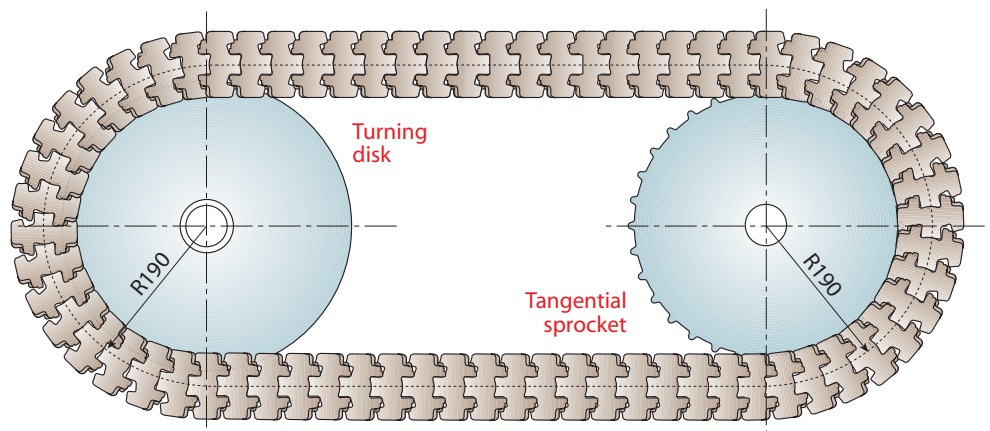
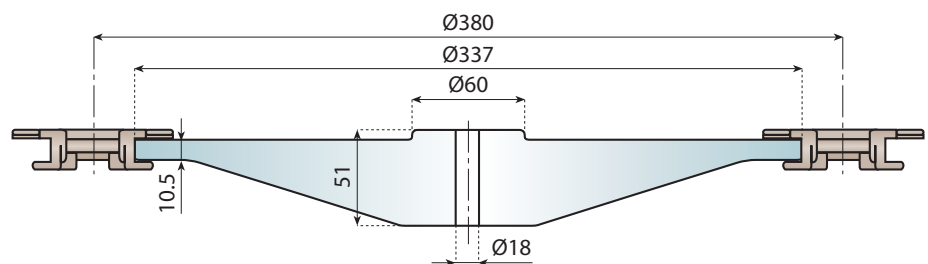

The use of tangential sprockets and for turning disks makes possible the design of compact conveying systems with a great number of curves.

It becomes easy realise rings either on the same plane or staggered, upgrading or downgrading runs.

TURNING DISK for sideflexing chains

881 R TAB - 878 TAB

TURNING DISK CLOSED VERSION CARRY and RETURN

Material: polyamide
Colour: black

CODE

12813

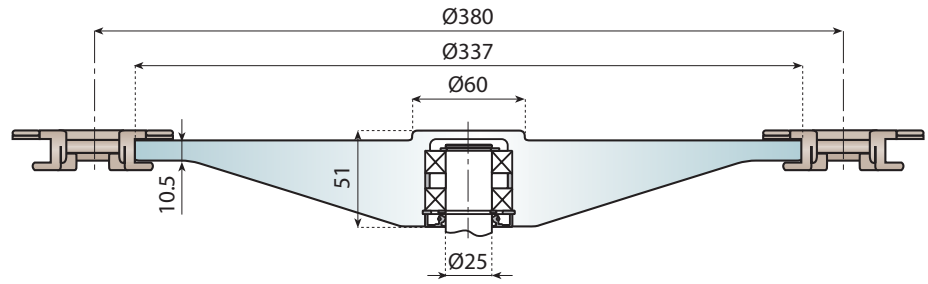

TURNING DISK OPEN VERSION CARRY and RETURN

Material: polyamide
Colour: black

CODE

12814

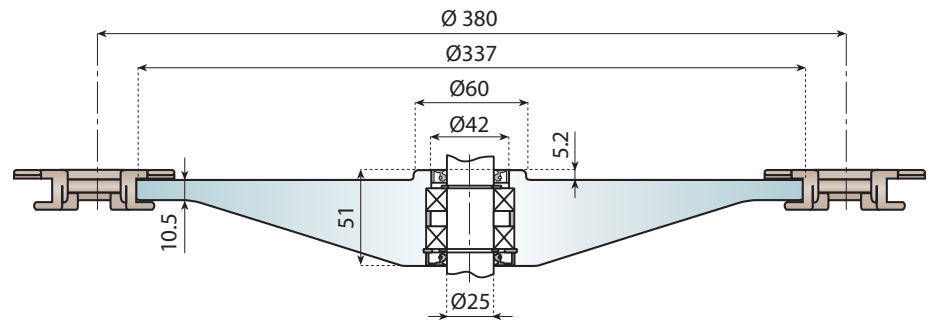

COMPONENTS

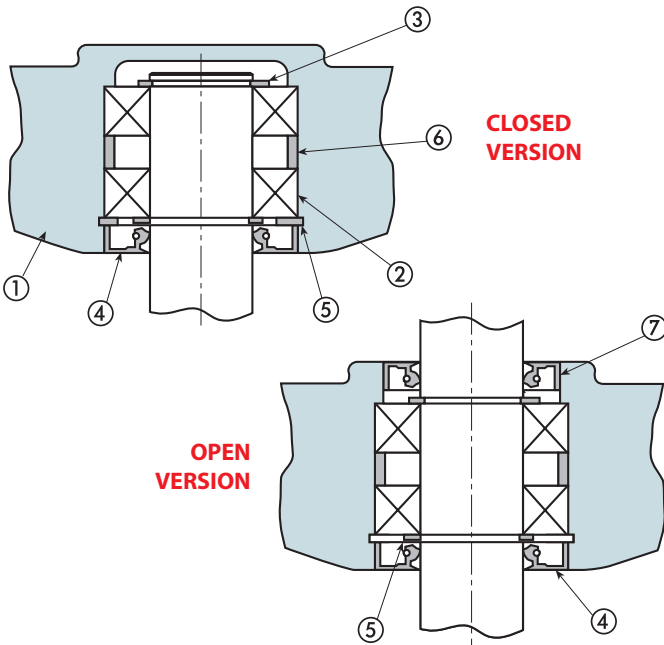

CLOSED VERSION

OPEN VERSION

- 1 - Turning disk.
- 2 - Single race radial ball bearing with two sliding seals, type 6005-2RS (25x47x12).
- 3 - External (reatining) ring, Ø 25 DIN 471.
- 4 - Seal ring with dust cover, 25x47x7 DIN 3760 (NBR rubber).
- 5 - Internal (reatining) ring, Ø 47 DIN 472.
- 6 - Bearing spacer.
- 7 - Seal ring with dust cover, 25x42x7 DIN 3760 (NBR rubber).

SHAFT DIMENSIONS

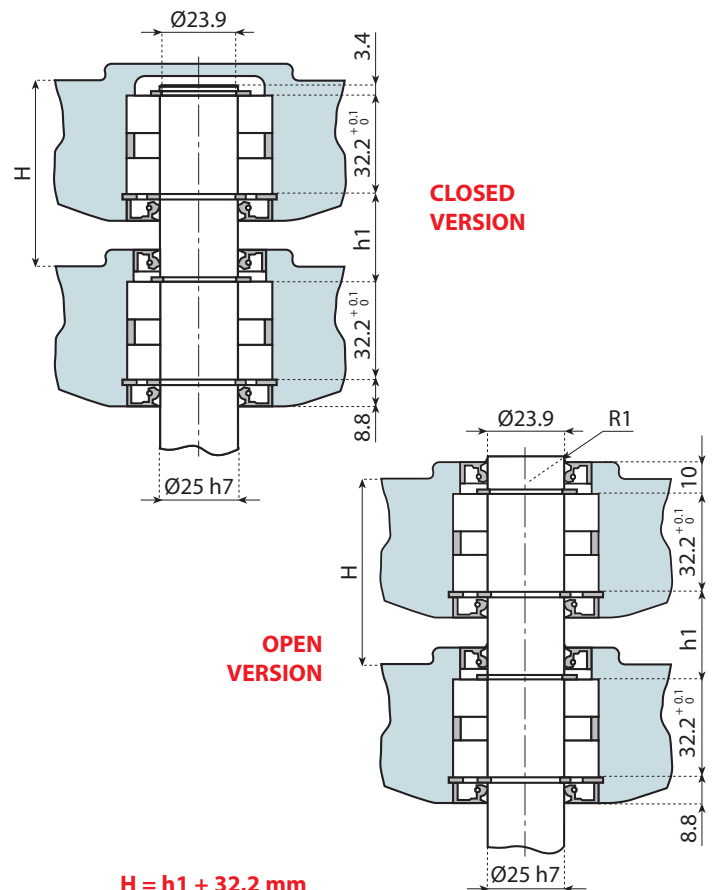

CLOSED VERSION

OPEN VERSION

$$H = h1 + 32,2 \text{ mm}$$

All components are supplied separate, except the shaft bearings which are pre-assembled.

TURNING DISKS for multiflex chains series

1700 - HMGK 50 FN - 7000 - 7001 - 7005



For chains type see pages 106 → 116



For chemical resistance see pages 336 - 337

TURNING DISK - Closed version

Material: polyamide
Colour: black

CODE	CARRY
12805	

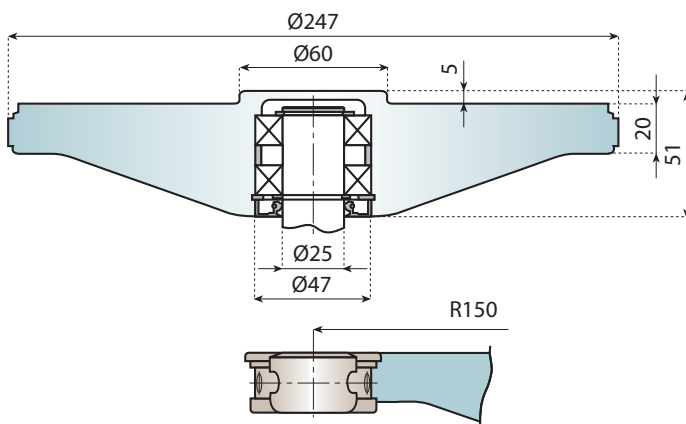

TURNING DISK - Closed version

Material: polyamide
Colour: black

CODE	RETURN
12806	

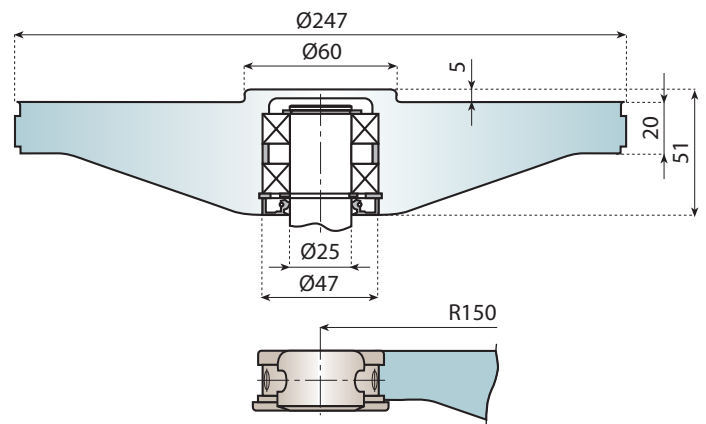

TURNING DISK - Open version

Material: polyamide
Colour: black

CODE	CARRY
12807	

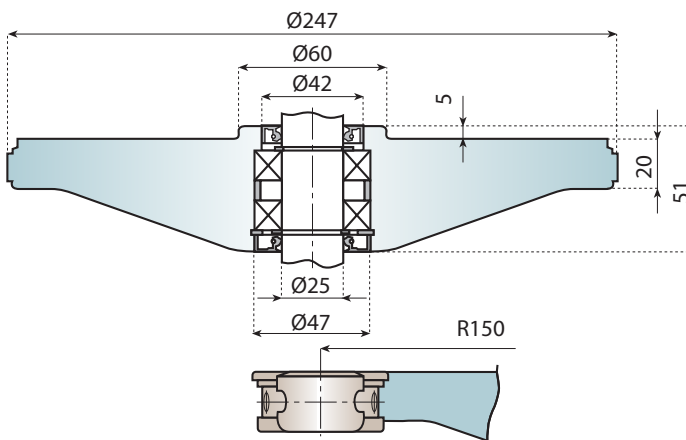

TURNING DISK - Open version

Material: polyamide
Colour: black

CODE	RETURN
12808	

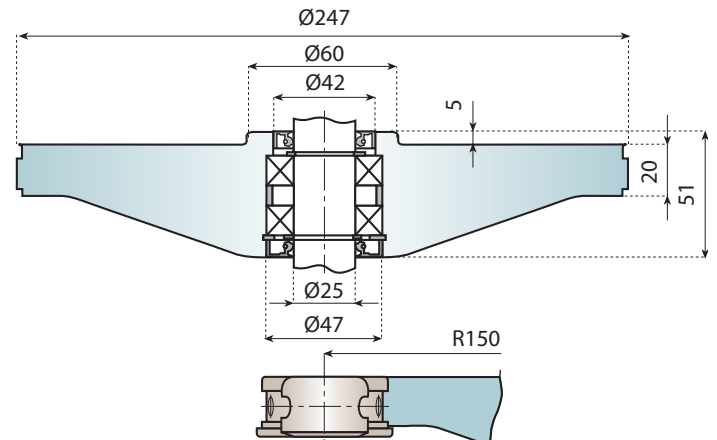

All components are supplied separate, except the shaft bearings which are pre-assembled.

TURNING DISKS for multiflex chains series

1701 TAB - 1701 TAB OP - 7000 TAB - 7001 TAB - 7005 TAB



 For chains type see pages 106 → 116

 For chemical resistance see pages 336 - 337

TURNING DISK - Closed version

Material: polyamide
Colour: black

CODE	CARRY
12809	

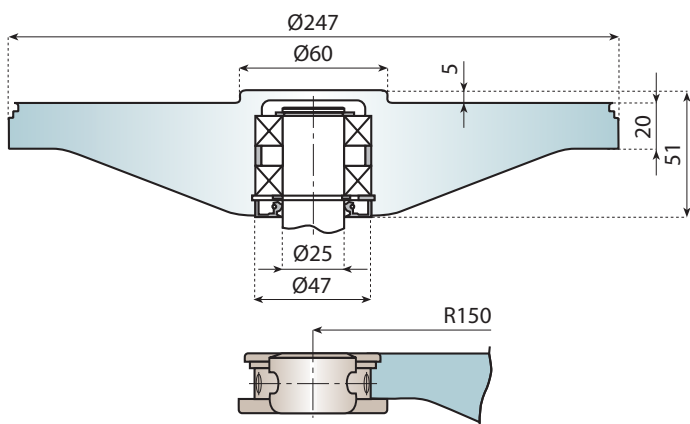

TURNING DISK - Closed version

Material: polyamide
Colour: black

CODE	RETURN
12810	

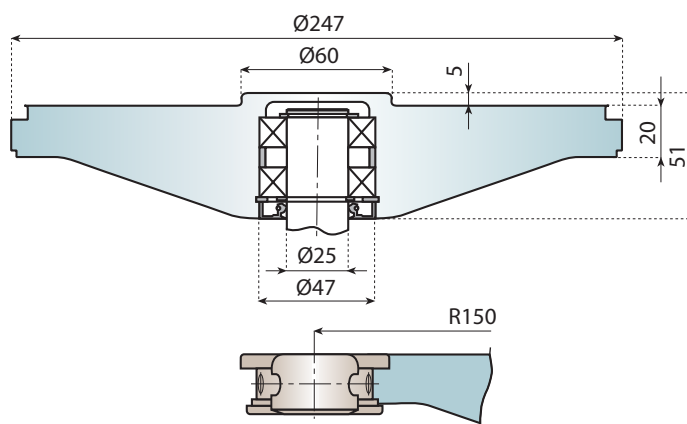

TURNING DISK - Open version

Material: polyamide
Colour: black

CODE	CARRY
12811	

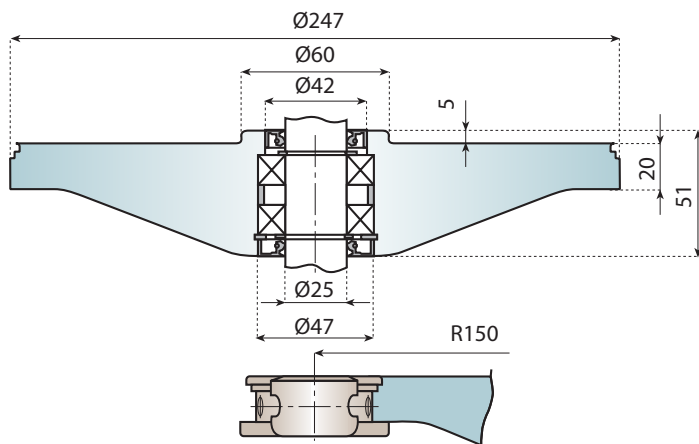

TURNING DISK - Open version

Material: polyamide
Colour: black

CODE	RETURN
12812	

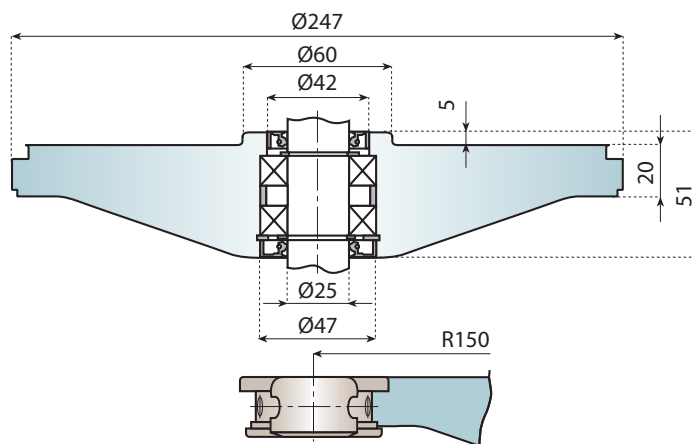

All components are supplied separate, except the shaft bearings which are pre-assembled.

TURNING DISK for multiflex chains series HMGK 50 TAB M - HMGK 50 TAB H1



For chains type see pages 106 → 116



For chemical resistance see pages 336 - 337

TURNING DISK for chains series HMGK 50 TAB M Closed version

Material: polyamide
Colour: black

CODE	CARRY AND RETURN
12795	

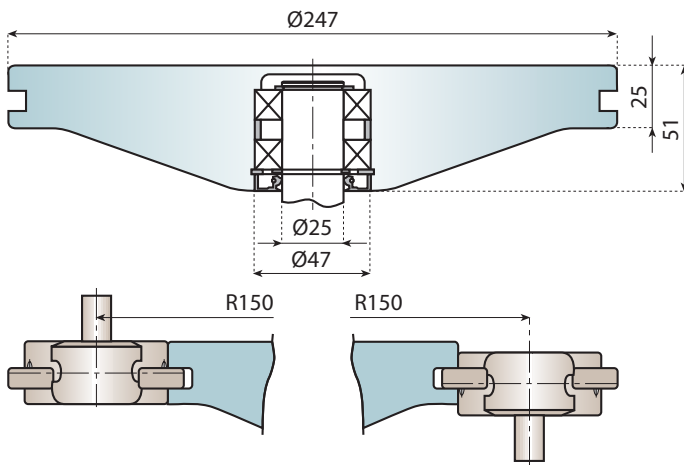

TURNING DISK for chains series HMGK 50 TAB M Open version

Material: polyamide
Colour: black

CARRY AND RETURN	CODE
	12796

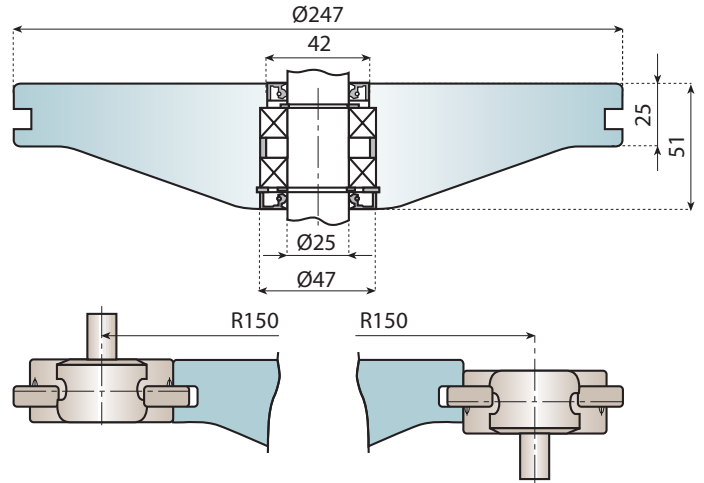

TURNING DISK for chains series HMGK 50 TAB H1 Closed version

Material: polyamide
Colour: black

CODE	CARRY AND RETURN
12793	

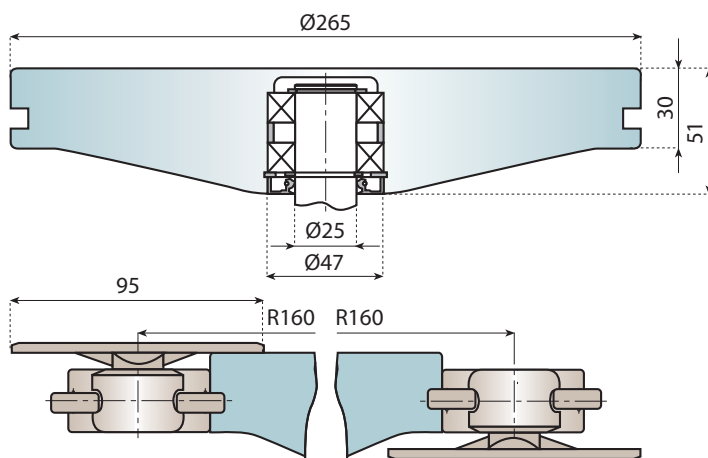

TURNING DISK for chains HMGK 50 TAB H1 Open version

Material: polyamide
Colour: black

CARRY AND RETURN	CODE
	12794

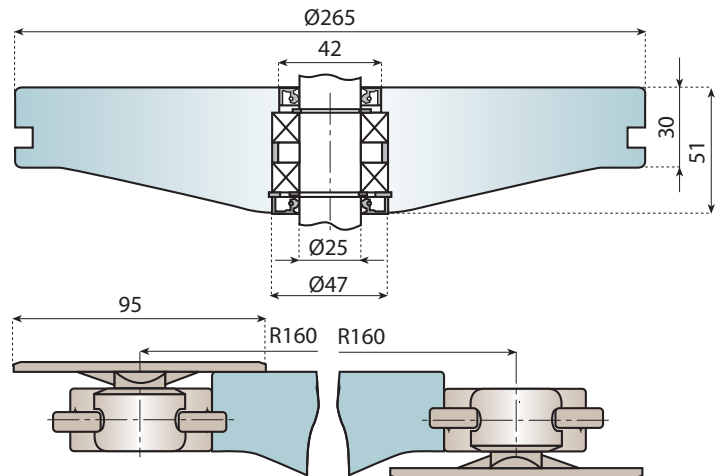

All components are supplied separate, except the shaft bearings which are pre-assembled.

TURNING DISK for multiflex chains series

1700 - 1702 - HMGK 50 FN - 7000 - 7001 - 7005

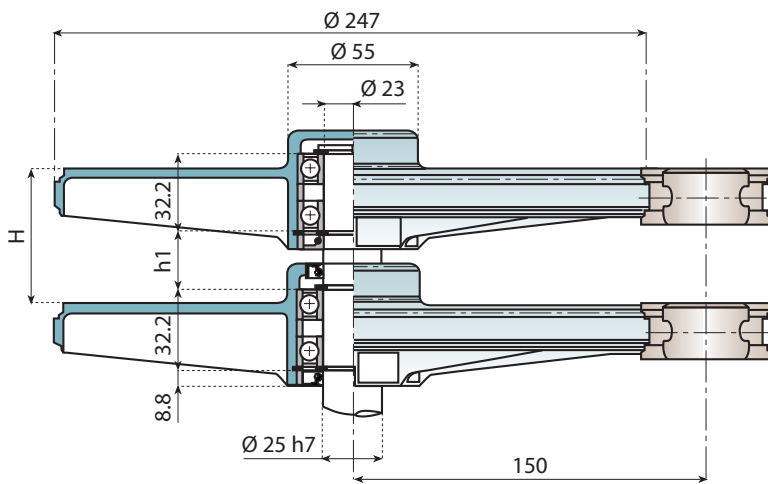

$H = h1 + 32,2 \text{ mm}$

Light and economic version



For chains type see pages 106 → 116



For chemical resistance see pages 336 - 337

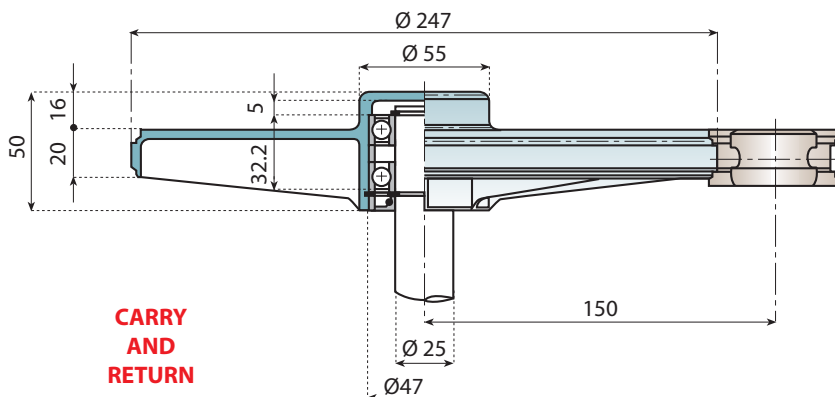

CARRY AND RETURN

TURNING DISK - Closed version

Material: polyamide reinforced with fiber-glass.
Colour: black.

CODE

12723

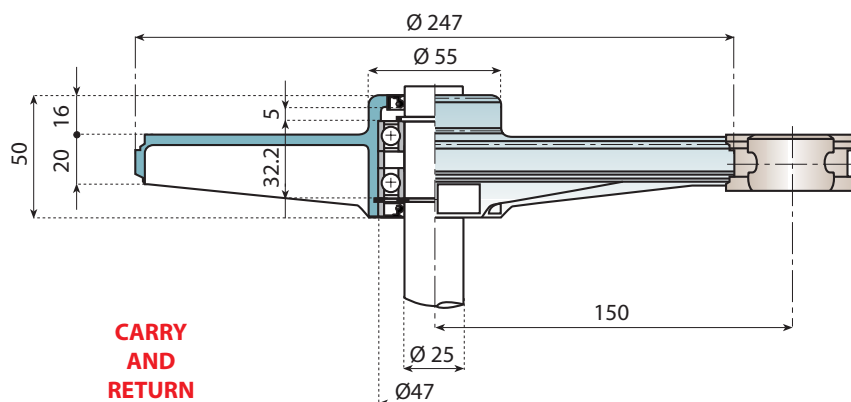

CARRY AND RETURN

TURNING DISK - Open version

Material: polyamide reinforced with fiber-glass.
Colour: black.

CODE

12725

All components are supplied separate, except the shaft bearings which are pre-assembled.

TURNING DISK for multiflex chains

Components and shaft dimensions

COMPONENTS

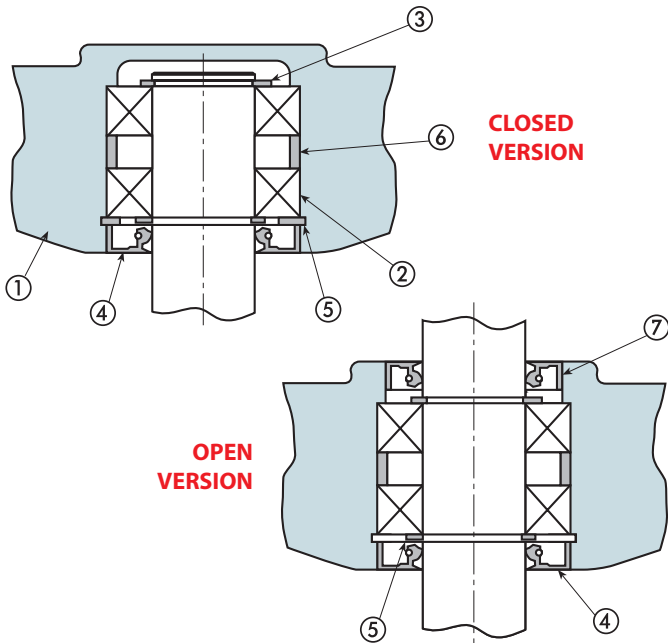

- 1 - Turning disk.
- 2 - Single race radial ball bearing with two sliding seals, type 6005-2RS (25x47x12).
- 3 - External (reatining) ring, $\varnothing 25$ DIN 471.
- 4 - Seal ring with dust cover, 25x47x7 DIN 3760 (NBR rubber).
- 5 - Internal (reatining) ring, $\varnothing 47$ DIN 472.
- 6 - Bearing spacer.
- 7 - Seal ring with dust cover, 25x42x7 DIN 3760 (NBR rubber).

SHAFT DIMENSIONS

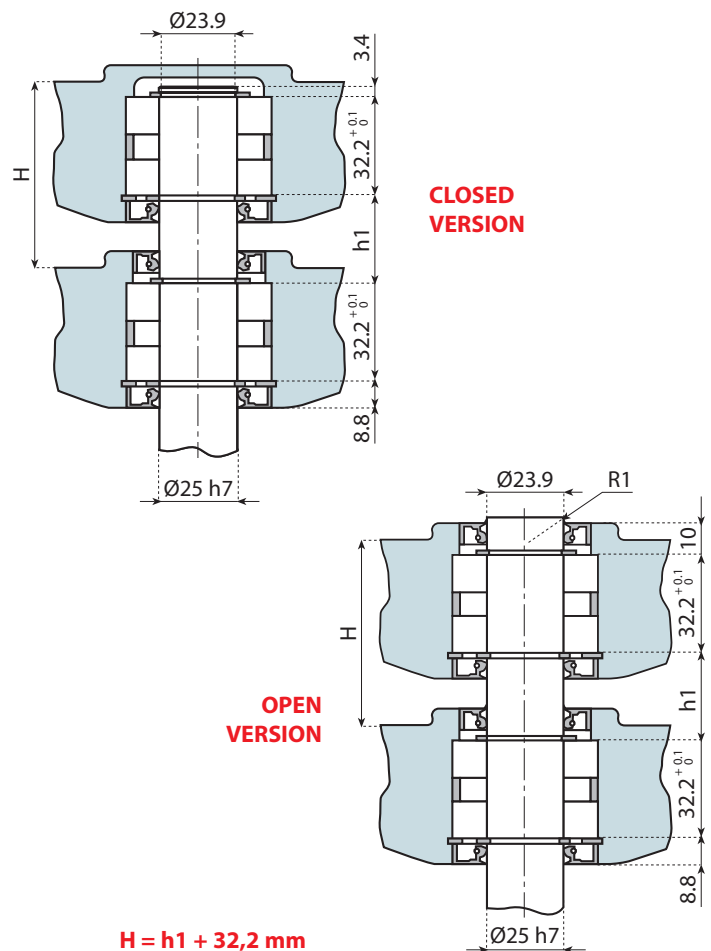

All components are supplied separate, except the shaft bearings which are pre-assembled.