

Guide for side bracket selection

Technical information

SIDE BRACKETS WITH EYEBOLT

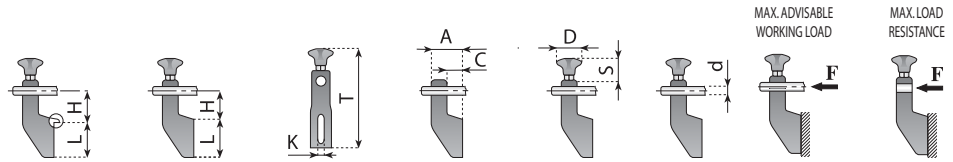

CATALOG

Code	L	H	L	H	K	T	A	C	D	S	ROD	N (Newton)	N (Newton)	Page
13692	71	65.5	-	-	9	195	62.5	35	50	45	Ø 12	2000	4000	193
13696	71	65.5	-	-	10.5	195	62.5	35	50	45	Ø 12	2000	4000	193
13853	71	65.5	-	-	9	196	62.5	35	50	42	Ø 12	2000	4000	192
13855	71	65.5	-	-	10.5	196	62.5	35	50	42	Ø 12	2000	4000	192
13858	71	65.5	-	-	9	188	62.5	35	50	34	Ø 12	2000	4000	192
13860	71	65.5	-	-	10.5	188	62.5	35	50	34	Ø 12	2000	4000	192
13863	71	65.5	-	-	9	212	62.5	35	50	58	Ø 12	2000	4000	193
13865	71	65.5	-	-	10.5	212	62.5	35	50	58	Ø 12	2000	4000	193
13632	71	65.5	-	-	9	172	62.5	35	NUT	NUT	Ø 12	2000	4000	192
13634	71	65.5	-	-	10.5	172	62.5	35	NUT	NUT	Ø 12	2000	4000	192
13208	71	65.5	-	-	10.5	198	62.5	35	65	44	Ø 14	3000	4000	193
13693	71	65.5	-	-	9	195	62.5	35	50	45	Ø 14	3000	4000	193
13697	71	65.5	-	-	10.5	195	62.5	35	50	45	Ø 14	3000	4000	193
13854	71	65.5	-	-	9	196	62.5	35	50	42	Ø 14	3000	4000	192
13856	71	65.5	-	-	10.5	196	62.5	35	50	42	Ø 14	3000	4000	192
13859	71	65.5	-	-	9	188	62.5	35	50	34	Ø 14	3000	4000	192
13861	71	65.5	-	-	10.5	188	62.5	35	50	34	Ø 14	3000	4000	192
13864	71	65.5	-	-	9	212	62.5	35	50	58	Ø 14	3000	4000	193
13866	71	65.5	-	-	10.5	212	62.5	35	50	58	Ø 14	3000	4000	193
13633	71	65.5	-	-	9	172	62.5	35	NUT	NUT	Ø 14	3000	4000	192
13635	71	65.5	-	-	10.5	172	62.5	35	NUT	NUT	Ø 14	3000	4000	192
13209	71	65.5	-	-	10.5	198	62.5	35	65	44	Ø 14	3000	4000	193
13769	71	65.5	-	-	10.5	195	62.5	35	50	45	Ø 14	3000	4000	193
13857	71	65.5	-	-	10.5	196	62.5	35	65	42	Ø 14	3000	4000	192
13862	71	65.5	-	-	10.5	188	62.5	35	65	34	Ø 14	3000	4000	192
13867	71	65.5	-	-	10.5	212	62.5	35	50	58	Ø 16	3000	4000	193
13210	71	65.5	-	-	10.5	198	62.5	35	65	44	Ø 16	3000	4000	193



Code	L	H	L	H	K	T	A	C	D	S	ROD	N (Newton)	N (Newton)	Page
13868	-	-	100	64	9	213	60	30	50	34	Ø 12	2200	4500	194
13871	-	-	100	64	10.5	213	60	30	50	34	Ø 12	2200	4500	194
13639	-	-	100	64	9	220	60	30	50	45	Ø 12	2200	4500	194
13641	-	-	100	64	10.5	220	60	30	50	45	Ø 12	2200	4500	194
13213	-	-	100	64	9	237	60	30	50	58	Ø 12	2200	4500	194
13215	-	-	100	64	10.5	237	60	30	50	58	Ø 12	2200	4500	194
13869	-	-	100	64	9	213	60	30	50	34	Ø 14	3200	4500	194
13872	-	-	100	64	10.5	213	60	30	50	34	Ø 14	3200	4500	194
13640	-	-	100	64	9	220	60	30	50	45	Ø 14	3200	4500	194
13642	-	-	100	64	10.5	220	60	30	50	45	Ø 14	3200	4500	194
13214	-	-	100	64	9	237	60	30	50	58	Ø 14	3200	4500	194
13216	-	-	100	64	10.5	237	60	30	50	58	Ø 14	3200	4500	194
13870	-	-	100	64	9	213	60	30	50	34	Ø 16	3400	4500	194
13873	-	-	100	64	10.5	213	60	30	50	34	Ø 16	3400	4500	194
13647	-	-	100	64	9	220	60	30	50	45	Ø 16	3400	4500	194
13648	-	-	100	64	10.5	220	60	30	50	45	Ø 16	3400	4500	194
13227	-	-	100	64	9	237	60	30	50	58	Ø 16	3400	4500	194
13228	-	-	100	64	10.5	237	60	30	50	58	Ø 16	3400	4500	194
13874	98	66	-	-	9	213	60	30	50	34	Ø 12	2200	4500	194
13877	98	66	-	-	10.5	213	60	30	50	34	Ø 12	2200	4500	194
13643	98	66	-	-	9	220	60	30	50	45	Ø 12	2200	4500	194
13645	98	66	-	-	10.5	220	60	30	50	45	Ø 12	2200	4500	194
13217	98	66	-	-	9	237	60	30	50	58	Ø 12	2200	4500	194
13219	98	66	-	-	10.5	237	60	30	50	58	Ø 12	2200	4500	194
13875	98	66	-	-	9	213	60	30	50	34	Ø 14	3200	4500	194
13878	98	66	-	-	10.5	213	60	30	50	34	Ø 14	3200	4500	194
13644	98	66	-	-	9	220	60	30	50	45	Ø 14	3200	4500	194
13646	98	66	-	-	10.5	220	60	30	50	45	Ø 14	3200	4500	194
13218	98	66	-	-	9	237	60	30	50	58	Ø 14	3200	4500	194
13220	98	66	-	-	10.5	237	60	30	50	58	Ø 14	3200	4500	194
13876	98	66	-	-	9	213	60	30	50	34	Ø 14	3400	4500	194
13879	98	66	-	-	10.5	213	60	30	50	34	Ø 16	3400	4500	194
13649	98	66	-	-	9	220	60	30	50	45	Ø 16	3400	4500	194
13650	98	66	-	-	10.5	220	60	30	50	45	Ø 16	3400	4500	194
13229	98	66	-	-	9	237	60	30	50	58	Ø 16	3400	4500	194
13230	98	66	-	-	10.5	237	60	30	50	58	Ø 16	3400	4500	194

Guide for side bracket selection

Technical information

SIDE BRACKETS WITH EYEBOLT

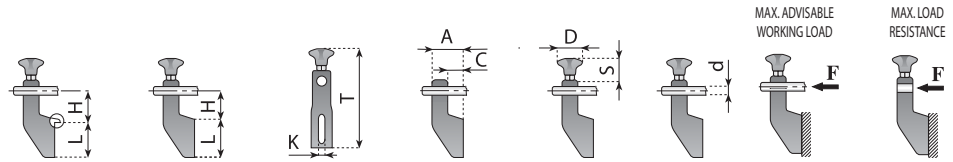

CATALOG

Code	L	H	L	H	K	T	A	C	D	S	ROD	N (Newton)	N (Newton)	Page
13880	-	-	100	87	9	242	79	30	50	34	Ø 12	2000	5000	195
13883	-	-	100	87	10.5	242	79	30	50	34	Ø 12	2000	5000	195
13326	-	-	100	87	9	249	79	30	50	45	Ø 12	2000	5000	195
13332	-	-	100	87	10.5	249	79	30	50	45	Ø 12	2000	5000	195
13221	-	-	100	87	9	268	79	30	50	58	Ø 12	2000	5000	195
13224	-	-	100	87	10.5	268	79	30	50	58	Ø 12	2000	5000	195
13881	-	-	100	87	9	242	79	30	50	34	Ø 14	3000	5000	195
13884	-	-	100	87	10.5	242	79	30	50	34	Ø 14	3000	5000	195
13327	-	-	100	87	9	249	79	30	50	45	Ø 14	3000	5000	195
13333	-	-	100	87	10.5	249	79	30	50	45	Ø 14	3000	5000	195
13222	-	-	100	87	9	268	79	30	50	58	Ø 14	3000	5000	195
13225	-	-	100	87	10.5	268	79	30	50	58	Ø 14	3000	5000	195
13882	-	-	100	87	9	242	79	30	50	34	Ø 16	3200	5000	195
13885	-	-	100	87	10.5	242	79	30	50	34	Ø 16	3200	5000	195
13328	-	-	100	87	9	249	79	30	50	45	Ø 16	3200	5000	195
13334	-	-	100	87	10.5	249	79	30	50	45	Ø 16	3200	5000	195
13223	-	-	100	87	9	268	79	30	50	58	Ø 16	3200	5000	195
13226	-	-	100	87	10.5	268	79	30	50	58	Ø 16	3200	5000	195



Code	L	H	L	H	K	T	A	C	D	S	ROD	N (Newton)	N (Newton)	Page
13211	45	65	-	-	10.5	171	60	30	50	45	Ø 12	2000	3000	191
13212	45	65	-	-	10.5	171	60	30	50	45	Ø 14	2000	3000	191
13764	75	35	-	-	9	164	62	27	50	45	Ø 12	2800	4500	191
13765	75	35	-	-	9	164	62	27	50	45	Ø 14	2800	4500	191
13851	75	35	-	-	9	157	62	27	50	34	Ø 12	2800	4500	191
13852	75	35	-	-	9	157	62	27	50	34	Ø 14	2800	4500	191



Code	L	H	L	H	K	T	A	C	D	S	ROD	N (Newton)	N (Newton)	Page
13895	-	-	112	77	10.5	252	80	30	50	32	Ø 12	2800	14000	206
13896	-	-	112	77	10.5	252	80	30	50	32	Ø 14	3600	14000	206
13897	-	-	112	77	10.5	252	80	30	50	32	Ø 16	3600	14000	206
13050	-	-	112	77	10.5	258	80	30	50	43	Ø 12	2800	14000	206
13051	-	-	112	77	10.5	258	80	30	50	43	Ø 14	3600	14000	206
13052	-	-	112	77	10.5	258	80	30	50	43	Ø 16	3600	14000	206
13205	-	-	102	115	9	286	79	35	50	56	Ø 12	3000	12000	206
13206	-	-	102	115	9	286	79	35	50	56	Ø 14	4000	12000	206
13207	-	-	102	115	9	286	79	35	50	56	Ø 16	4000	12000	206

BRACKETS WITH ECCENTRIC LEVER



Code	L	H	L	H	K	T	A	C	D	S	ROD	N (Newton)	N (Newton)	Page
13767	-	-	57	85	9	160	62	22	-	18	Ø 12	800	3000	190
13200	-	-	75	85	9	178	62	22	-	18	Ø 12	800	3000	190
13768	-	-	57	85	9	160	62	22	-	18	Ø 14	800	3000	190
13201	-	-	75	85	9	178	62	22	-	18	Ø 14	800	3000	190

Code	L	H	L	H	K	T	A	C	D	S	ROD	N (Newton)	N (Newton)	Page
13760	-	-	150	68	9	240	66	35	-	-	Ø 15	700	2800	190

Guide for side bracket selection - Technical information

ADJUSTABLE BRACKETS

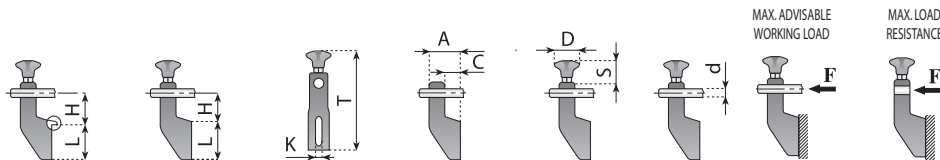

CATALOG

Code	L	H	L	H	K	T	A	C	D	S	ROD	N (Newton)	N (Newton)	Page
13271	-	-	109	67	10.5	201	65	27	-	-	Ø 12	2200	7500	198
13272	-	-	109	67	10.5	201	65	27	-	-	Ø 14	3000	7500	198
13273	-	-	109	67	10.5	201	65	27	-	-	Ø 16	3000	7500	198
131055	-	-	109	67	8.5	201	65	27	-	-	Ø 12	2200	7500	198
131056	-	-	109	67	8.5	201	65	27	-	-	Ø 14	3000	7500	198
131057	-	-	109	67	8.5	201	65	27	-	-	Ø 16	3000	7500	198
131030	-	-	109	67	8.5	201	82	44	-	-	Ø 12	2200	7500	196
131031	-	-	109	67	8.5	201	82	44	-	-	Ø 14	3000	7500	196
131032	-	-	109	67	8.5	201	82	44	-	-	Ø 16	3000	7500	196
13021	-	-	109	67	10.5	201	82	44	-	-	Ø 12	2200	7500	196
13088	-	-	109	67	10.5	201	82	44	-	-	Ø 14	3000	7500	196
13089	-	-	109	67	10.5	201	82	44	-	-	Ø 16	3000	7500	196
13530	-	-	100	70	10.5	194	85	43	-	-	Ø 12	2200	7500	200
13531	-	-	100	70	10.5	194	85	43	-	-	Ø 14	3000	7500	200
13532	-	-	100	70	10.5	194	85	43	-	-	Ø 16	3000	7500	200
13041	71	69	-	-	10.5	164	71	31	-	-	Ø 12	2200	8500	204
13042	71	69	-	-	10.5	164	71	31	-	-	Ø 14	3000	8500	204
13043	71	69	-	-	10.5	164	71	31	-	-	Ø 16	3000	8500	204
13580	95	75	-	-	10.5	194	85	43	-	-	Ø 12	2200	7500	202
13581	95	75	-	-	10.5	194	85	43	-	-	Ø 14	3000	7500	202
13582	95	75	-	-	10.5	194	85	43	-	-	Ø 16	3000	7500	202



Code	L	H	L	H	K	T	A	C	D	S	ROD	N (Newton)	N (Newton)	Page
13274	-	-	109	85	10.5	218	65	27	-	-	Ø 12	2200	7500	198
13275	-	-	109	85	10.5	218	65	27	-	-	Ø 14	3000	7500	198
13276	-	-	109	85	10.5	218	65	27	-	-	Ø 16	3000	7500	198
131058	-	-	109	85	8.5	218	65	27	-	-	Ø 12	2200	7500	198
131059	-	-	109	85	8.5	218	65	27	-	-	Ø 14	3000	7500	198
131060	-	-	109	85	8.5	218	65	27	-	-	Ø 16	3000	7500	198
131033	-	-	109	85	8.5	218	82	44	-	-	Ø 12	2200	7500	196
131034	-	-	109	85	8.5	218	82	44	-	-	Ø 14	3000	7500	196
131035	-	-	109	85	8.5	218	82	44	-	-	Ø 16	3000	7500	196
13847	-	-	109	85	10.5	218	82	44	-	-	Ø 12	2200	7500	196
13848	-	-	109	85	10.5	218	82	44	-	-	Ø 14	3000	7500	196
13849	-	-	109	85	10.5	218	82	44	-	-	Ø 16	3000	7500	196
13533	-	-	100	87	10.5	212	85	43	-	-	Ø 12	2200	7500	190
13534	-	-	100	87	10.5	212	85	43	-	-	Ø 14	3000	7500	190
13535	-	-	100	87	10.5	212	85	43	-	-	Ø 16	3000	7500	190
13889	71	87	-	-	10.5	182	71	31	-	-	Ø 12	2200	8500	204
13890	71	87	-	-	10.5	182	71	31	-	-	Ø 14	3000	8500	204
13891	71	87	-	-	10.5	182	71	31	-	-	Ø 16	3000	8500	204
13583	95	92.5	-	-	10.5	212	85	43	-	-	Ø 12	2200	7500	202
13584	95	92.5	-	-	10.5	212	85	43	-	-	Ø 14	3000	7500	202
13585	95	92.5	-	-	10.5	212	85	43	-	-	Ø 16	3000	7500	202



Code	L	H	L	H	K	T	A	C	D	S	ROD	N (Newton)	N (Newton)	Page
13277	-	-	109	67	10.5	240	65	27	50	42	Ø 12	2600	7500	199
13278	-	-	109	67	10.5	240	65	27	50	42	Ø 14	3500	7500	199
13279	-	-	109	67	10.5	240	65	27	50	42	Ø 16	3500	7500	199
131061	-	-	109	67	8.5	240	65	27	50	42	Ø 12	2600	7500	199
131062	-	-	109	67	8.5	240	65	27	50	42	Ø 14	3500	7500	199
131063	-	-	109	67	8.5	240	65	27	50	42	Ø 16	3500	7500	199
131036	-	-	109	67	8.5	240	82	44	50	42	Ø 12	2600	7500	197
131037	-	-	109	67	8.5	240	82	44	50	42	Ø 14	3500	7500	197
131038	-	-	109	67	8.5	240	82	44	50	42	Ø 16	3500	7500	197
13054	-	-	109	67	10.5	240	82	44	50	42	Ø 12	2600	7500	197
13055	-	-	109	67	10.5	240	82	44	50	42	Ø 14	3500	7500	197
13056	-	-	109	67	10.5	240	82	44	50	42	Ø 16	3500	7500	197
13536	-	-	100	70	10.5	234	85	43	50	42	Ø 12	2600	7500	201
13537	-	-	100	70	10.5	234	85	43	50	42	Ø 14	3500	7500	201
13538	-	-	100	70	10.5	234	85	43	50	42	Ø 16	3500	7500	201
13044	71	69	-	-	10.5	204	71	31	50	42	Ø 12	2600	8500	205
13045	71	69	-	-	10.5	204	71	31	50	42	Ø 14	3500	8500	205
13046	71	69	-	-	10.5	204	71	31	50	42	Ø 16	3500	8500	205
13586	95	75	-	-	10.5	234	85	43	50	42	Ø 12	2600	7500	203
13587	95	75	-	-	10.5	234	85	43	50	42	Ø 14	3500	7500	203
13588	95	75	-	-	10.5	234	85	43	50	42	Ø 16	3500	7500	203

Guide for side bracket selection - Technical information

ADJUSTABLE BRACKETS

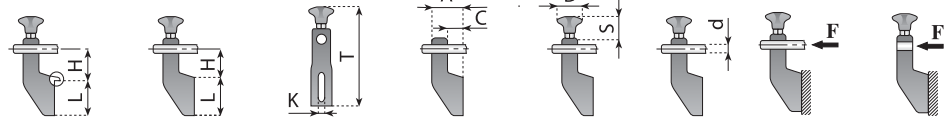

CATALOG

Code	L	H	L	H	K	T	A	C	D	S	ROD	N (Newton)	N (Newton)	Page
13280	-	-	109	85	10.5	258	65	27	50	42	Ø 12	2600	7500	199
13281	-	-	109	85	10.5	258	65	27	50	42	Ø 14	3500	7500	199
13282	-	-	109	85	10.5	258	65	27	50	42	Ø 16	3500	7500	199
131064	-	-	109	85	8.5	258	65	27	50	42	Ø 12	2600	7500	199
131065	-	-	109	85	8.5	258	65	27	50	42	Ø 14	3500	7500	199
131066	-	-	109	85	8.5	258	65	27	50	42	Ø 16	3500	7500	199
131039	-	-	109	85	8.5	258	82	44	50	42	Ø 12	2600	7500	197
131040	-	-	109	85	8.5	258	82	44	50	42	Ø 14	3500	7500	197
131041	-	-	109	85	8.5	258	82	44	50	42	Ø 16	3500	7500	197
13886	-	-	109	85	10.5	258	82	44	50	42	Ø 12	2600	7500	197
13887	-	-	109	85	10.5	258	82	44	50	42	Ø 14	3500	7500	197
13888	-	-	109	85	10.5	258	82	44	50	42	Ø 16	3500	7500	197
13539	-	-	100	87	10.5	234	85	43	50	42	Ø 12	2600	7500	201
13540	-	-	100	87	10.5	234	85	43	50	42	Ø 14	3500	7500	201
13541	-	-	100	87	10.5	234	85	43	50	42	Ø 16	3500	7500	201
13892	71	69	-	-	10.5	204	71	31	50	42	Ø 12	2600	8500	205
13893	71	69	-	-	10.5	204	71	31	50	42	Ø 14	3500	8500	205
13894	71	69	-	-	10.5	204	71	31	50	42	Ø 16	3500	8500	205
13589	95	75	-	-	10.5	234	85	43	50	42	Ø 12	2600	7500	203
13590	95	75	-	-	10.5	234	85	43	50	42	Ø 14	3500	7500	203
13591	95	75	-	-	10.5	234	85	43	50	42	Ø 16	3500	7500	203



Code	L	H	L	H	K	T	A	C	D	S	ROD	N (Newton)	N (Newton)	Page
131067	-	-	109	69	8.5	235	65	27	50	42	Ø 12	5000	7500	199
131073	-	-	109	69	8.5	235	65	27	50	42	Ø 12	5000	7500	199
131068	-	-	109	69	8.5	235	65	27	50	42	Ø 14	6000	7500	199
131074	-	-	109	69	8.5	235	65	27	50	42	Ø 14	6000	7500	199
131069	-	-	109	69	8.5	235	65	27	50	42	Ø 16	6000	7500	199
131075	-	-	109	69	8.5	235	65	27	50	42	Ø 16	6000	7500	199
13283	-	-	109	69	10.5	235	65	27	50	42	Ø 12	5000	7500	199
13286	-	-	109	69	10.5	235	65	27	50	42	Ø 12	5000	7500	199
13284	-	-	109	69	10.5	235	65	27	50	42	Ø 14	6000	7500	199
13287	-	-	109	69	10.5	235	65	27	50	42	Ø 14	6000	7500	199
13285	-	-	109	69	10.5	235	65	27	50	42	Ø 16	6000	7500	199
13288	-	-	109	69	10.5	235	65	27	50	42	Ø 16	6000	7500	199
131042	-	-	109	69	8.5	235	82	44	50	42	Ø 12	5000	7500	197
131048	-	-	109	69	8.5	235	82	44	50	42	Ø 12	5000	7500	197
131043	-	-	109	69	8.5	235	82	44	50	42	Ø 14	6000	7500	197
131049	-	-	109	69	8.5	235	82	44	50	42	Ø 14	6000	7500	197
131044	-	-	109	69	8.5	235	82	44	50	42	Ø 16	6000	7500	197
131050	-	-	109	69	8.5	235	82	44	50	42	Ø 16	6000	7500	197
13749	-	-	109	69	10.5	235	82	44	50	42	Ø 12	5000	7500	197
13025	-	-	109	69	10.5	235	82	44	50	42	Ø 12	5000	7500	197
13750	-	-	109	69	10.5	235	82	44	50	42	Ø 14	6000	7500	197
13026	-	-	109	69	10.5	235	82	44	50	42	Ø 14	6000	7500	197
13751	-	-	109	69	10.5	235	82	44	50	42	Ø 16	6000	7500	197
13027	-	-	109	69	10.5	235	82	44	50	42	Ø 16	6000	7500	197
13542	-	-	100	72	10.5	229	85	43	50	42	Ø 12	5000	7500	201
13545	-	-	100	72	10.5	229	85	43	50	42	Ø 12	5000	7500	201
13543	-	-	100	72	10.5	229	85	43	50	42	Ø 14	6000	7500	201
13546	-	-	100	72	10.5	229	85	43	50	42	Ø 14	6000	7500	201
13544	-	-	100	72	10.5	229	85	43	50	42	Ø 16	6000	7500	201
13547	-	-	100	72	10.5	229	85	43	50	42	Ø 16	6000	7500	201
13100	71	69	-	-	10.5	199	71	31	50	42	Ø 12	5000	8500	205
13047	71	69	-	-	10.5	199	71	31	50	42	Ø 12	5000	8500	205
13101	71	69	-	-	10.5	199	71	31	50	42	Ø 14	6000	8500	205
13048	71	69	-	-	10.5	199	71	31	50	42	Ø 14	6000	8500	205
13102	71	69	-	-	10.5	199	71	31	50	42	Ø 16	6000	8500	205
13049	71	69	-	-	10.5	199	71	31	50	42	Ø 16	6000	8500	205
13592	95	77	-	-	10.5	229	85	43	50	42	Ø 12	5000	7500	203
13595	95	77	-	-	10.5	229	85	43	50	42	Ø 12	5000	7500	203
13593	95	77	-	-	10.5	229	85	43	50	42	Ø 14	6000	7500	203
13596	95	77	-	-	10.5	229	85	43	50	42	Ø 14	6000	7500	203
13594	95	77	-	-	10.5	229	85	43	50	42	Ø 16	6000	7500	203
13597	95	77	-	-	10.5	229	85	43	50	42	Ø 16	6000	7500	203

Guide for side bracket selection

Technical information

BRACKETS

MAX. LOAD
RESISTANCE



CATALOG



Code	Newton	Page
13020	7500	196



Code	Newton	Page
13185	7500	200



Code	Newton	Page
13057	9900	208



Code	Newton	Page
13900	14750	208



Code	Newton	Page
13249	6000	207

BRACKETS

MAX. LOAD
RESISTANCE



CATALOG



Code	Newton	Page
13040	8500	204



Code	Newton	Page
13186	7500	202



Code	Newton	Page
13898	7500	207



Code	Newton	Page
13930	9900	208



Code	Newton	Page
13251	7500	207

Side guide brackets



BRACKET WITH ECCENTRIC LEVER

Material: reinforced polyamide.

Packaging: 50 pieces.

Code	For rod Ø
13767	12
13768	14

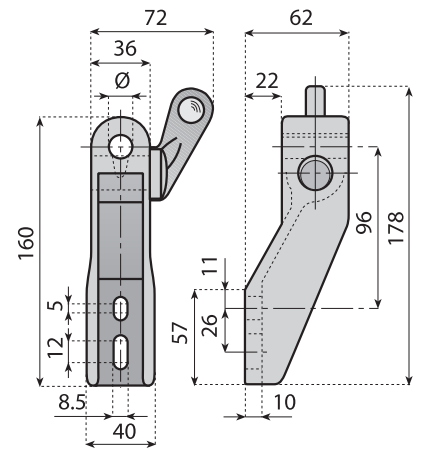

BRACKET WITH ECCENTRIC LEVER

Material: reinforced polyamide.

Packaging: 50 pieces.

Code	For rod Ø
13200	12
13201	14

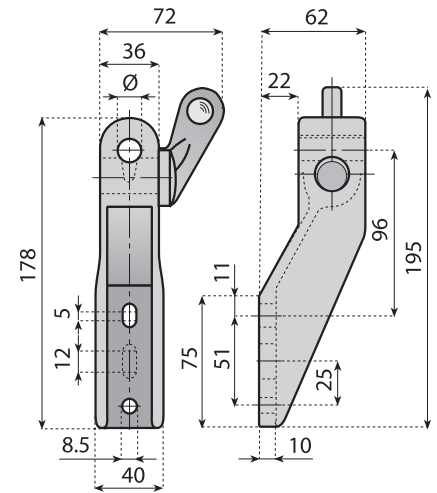

BRACKET WITH ECCENTRIC LEVER

Material: reinforced polyamide.

Packaging: 50 pieces.

Code	For rod Ø
13760	15

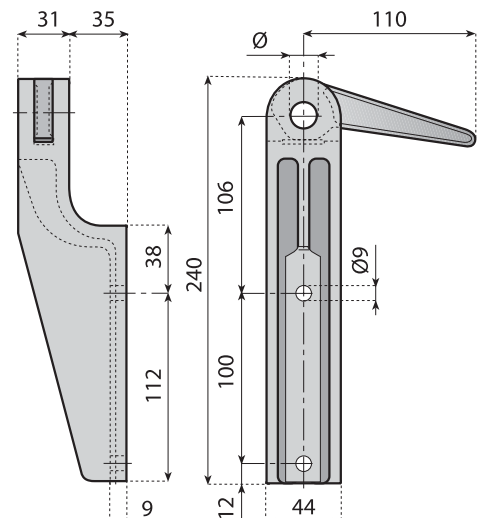

Side guide brackets



304 Stainless steel Nickel plated brass Polyamide



BRACKET WITH EYEBOLT AND KNOB

Material: polyamide, eyebolt and washer in stainless steel AISI 304, knob in polyamide with nickel plated brass insert.

Packaging: 50 pieces.

Note: max recommended tightening torque 4 Kgm.

Code	For rod Ø
13211	12
13212	14

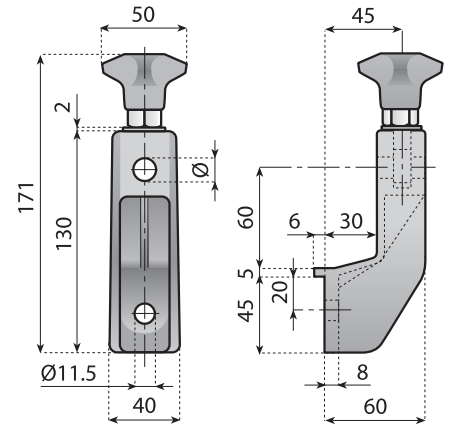

BRACKET WITH EYEBOLT AND KNOB

Material: polyamide, eyebolt and washer in stainless steel AISI 304, knob in polyamide with nickel plated brass insert.

Packaging: 50 pieces.

Note: max recommended tightening torque 4 Kgm.

Code	For rod Ø
13851	12
13852	14

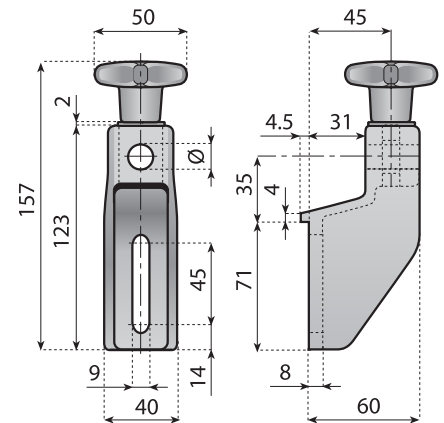

BRACKET WITH EYEBOLT AND KNOB

Material: polyamide, eyebolt and washer in stainless steel AISI 304, knob in polyamide with nickel plated brass insert.

Packaging: 50 pieces.

Note: max recommended tightening torque 4 Kgm.

Code	For rod Ø
13764	12
13765	14

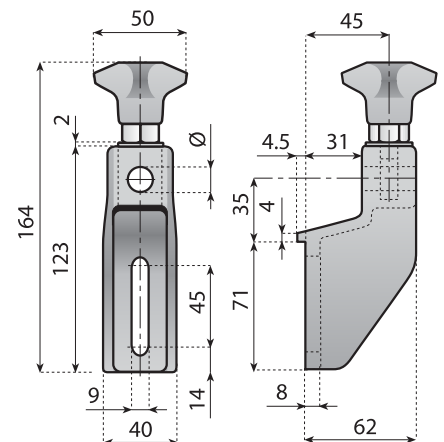

Side guide brackets



304 Stainless steel Nickel plated brass Polyamide



BRACKET WITH EYEBOLT

Material: polyamide, eyebolt and washer in stainless steel AISI 304, nut in nickel plated brass.

Packaging: 50 pieces.

Note: max recommended tightening torque 4 Kgm.

Code	K	For rod Ø
13632	9	12
13633	9	14
13634	10.5	12
13635	10.5	14

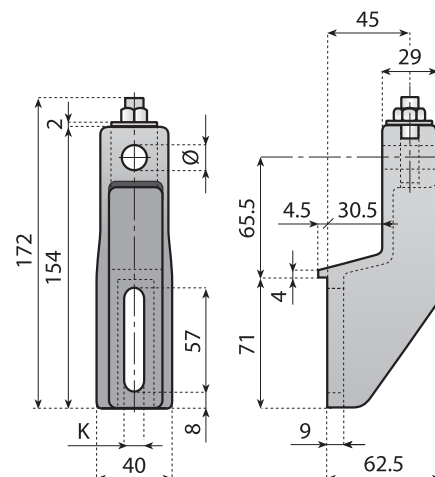

BRACKET WITH EYEBOLT AND KNOB

Material: polyamide, eyebolt and washer in stainless steel AISI 304, knob in polyamide with nickel plated brass insert.

Packaging: 50 pieces.

Note: max recommended tightening torque 4 Kgm.

Code	K	For rod Ø
13853	9	12
13854	9	14
13855	10.5	12
13856	10.5	14
13857	10.5	16

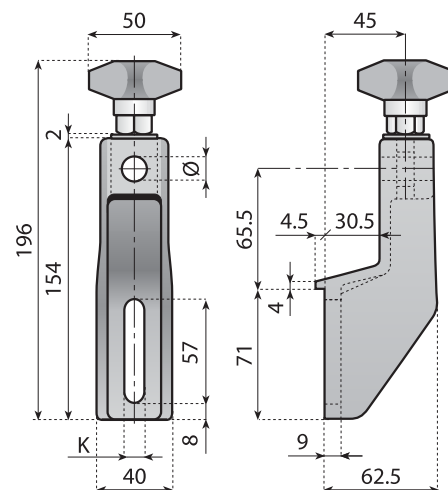

BRACKET WITH EYEBOLT AND KNOB

Material: polyamide, eyebolt and washer in stainless steel AISI 304, knob in polyamide with nickel plated brass insert.

Packaging: 50 pieces.

Note: max recommended tightening torque 4 Kgm.

Code	K	For rod Ø
13858	9	12
13859	9	14
13860	10.5	12
13861	10.5	14
13862	10.5	16

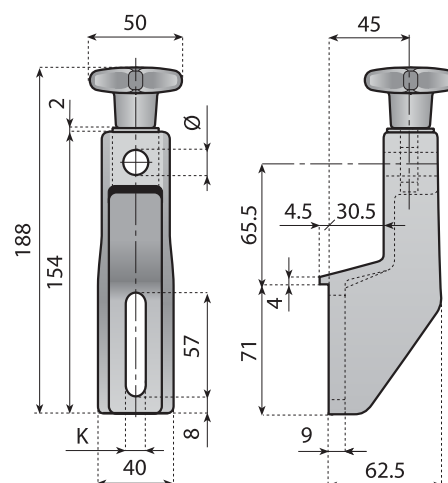

Side guide brackets



304 Stainless steel Nickel plated brass Polyamide



BRACKET WITH EYEBOLT AND KNOB

Material: polyamide, eyebolt and washer in stainless steel AISI 304, knob in polyamide with nickel plated brass insert.

Packaging: 50 pieces.

Note: max recommended tightening torque 4 Kgm.

Code	K	For rod Ø
13692	9	12
13693	9	14
13696	10.5	12
13697	10.5	14
13769	10.5	16

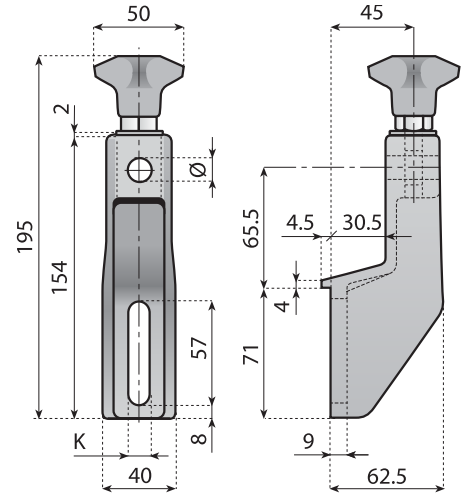

BRACKET WITH EYEBOLT AND KNOB

Material: polyamide, eyebolt and washer in stainless steel AISI 304, knob in polyamide with nickel plated brass insert.

Packaging: 50 pieces.

Note: max recommended tightening torque 4 Kgm.

Code	K	For rod Ø
13863	9	12
13864	9	14
13865	10.5	12
13866	10.5	14
13867	10.5	16

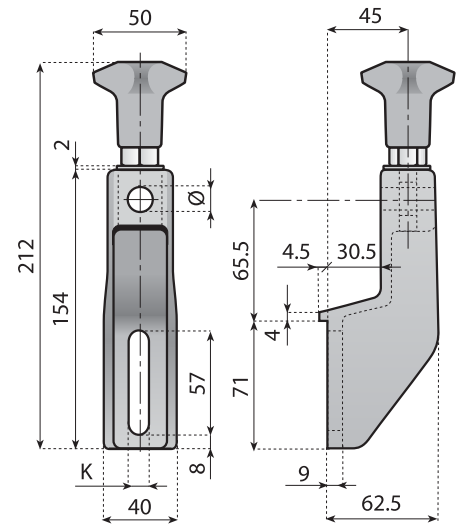

BRACKET WITH EYEBOLT AND KNOB

Material: polyamide, eyebolt and washer in stainless steel AISI 304, knob in polyamide with nickel plated brass insert.

Packaging: 50 pieces.

Note: max recommended tightening torque 4 Kgm.

Code	K	For rod Ø
13268	9	12
13269	9	14
13208	10.5	16
13209	10.5	12
13210	10.5	14

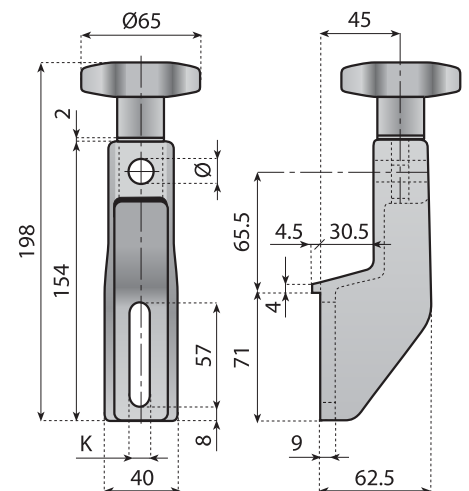

Side guide brackets



304 Stainless steel Nickel plated brass Polyamide

BRACKET WITH EYEBOLT AND KNOB

Material: polyamide, eyebolt and washer in stainless steel AISI 304, knob in polyamide with nickel plated brass insert.

Packaging: 50 pieces.

Note: max recommended tightening torque 4 Kgm.



Code	Type	K	For rod Ø
13639		9	12
13640	Standard	9	14
13647		9	16
13641		10.5	12
13642	Standard	10.5	14
13648		10.5	16
13643		9	12
13644	With tongue	9	14
13649		9	16
13645		10.5	12
13646	With tongue	10.5	14
13650		10.5	16

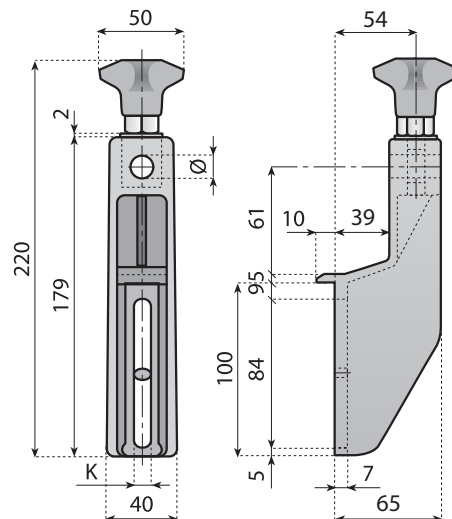

BRACKET WITH EYEBOLT AND KNOB

Material: polyamide, eyebolt and washer in stainless steel AISI 304, knob in polyamide with nickel plated brass insert.

Packaging: 50 pieces.

Note: max recommended tightening torque 4 Kgm.



Code	Type	K	For rod Ø
13868		9	12
13869	Standard	9	14
13870		9	16
13871		10.5	12
13872	Standard	10.5	14
13873		10.5	16
13874		9	12
13875	With tongue	9	14
13876		9	16
13877		10.5	12
13878	With tongue	10.5	14
13879		10.5	16

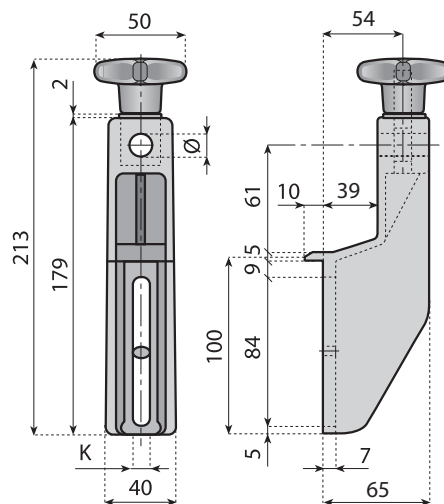

BRACKET WITH EYEBOLT AND KNOB

Material: polyamide, eyebolt and washer in stainless steel AISI 304, knob in polyamide with nickel plated brass insert.

Packaging: 50 pieces.

Note: max recommended tightening torque 4 Kgm.



Code	Type	K	For rod Ø
13213		9	12
13214	Standard	9	14
13227		9	16
13215		10.5	12
13216	Standard	10.5	14
13228		10.5	16
13217		9	12
13218	With tongue	9	14
13229		9	16
13219		10.5	12
13220	With tongue	10.5	14
13230		10.5	16

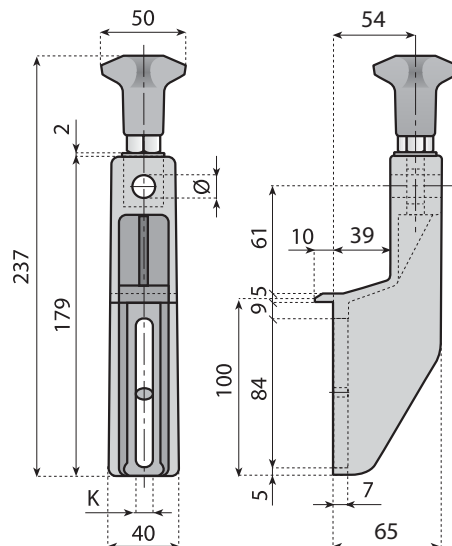

Side guide brackets



304 Stainless steel Nickel plated brass Polyamide



BRACKET WITH EYEBOLT AND KNOB

Material: polyamide, eyebolt and washer in stainless steel AISI 304, knob in polyamide with nickel plated brass insert.

Packaging: 50 pieces.

Note: max recommended tightening torque 4 Kgm.

Code	K	For rod Ø
13326	9	12
13327	9	14
13328	9	16
13332	10.5	12
13333	10.5	14
13334	10.5	16

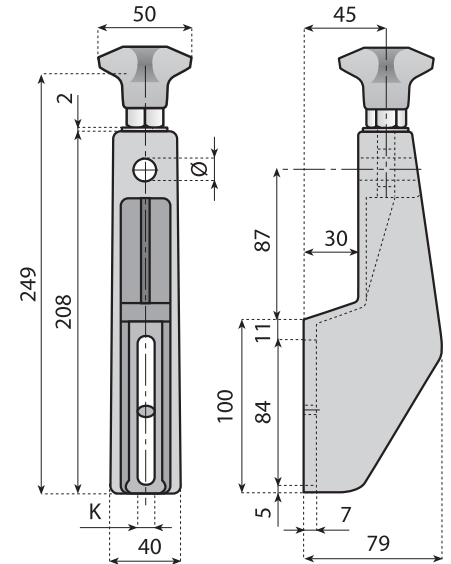

BRACKET WITH EYEBOLT AND KNOB

Material: polyamide, eyebolt and washer in stainless steel AISI 304, knob in polyamide with nickel plated brass insert.

Packaging: 50 pieces.

Note: max recommended tightening torque 4 Kgm.

Code	K	For rod Ø
13880	9	12
13881	9	14
13882	9	16
13883	10.5	12
13884	10.5	14
13885	10.5	16

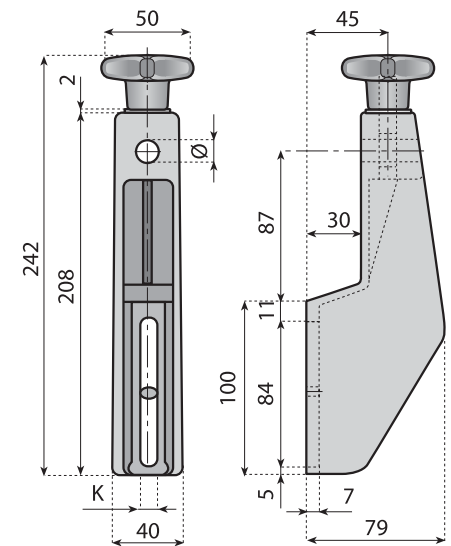

BRACKET WITH EYEBOLT AND KNOB

Material: polyamide, eyebolt and washer in stainless steel AISI 304, knob in polyamide with nickel plated brass insert.

Packaging: 50 pieces.

Note: max recommended tightening torque 4 Kgm.

Code	K	For rod Ø
13221	9	12
13222	9	14
13223	9	16
13224	10.5	12
13225	10.5	14
13226	10.5	16

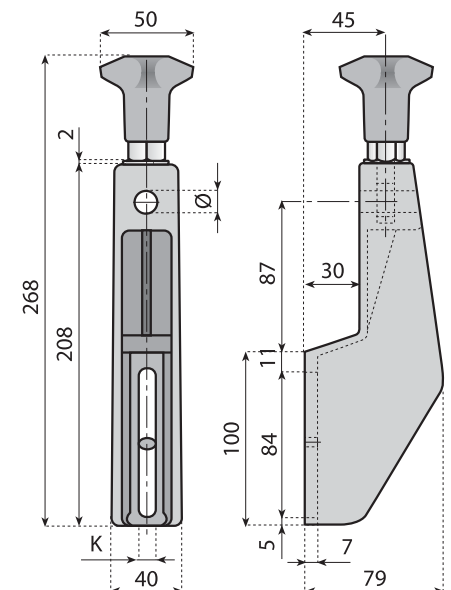

Adjustable brackets



304 Stainless steel



Polyamide



Accessories



BRACKET

Material: reinforced polyamide.

Packaging: 50 pieces.

Code	K
131015	8.5
13020	10.5

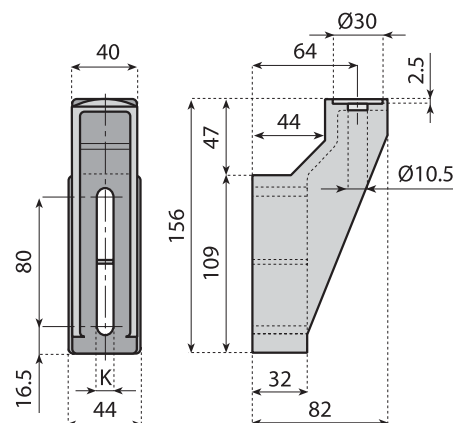

ADJUSTABLE BRACKET

Material: bracket and adjustable head in polyamide; eyebolt, nut and washer in stainless steel AISI 304.

Packaging: 50 pieces.

Note: nut regulates rod position and head adjustability. Max recommended tightening torque 4 Kgm.

Code	K	For rod Ø
131030	8.5	12
131031	8.5	14
131032	8.5	16
13021	10.5	12
13088	10.5	14
13089	10.5	16

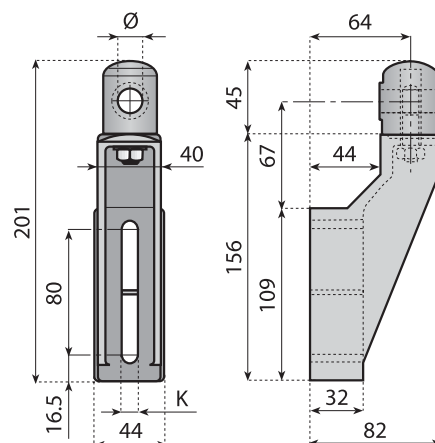

ADJUSTABLE BRACKET

Material: bracket and adjustable head in polyamide; bolt in nickel plated brass, screw and washer in stainless steel AISI 304.

Packaging: 50 pieces.

Note: screw regulates rod position and head adjustability. Max recommended tightening torque 4 Kgm.

Code	K	For rod Ø
131033	8.5	12
131034	8.5	14
131035	8.5	16
13847	10.5	12
13848	10.5	14
13849	10.5	16

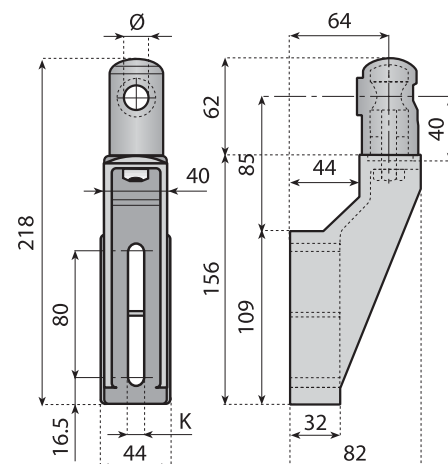

Adjustable brackets



304 Stainless steel



Nickel plated brass



Polyamide



Accessories

ADJUSTABLE BRACKET

Material: bracket and adjustable head in polyamide; eyebolt, nut, screws and washer in stainless steel AISI 304; knob in polyamide with nickel plated brass insert.

Packaging: 50 pieces.

Note: screw regulates rod position and head adjustability. Max recommended tightening torque 4 Kgm.



Code	K	For rod Ø
131036	8.5	12
131037	8.5	14
131038	8.5	16
13054	10.5	12
13055	10.5	14
13056	10.5	16

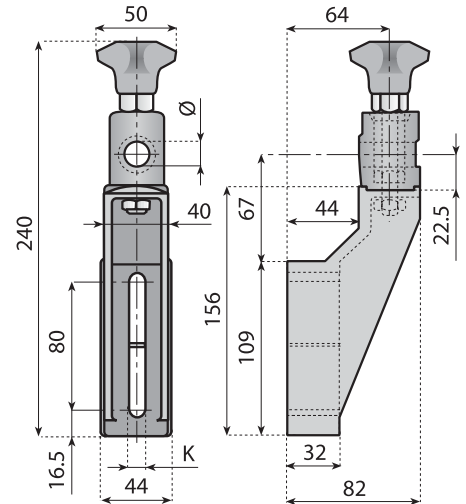

ADJUSTABLE BRACKET

Material: bracket and adjustable head in polyamide; eyebolt, nut, screws and washer in stainless steel AISI 304; knob in polyamide with nickel plated brass insert.

Packaging: 50 pieces.

Note: screw regulates rod position and head adjustability. Max recommended tightening torque 4 Kgm.



Code	K	For rod Ø
131039	8.5	12
131040	8.5	14
131041	8.5	16
13886	10.5	12
13887	10.5	14
13888	10.5	16

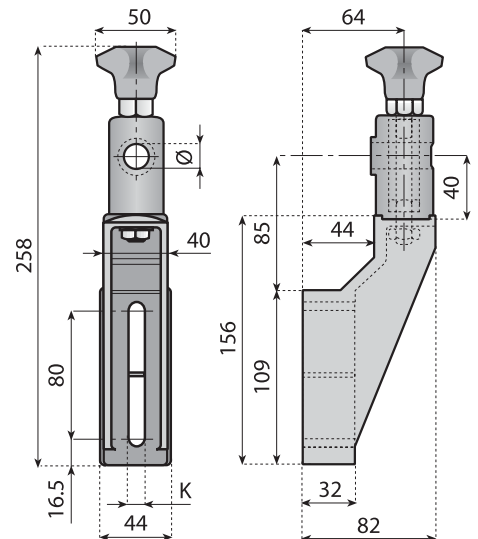

ADJUSTABLE BRACKET

Material: bracket in polyamide; screw and washer in stainless steel AISI 304; knob in polyamide with nickel plated brass insert.

Packaging: 50 pieces.

Note: screw regulates rod position and head adjustability. Max recommended tightening torque 4 Kgm.



Code	Code	Head material	K	For rod Ø
Version with star knob	Version with screw			
131042	131045	Nickel plated brass	8.5	12
131043	131046		8.5	14
131044	131047		8.5	16
131048	131051	Stainless steel AISI 304	8.5	12
131049	131052		8.5	14
131050	131053		8.5	16
13749	13746	Nickel plated brass	10.5	12
13750	13747		10.5	14
13751	13748		10.5	16
13025	13022	Stainless steel AISI 304	10.5	12
13026	13023		10.5	14
13027	13024		10.5	16

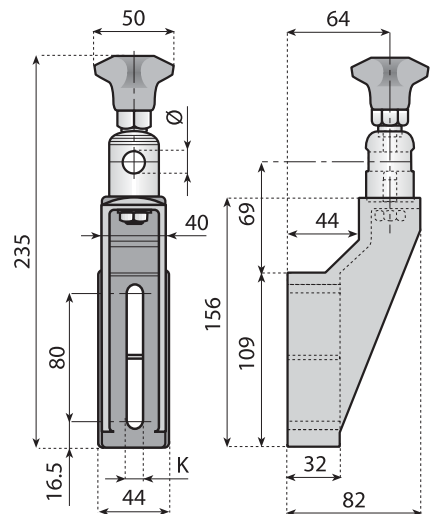

Adjustable brackets



304 Stainless steel



Nickel plated brass



Polyamide



Accessories



BRACKET

Material: reinforced polyamide.

Packaging: 50 pieces.

Code	K
131054	8.5
13270	10.5

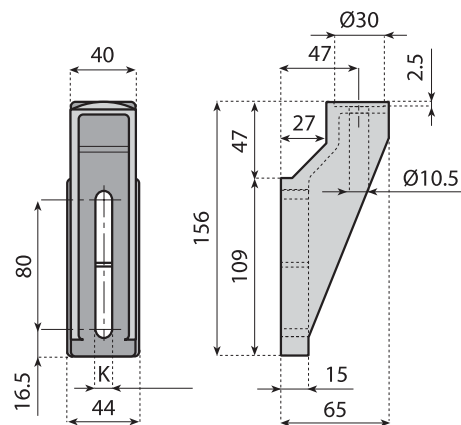

ADJUSTABLE BRACKET

Material: bracket and adjustable head in polyamide; eyebolt, nut and washer in stainless steel AISI 304.

Packaging: 50 pieces.

Note: nut regulates rod position and head adjustability. Max recommended tightening torque 4 Kgm.

Code	K	For rod Ø
131055	8.5	12
131056	8.5	14
131057	8.5	16
13271	10.5	12
13272	10.5	14
13273	10.5	16

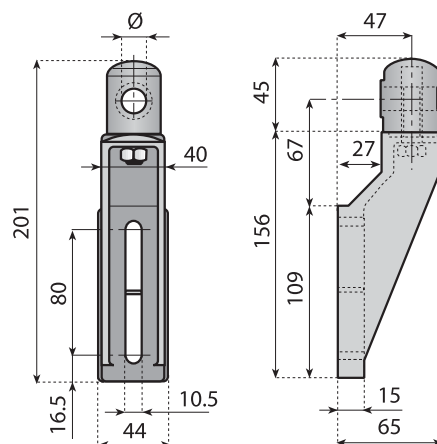

ADJUSTABLE BRACKET

Material: bracket and adjustable head in polyamide; bolt in nickel plated brass, screw and washer in stainless steel AISI 304.

Packaging: 50 pieces.

Note: screw regulates rod position and head adjustability. Max recommended tightening torque 4 Kgm.

Code	K	For rod Ø
131058	8.5	12
131059	8.5	14
131060	8.5	16
13274	10.5	12
13275	10.5	14
13276	10.5	16

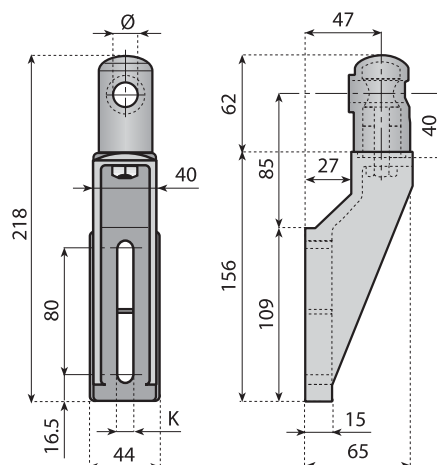

Adjustable brackets



304 Stainless steel



Nickel plated brass



Polyamide



Accessories



ADJUSTABLE BRACKET

Material: bracket and adjustable head in polyamide; eyebolt, nut, screws and washer in stainless steel; knob in polyamide with nickel plated brass insert.

Packaging: 50 pieces.

Note: screw regulates rod position and head adjustability. Max recommended tightening torque 4 Kgm.

Code	K	For rod Ø
131061	8.5	12
131062	8.5	14
131063	8.5	16
13277	10.5	12
13278	10.5	14
13279	10.5	16

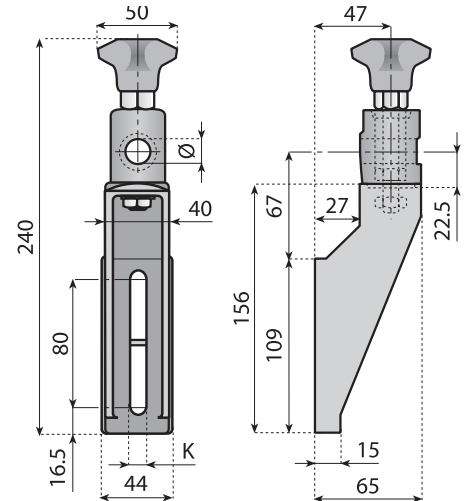

ADJUSTABLE BRACKET

Material: bracket and adjustable head in polyamide; eyebolt, nut, screws and washer in stainless steel AISI 304; knob in polyamide with nickel plated brass insert.

Packaging: 50 pieces.

Note: screw regulates rod position and head adjustability. Max recommended tightening torque 4 Kgm.

Code	K	For rod Ø
131064	8.5	12
131065	8.5	14
131066	8.5	16
13280	10.5	12
13281	10.5	14
13282	10.5	16

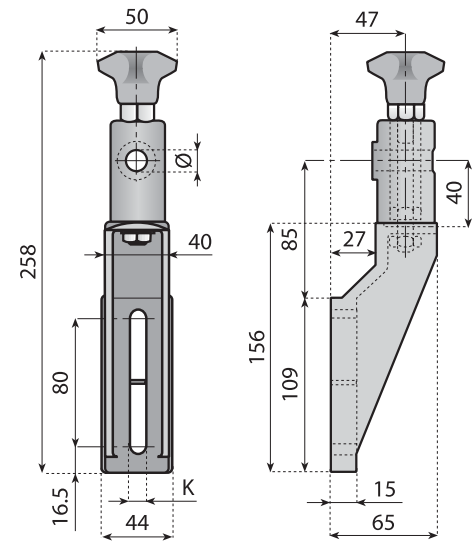

ADJUSTABLE BRACKET

Material: bracket in polyamide; screw and washer in stainless steel AISI 304; knob in polyamide with nickel plated brass insert.

Packaging: 50 pieces.

Note: screw regulates rod position and head adjustability. Max recommended tightening torque 4 Kgm.

Code	Code	Head material	K	For rod Ø
Version with star knob	Version with screw			
131067	131070	Nickel plated brass	8.5	12
131068	131071		8.5	14
131069	131072		8.5	16
131073	131076	Stainless steel	8.5	12
131074	131077		8.5	14
131075	131078		AISI 304	8.5
13283	13289	Nickel plated brass	10.5	12
13284	13290		10.5	14
13285	13291		10.5	16
13286	13292	Stainless steel	10.5	12
13287	13293		10.5	14
13288	13294		AISI 304	10.5

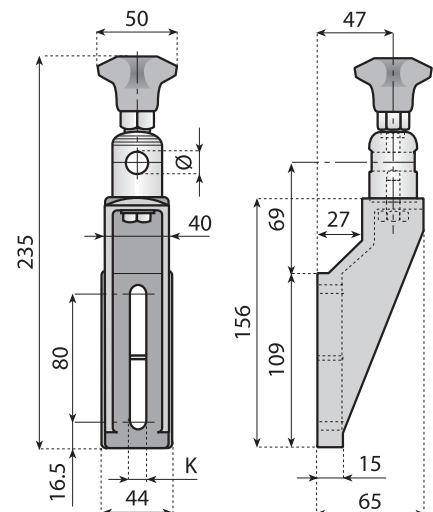

Adjustable brackets



304 Stainless steel



Nickel plated brass



Polyamide



Accessories



BRACKET

Material: reinforced polyamide.

Packaging: 50 pieces.

Code

13185

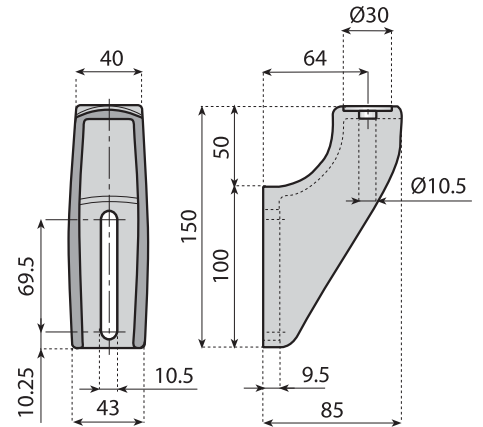

ADJUSTABLE BRACKET

Material: bracket and adjustable head in polyamide; eyebolt, nut and washer in stainless steel AISI 304.

Packaging: 50 pieces.

Note: nut regulates rod position and head adjustability. Max recommended tightening torque 4 Kgm.

Code

For rod Ø

13530	12
13531	14
13532	16

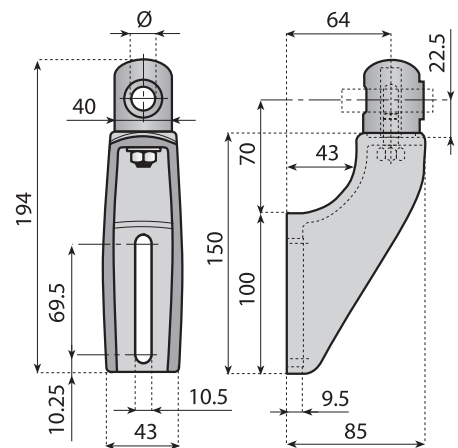

ADJUSTABLE BRACKET

Material: bracket and adjustable head in polyamide; bolt in nickel plated brass, screw and washer in stainless steel AISI 304.

Packaging: 50 pieces.

Note: screw regulates rod position and head adjustability. Max recommended tightening torque 4 Kgm.

Code

For rod Ø

13533	12
13534	14
13535	16

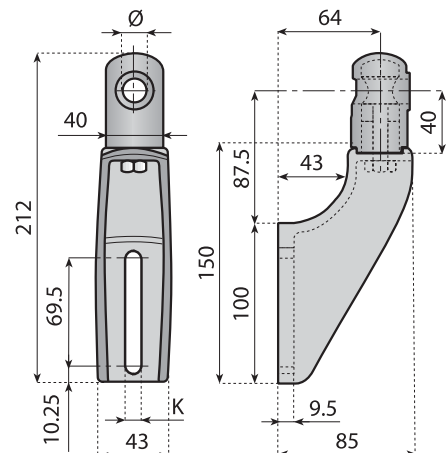

Adjustable brackets



304 Stainless steel



Nickel plated brass



Polyamide



Accessories



ADJUSTABLE BRACKET

Material: bracket and adjustable head in polyamide; eyebolt, nut, screws and washer in stainless steel AISI 304; knob in polyamide with nickel plated brass insert.

Packaging: 50 pieces.

Note: screw regulates rod position and head adjustability. Max recommended tightening torque 4 Kgm.

Code	For rod Ø
13536	12
13537	14
13538	16

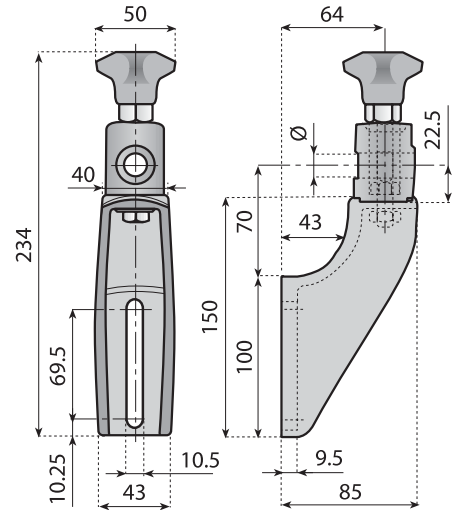

ADJUSTABLE BRACKET

Material: bracket and adjustable head in polyamide; eyebolt, nut, screws and washer in stainless steel AISI 304; knob in polyamide with nickel plated brass insert.

Packaging: 50 pieces.

Note: screw regulates rod position and head adjustability. Max recommended tightening torque 4 Kgm.

Code	For rod Ø
13539	12
13540	14
13541	16

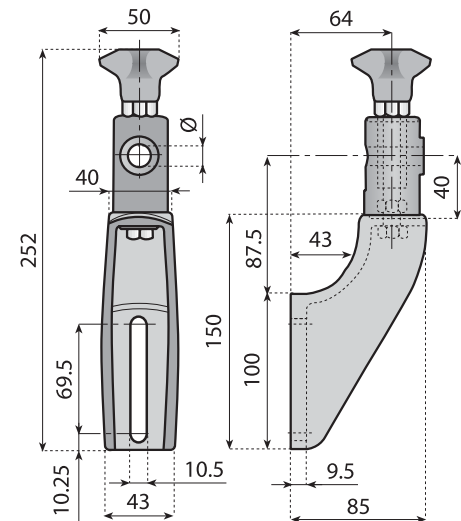

ADJUSTABLE BRACKET

Material: bracket in polyamide; screw and washer in stainless steel AISI 304; knob in polyamide with nickel plated brass insert.

Packaging: 50 pieces.

Note: screw regulates rod position and head adjustability. Max recommended tightening torque 4 Kgm.

Code	Head material	For rod Ø
13542	Nickel plated brass	12
13543	Nickel plated brass	14
13544	Nickel plated brass	16
13545	Stainless steel AISI 304	12
13546	Stainless steel AISI 304	14
13547	Stainless steel AISI 304	16

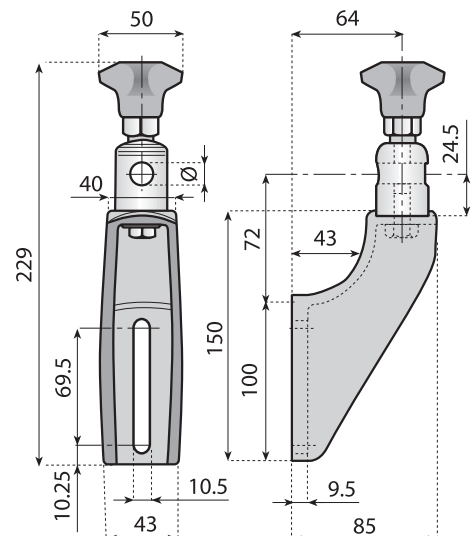

Adjustable brackets



304 Stainless steel



Nickel plated brass



Polyamide



Accessories



BRACKET WITH TONGUE

Material: reinforced polyamide.

Packaging: 50 pieces.

Code

13186

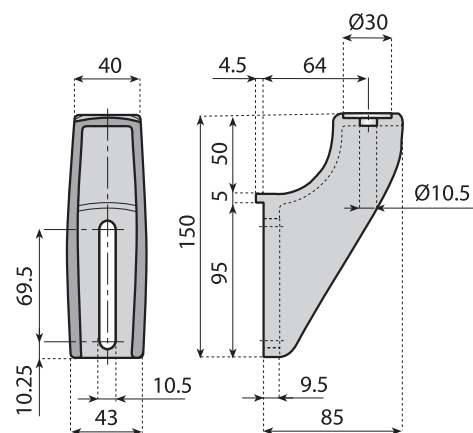

ADJUSTABLE BRACKET

Material: bracket and adjustable head in polyamide; eyebolt, nut and washer in stainless steel AISI 304.

Packaging: 50 pieces.

Note: nut regulates rod position and head adjustability. Max recommended tightening torque 4 Kgm.

Code

For rod Ø

13580	12
13581	14
13582	16

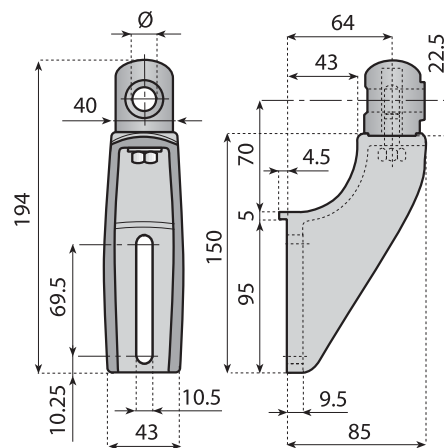

ADJUSTABLE BRACKET

Material: bracket and adjustable head in polyamide; bolt in nickel plated brass, screw and washer in stainless steel AISI 304.

Packaging: 50 pieces.

Note: screw regulates rod position and head adjustability. Max recommended tightening torque 4 Kgm.

Code

For rod Ø

13583	12
13584	14
13585	16

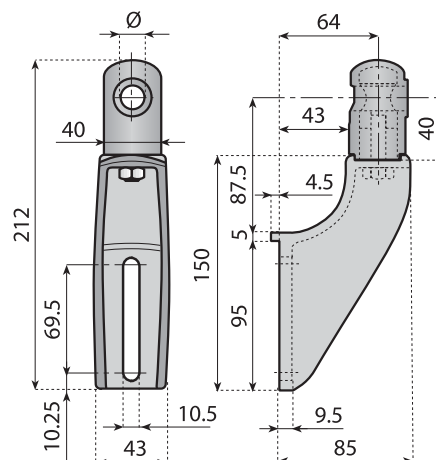

Adjustable brackets



304 Stainless steel Nickel plated brass Polyamide Accessories



ADJUSTABLE BRACKET

Material: bracket and adjustable head in polyamide; eyebolt, nut, screws and washer in stainless steel AISI 304; knob in polyamide with nickel plated brass insert.

Packaging: 50 pieces.

Note: screw regulates rod position and head adjustability. Max recommended tightening torque 4 Kgm.

Code	For rod Ø
13586	12
13587	14
13588	16

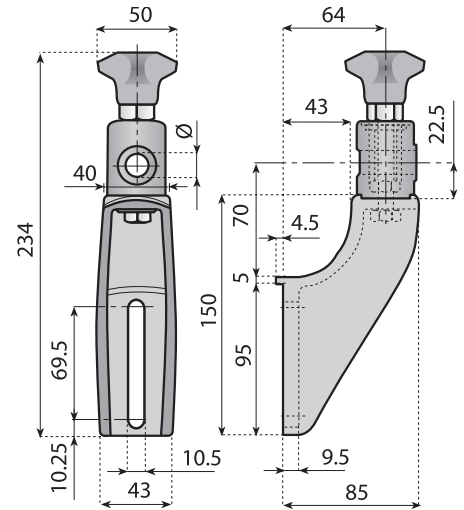

ADJUSTABLE BRACKET

Material: bracket and adjustable head in polyamide; eyebolt, nut, screws and washer in stainless steel AISI 304; knob in polyamide with nickel plated brass insert.

Packaging: 50 pieces.

Note: screw regulates rod position and head adjustability. Max recommended tightening torque 4 Kgm.

Code	For rod Ø
13589	12
13590	14
13591	16

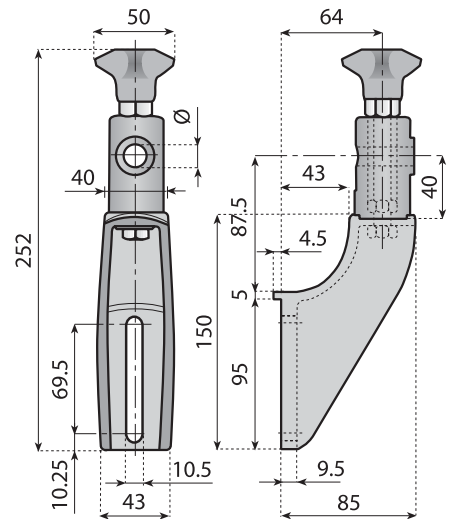

ADJUSTABLE BRACKET

Material: bracket in polyamide; screw and washer in stainless steel AISI 304; knob in polyamide with nickel plated brass insert.

Packaging: 50 pieces.

Note: screw regulates rod position and head adjustability. Max recommended tightening torque 4 Kgm.

Code	Head material	For rod Ø
13592	Nickel	12
13593	plated brass	14
13594		16
13595	Stainless steel	12
13596	AISI 304	14
13597		16

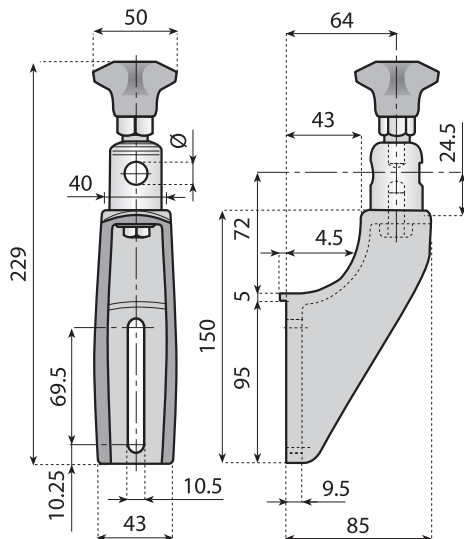

Adjustable brackets



304 Stainless steel



Nickel plated brass



Polyamide



Accessories



BRACKET

Material: reinforced polyamide.

Packaging: 50 pieces.

Code

13040

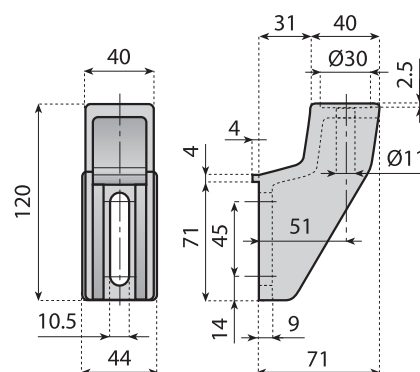

ADJUSTABLE BRACKET

Material: bracket and adjustable head in polyamide; eyebolt, nut and washer in stainless steel AISI 304.

Packaging: 50 pieces.

Note: nut regulates rod position and head adjustability. Max recommended tightening torque 4 Kgm.

Code

Code	For rod Ø
13041	12
13042	14
13043	16

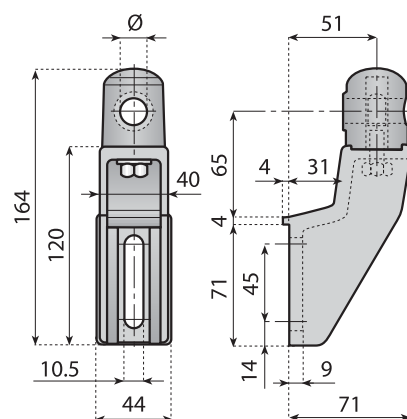

ADJUSTABLE BRACKET

Material: bracket and adjustable head in polyamide; threaded insert in nickel plated brass, screw and washer in stainless steel AISI 304.

Packaging: 50 pieces.

Note: screw regulates rod position and head adjustability. Max recommended tightening torque 4 Kgm.

Code

Code	For rod Ø
13889	12
13890	14
13891	16

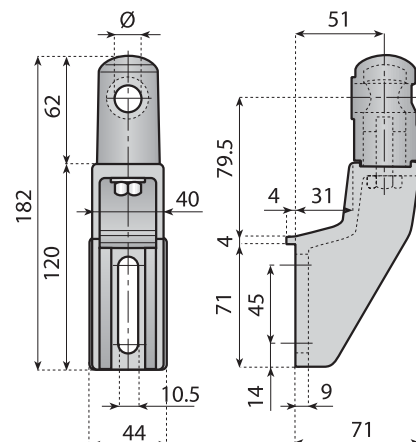

Adjustable brackets



304 Stainless steel



Nickel plated brass



Polyamide



Accessories



ADJUSTABLE BRACKET

Material: bracket and adjustable head in polyamide; eyebolt, nut, screws and washer in stainless steel AISI 304; knob in polyamide with nickel plated brass insert.

Packaging: 50 pieces.

Note: screw regulates rod position and head adjustability. Max recommended tightening torque 4 Kgm.

Code	For rod Ø
13044	12
13045	14
13046	16

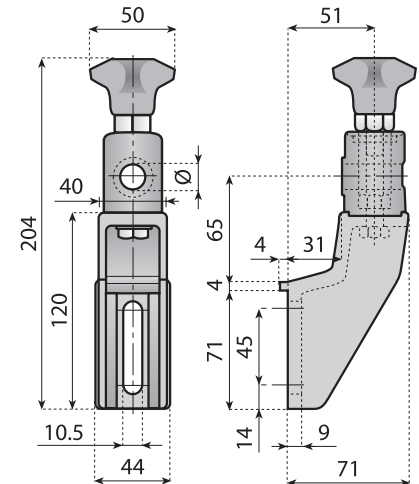

ADJUSTABLE BRACKET

Material: bracket and adjustable head in polyamide; eyebolt, nut, screws and washer in stainless steel AISI 304; knob in polyamide with nickel plated brass insert.

Packaging: 50 pieces.

Note: screw regulates rod position and head adjustability. Max recommended tightening torque 4 Kgm.

Code	For rod Ø
13892	12
13893	14
13894	16

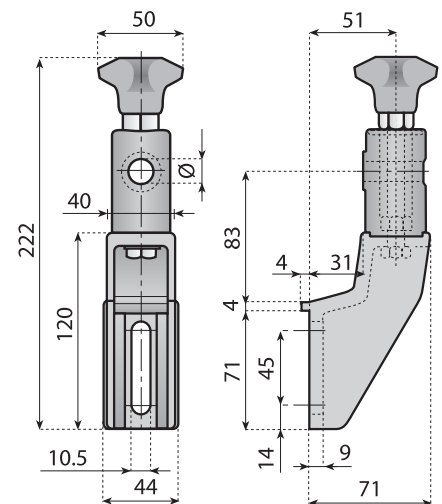

ADJUSTABLE BRACKET

Material: bracket in polyamide; screw and washer in stainless steel AISI 304; knob in polyamide with nickel plated brass insert.

Packaging: 50 pieces.

Note: screw regulates rod position and head adjustability. Max recommended tightening torque 4 Kgm.

Code	Head material	For rod Ø
13100	Nickel plated brass	12
13101		14
13102		16
13047	Stainless steel AISI 304	12
13048		14
13049		16

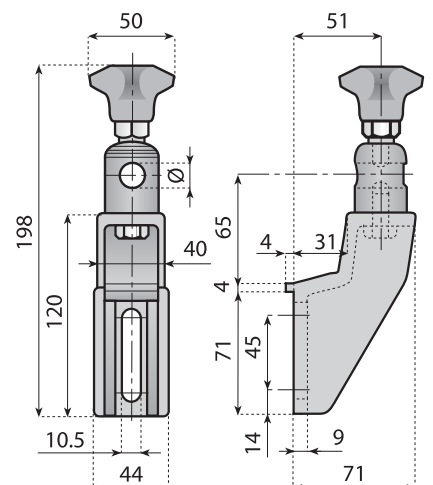

Side guide brackets



304 Stainless steel



Nickel plated brass



Polyamide



Accessories



EXTRA-BRACKET

Material: bracket in polyamide; eyebolt, and washer in stainless steel AISI 304; knob in polyamide with nickel plated brass insert.
Packaging: 25 pieces.
Note: max recommended tightening torque 4 Kgm.

Code	For rod Ø
13050	12
13051	14
13052	16

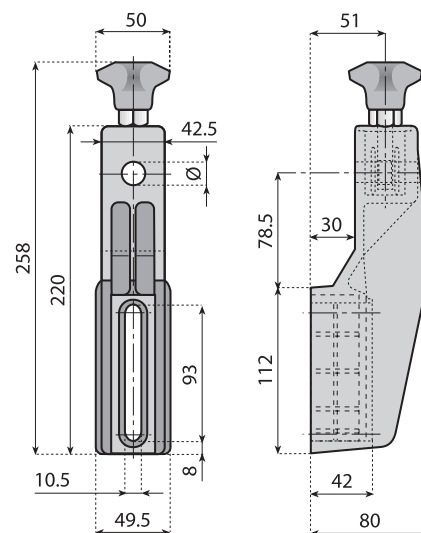

EXTRA-BRACKET

Material: bracket in polyamide; eyebolt, and washer in stainless steel AISI 304; knob in polyamide with nickel plated brass insert.
Packaging: 25 pieces.
Note: max recommended tightening torque 4 Kgm.

Code	For rod Ø
13895	12
13896	14
13897	16

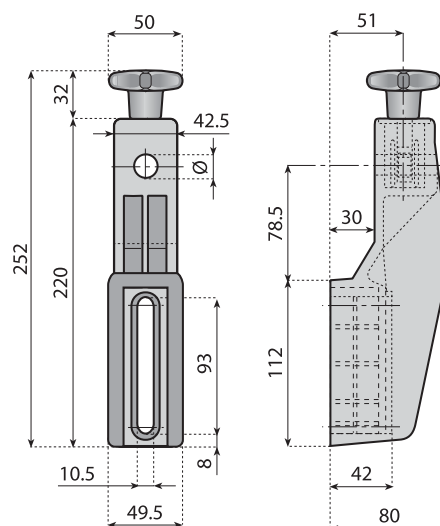

EXTRA-BRACKET

Material: bracket in polyamide; eyebolt, and washer in stainless steel AISI 304; knob in polyamide with nickel plated brass insert.
Packaging: 25 pieces.
Note: max recommended tightening torque 4 Kgm.

Code	For rod Ø
13205	12
13206	14
13207	16

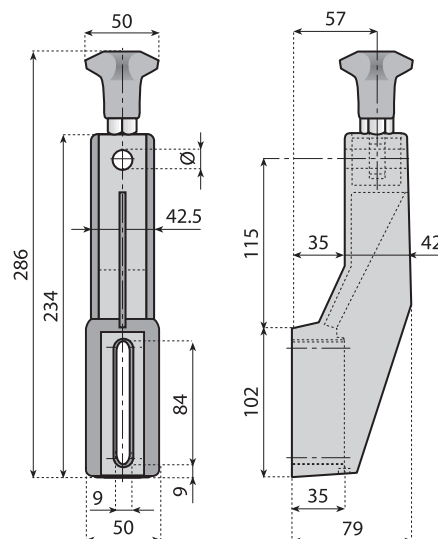

Side guide brackets



304 Stainless steel Polyamide



SIDE BRACKET FOR HORIZONTAL TUBES

Material: bracket in polyamide, nut, screws and washers in stainless steel AISI 304.

Packaging: 50 pieces.

Code

13898

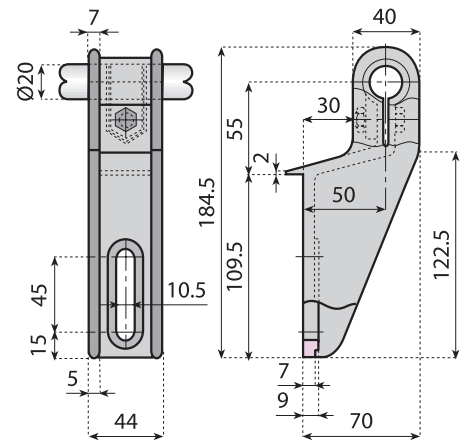

SIDE BRACKET

Material: reinforced polyamide.

Packaging: 50 pieces.

Code

13251

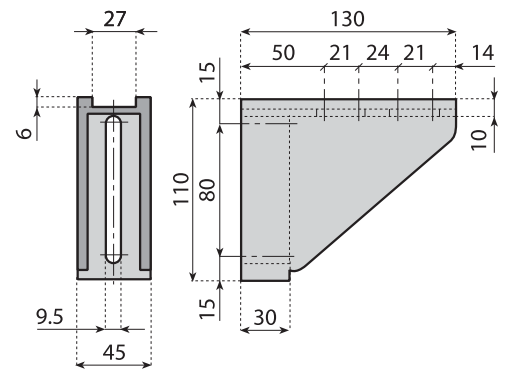

SIDE BRACKET

Material: reinforced polyamide.

Packaging: 50 pieces.

Code

13249

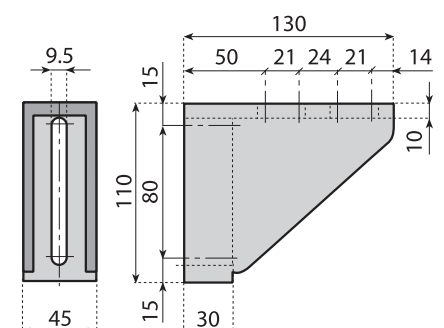

Side brackets



Polyamide



SIDE BRACKET

Material: reinforced polyamide.
Application: air conveyors for PET bottles.
Packaging: 50 pieces.

Code	For rod Ø
13930	12
13931	14
13932	16

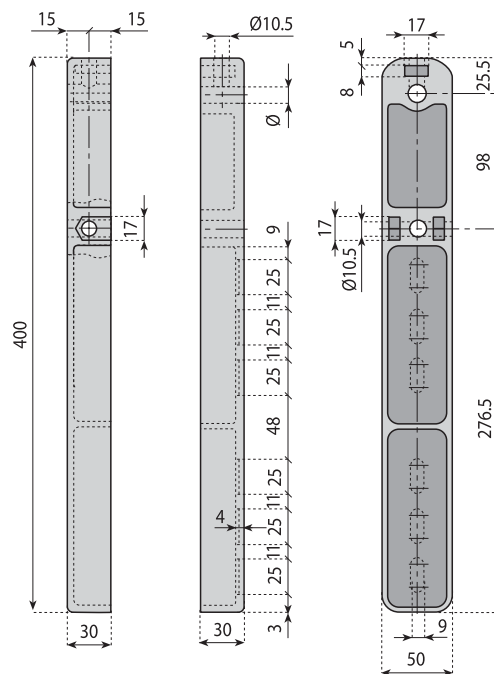

FIXED BRACKET

Material: reinforced polyamide.
Application: conveyors with fixed guides.
Packaging: 50 pieces.

Code
13057

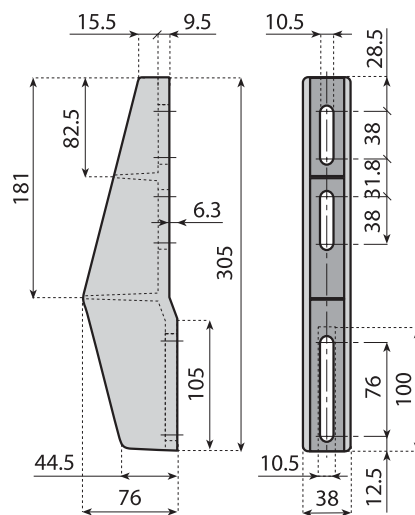

FIXED BRACKET

Material: reinforced polyamide.
Application: conveyors frames.
Packaging: 50 pieces.

Code
13900

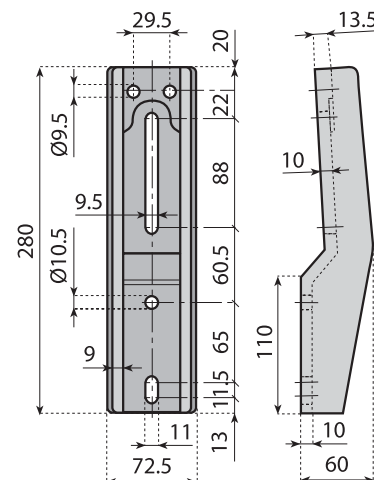

Side brackets in stainless steel



304 Stainless steel



Accessories



SIDE BRACKET

Material: stainless steel AISI 304.
Packaging: 50 pieces.

Code

13804

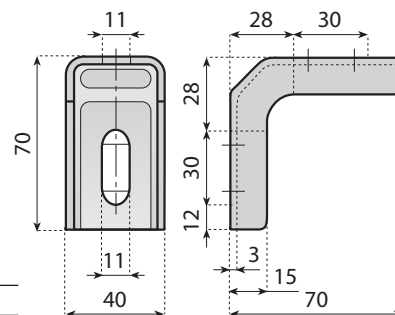

SIDE BRACKET

Material: stainless steel AISI 304.
Packaging: 50 pieces.

Code

13803

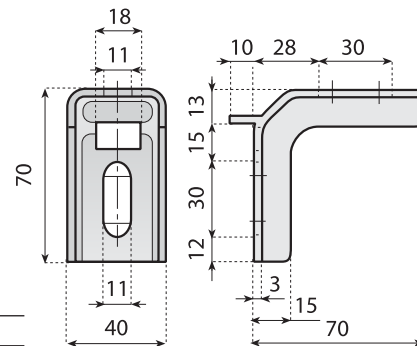

SIDE BRACKET

Material: stainless steel AISI 304.
Packaging: 50 pieces.

Code

13802

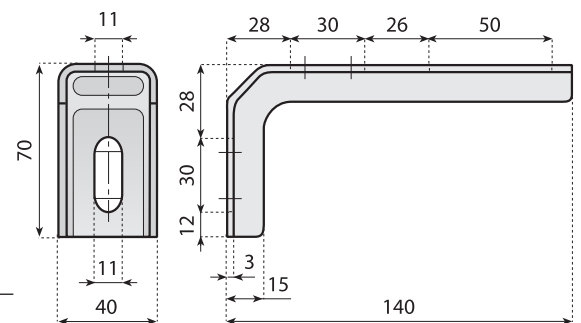

SIDE BRACKET

Material: stainless steel AISI 304.
Packaging: 50 pieces.

Code

13801

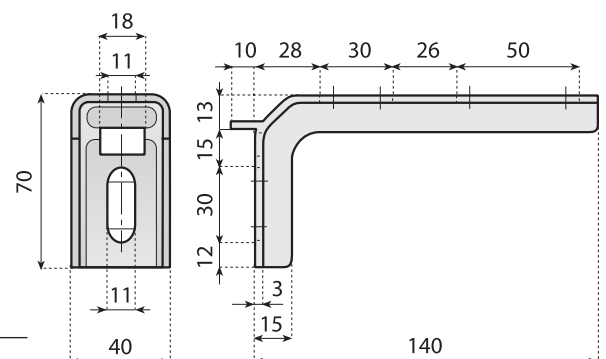

Side brackets in stainless steel



304 Stainless steel Polyamide

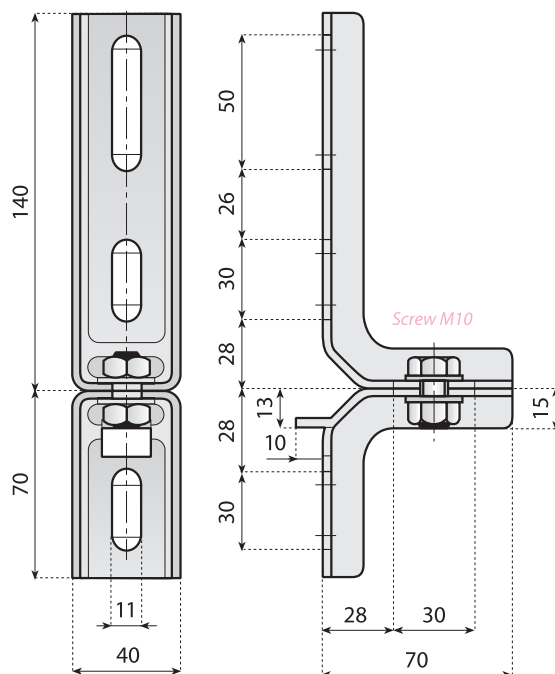

SIDE BRACKET

Material: brackets, washers and bolts in stainless steel AISI 304.

Thickness: S = 3 mm.

Surface: tumbling finish.

Packaging: 25 pieces.

Code

13805

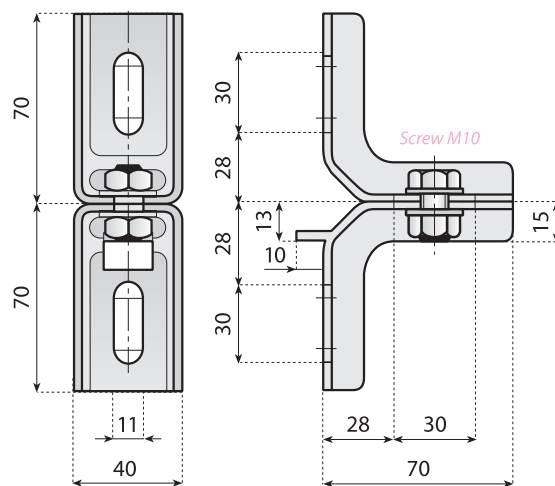

SIDE BRACKET

Material: brackets, washers and bolts in stainless steel AISI 304.

Thickness: S = 3 mm.

Surface: tumbling finish.

Packaging: 25 pieces.

Code

13806

EXAMPLE OF APPLICATIONS

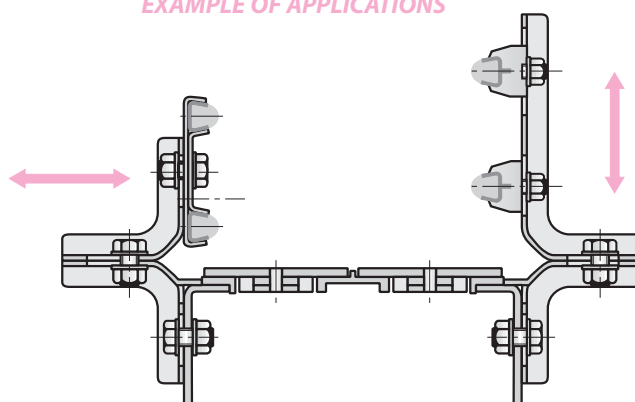

Stainless steel components



304 Stainless steel



Nickel plated brass



Polyamide



Accessories



Code

Bracket standard	Bracket with tongue	For round Ø	X	L
13815W	13815	12	40	55
13818W	13818	12	60	75
13821W	13821	12	90	105
13824W	13824	12	130	145
13816W	13816	14	40	56
13819W	13819	14	60	76
13822W	13822	14	90	106
13825W	13825	14	130	146
13817W	13817	16	40	57
13820W	13820	16	60	77
13823W	13823	16	90	107
13826W	13826	16	130	147

SIDE BRACKET WITH ADJUSTABLE HEAD

Material: bracket, head and bolts in stainless steel AISI 304. Knob in polyamide with hexagonal bushing in nickel plated brass.

Packaging: 25 pieces.

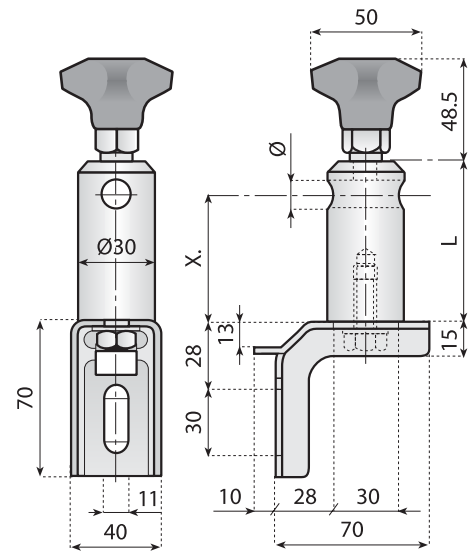

Screw M10



Code

Bracket standard	Bracket with tongue	For round Ø	X	L
131100W	131100	12	40	55
131101W	131101	12	60	75
131102W	131102	12	90	105
131103W	131103	12	130	145
131104W	131104	14	40	56
131105W	131105	14	60	76
131106W	131106	14	90	106
131107W	131107	14	130	146
131108W	131108	16	40	57
131109W	131109	16	60	77
131110W	131110	16	90	107
131111W	131111	16	130	147

SIDE BRACKET WITH ADJUSTABLE HEAD

Material: bracket, head and bolts in stainless steel AISI 304. Knob in polyamide with hexagonal bushing in nickel plated brass.

Packaging: 25 pieces.

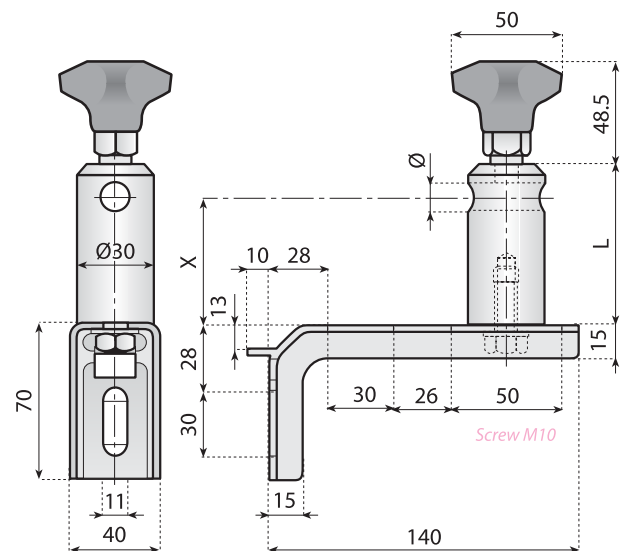

Screw M10

Side brackets in stainless steel



304 Stainless steel



Polyamide

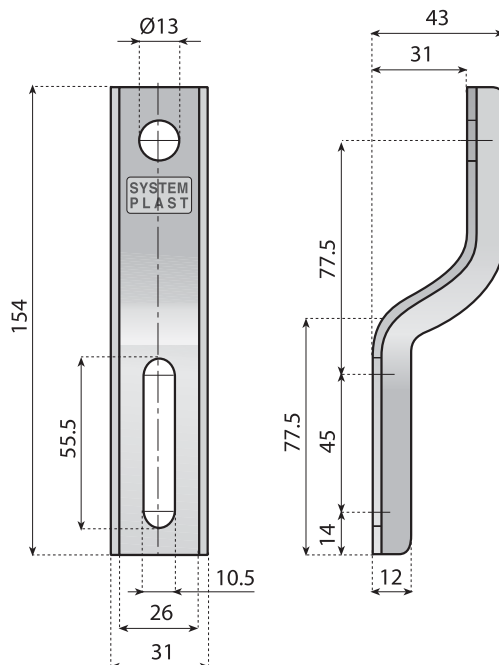

FIXED BRACKET

Material: stainless steel AISI 304.

Thickness: $S = 2.5$ mm.

Surface: tumbling finish.

Packaging: 50 pieces.

Use: support for side guides.

Code	Weight Kg
13809	0.210

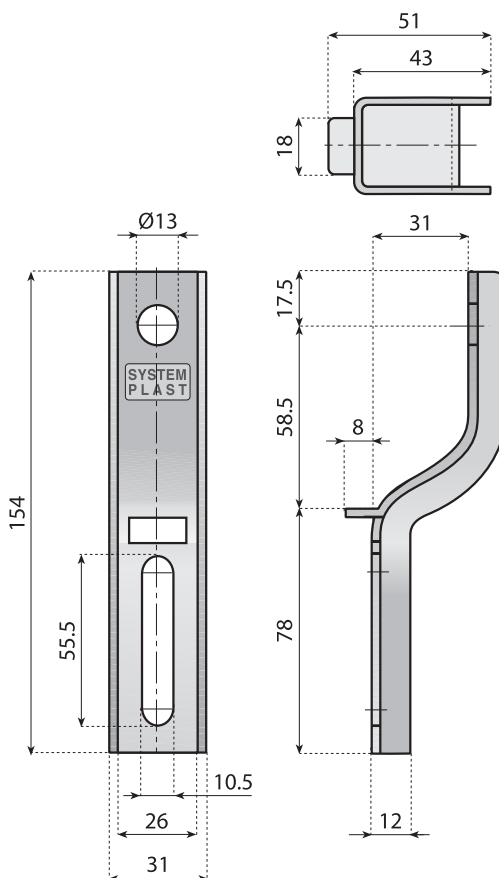

FIXED BRACKET

Material: stainless steel AISI 304.

Thickness: $S = 2.5$ mm.

Surface: tumbling finish.

Packaging: 50 pieces.

Use: support for side guides.

Code	Weight Kg
13831	0.210

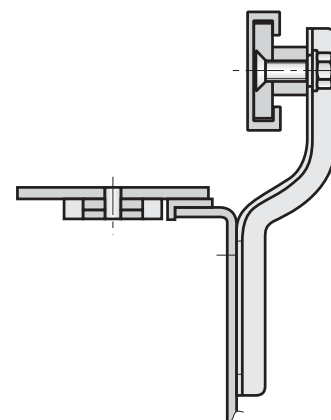

Stainless steel components



304 Stainless steel

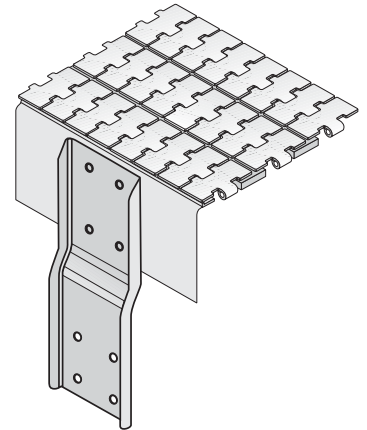
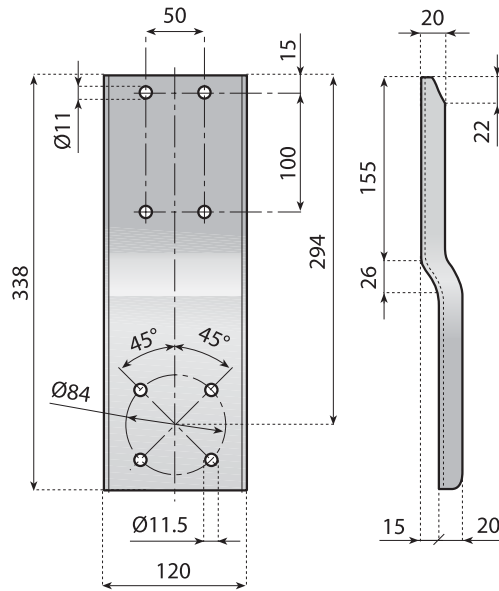

SIDE MOUNTING BRACKET

Material: stainless steel AISI 304.

Thickness: S = 3 mm.

Surface: tumbling finish.

Use: connects and supports conveyor frames.

Packaging: 10 pieces.

Code	Weight Kg
13812	-

Patent pending

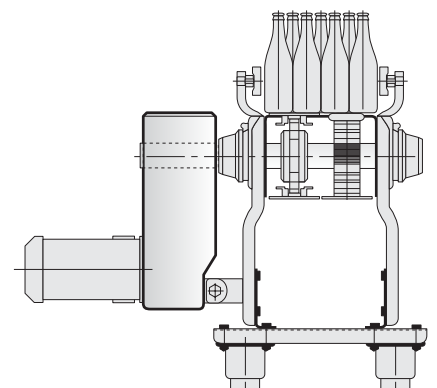
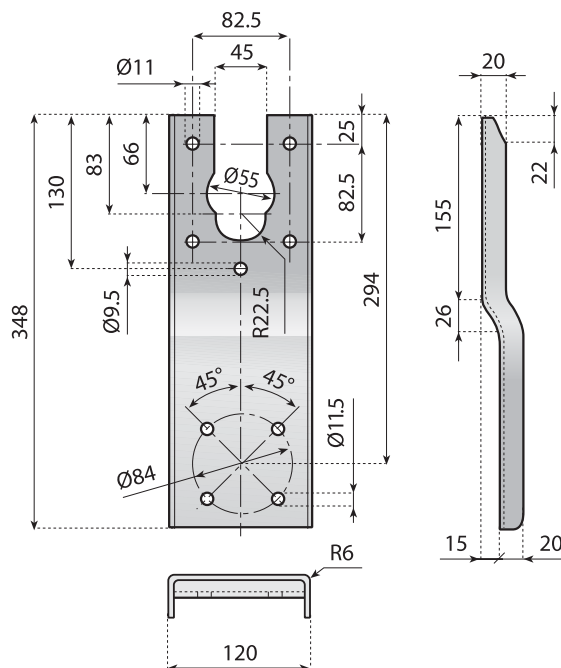

SIDE MOUNTING BRACKET

Material: stainless steel AISI 304.

Thickness: S = 3 mm.

Surface: tumbling finish.

Use: location of stainless steel bearing support on conveyor frames.

Packaging: 10 pieces.

Code	Weight Kg
13813	-

Adjustable heads and spacer

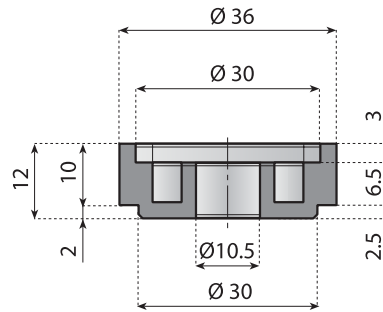

SPACER FOR ADJUSTABLE HEADS

Material: polyamide.

Code

13752

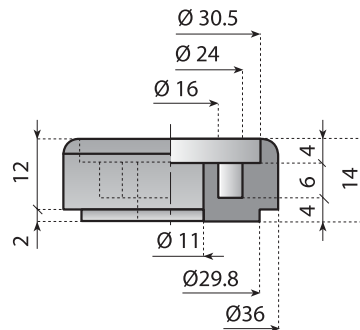

SPACER FOR ADJUSTABLE HEADS

Material: polyamide.

Code

13753

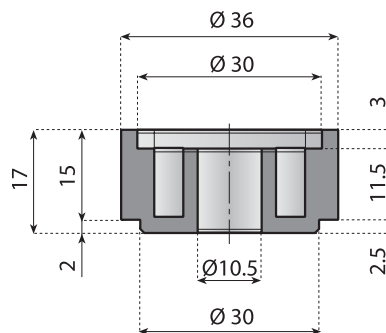

SPACER FOR ADJUSTABLE HEADS

Material: polyamide.

Code

13758

Adjustable heads

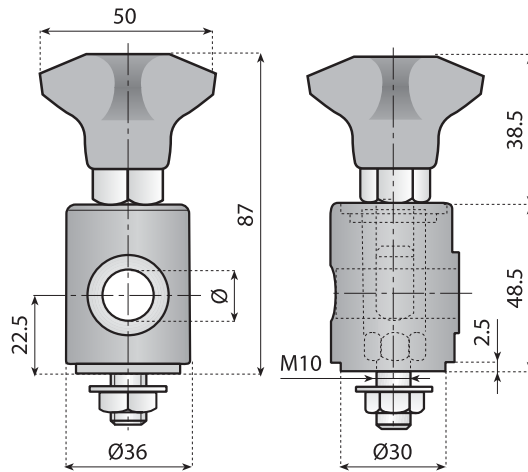

304 Stainless steel



Polyamide



Accessories

ADJUSTABLE HEAD WITH KNOB

Material: reinforced polyamide, eyebolt, screw, nut and washer in stainless steel AISI 304, hexagonal bushing in nickel plated brass.

Packaging: 50 pieces.

Code

Head with knob	Head without knob	For rod Ø
13037V	13037	12
13038V	13038	14
13039V	13039	16

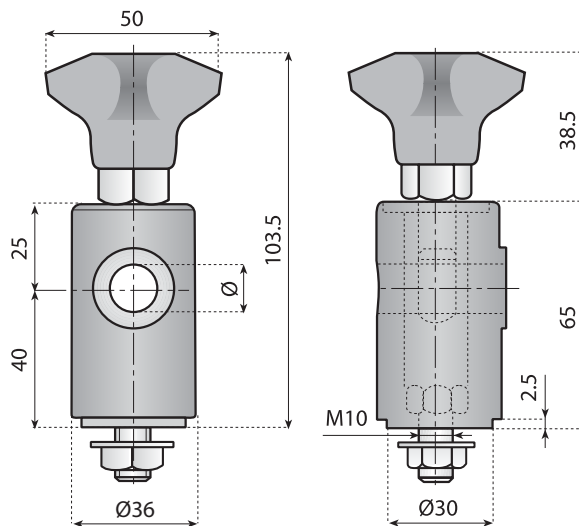

ADJUSTABLE HEAD WITH KNOB NEW TALLER VERSION

Material: reinforced polyamide, eyebolt, screw, nut and washer in stainless steel AISI 304, hexagonal bushing in nickel plated brass.

Packaging: 50 pieces.

Code

Head with knob	Head without knob	For rod Ø
13781V	13781	12
13782V	13782	14
13783V	13783	16

Adjustable heads

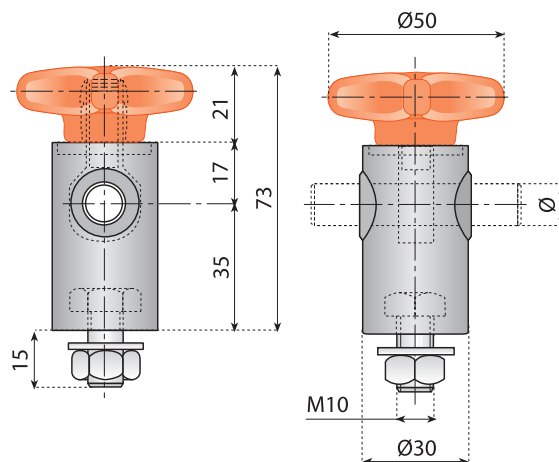

304 Stainless steel



Nickel plated brass



Polyamide



Accessories

QUICK POSITIONING ADJUSTABLE HEADS

Material: housing in reinforced polyamide; bolts and hardware in stainless steel; knobs in reinforced polyamide with brass bushing.

Packaging: 50 pieces.

Code	For rod Ø
13296V	12.5
13297V	14.5

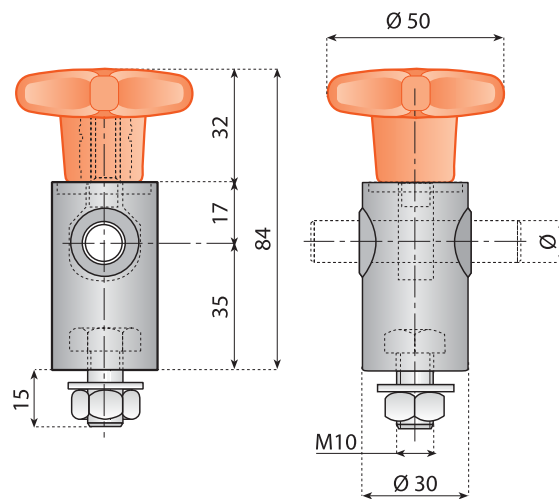

QUICK POSITIONING ADJUSTABLE HEADS

Material: housing in reinforced polyamide; bolts and hardware in stainless steel; knobs in reinforced polyamide with brass bushing.

Packaging: 50 pieces.

Code	For rod Ø
13296VA	12
13297VA	14

Adjustable heads

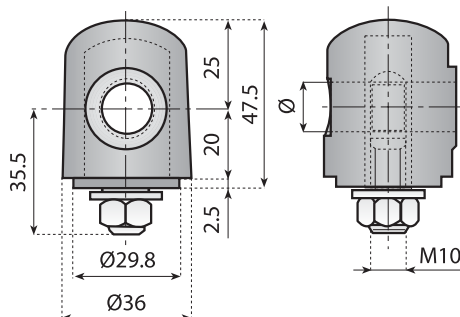

304 Stainless steel



Nickel plated brass



Polyamide



Accessories

ADJUSTABLE HEAD

Material: reinforced polyamide; eyebolt, nut and washer in stainless steel AISI 304.

Packaging: 50 pieces.

Code	For rod Ø
13028	12
13029	14
13030	16

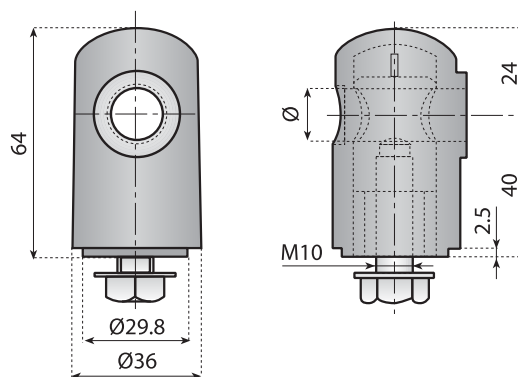

ADJUSTABLE HEAD

Material: head in reinforced polyamide, Insert in nickel plated brass, screw and washer in stainless steel AISI 304.

Packaging: 50 pieces.

Code	For rod Ø
13017	12
13018	14
13016	16

Adjustable heads

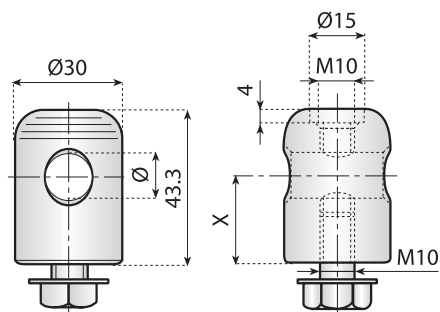

304 Stainless steel



Nickel plated brass



Polyamide



Accessories

ADJUSTABLE HEAD

Material: screws and washer in stainless steel AISI 304; head as in the table.

Packaging: 50 pieces.

Code	Head material	X	For rod Ø
13031	Nickel plated brass	24.5	12
13032		23.5	14
13033		22.5	16
13034	Stainless steel AISI 304	24.5	12
13035		23.5	14
13036		22.5	16

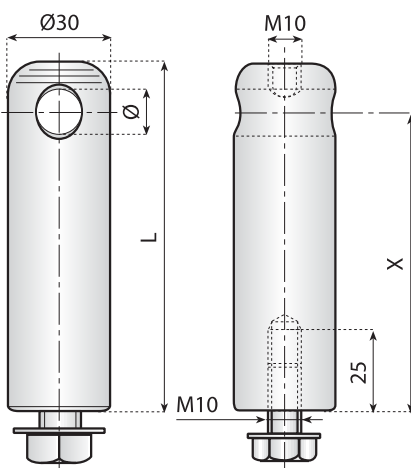

ADJUSTABLE HEAD

Material: screws and heads in stainless steel AISI 304.

Packaging: 50 pieces.

Code	L	X	For rod Ø
13121	55	40	12
13124	75	60	12
13127	105	90	12
13130	145	130	12
13122	56	40	14
13125	76	60	14
13128	106	90	14
13131	146	130	14
13123	57	40	16
13126	77	60	16
13129	107	90	16
13132	147	130	16

Adjustable heads

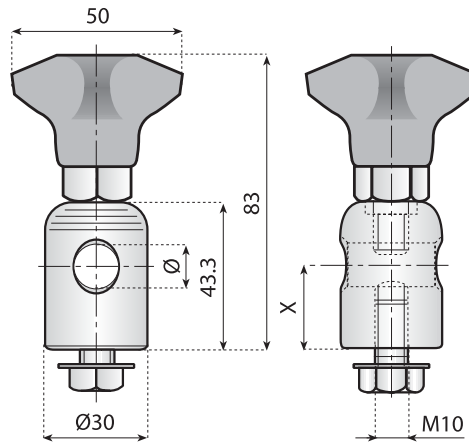

304 Stainless steel



Nickel plated brass



Polyamide



Accessories

ADJUSTABLE HEAD WITH KNOB

Material: screws and washer in stainless steel AISI 304, head as in the table, knob in polyamide with hexagonal bushing in nickel plated brass.

Packaging: 50 pieces.

Code	Head material	X	For rod Ø
13031V	Nickel plated brass	24.5	12
13032V	Nickel plated brass	23.5	14
13033V	Nickel plated brass	22.5	16
13034V	Stainless steel	24.5	12
13035V	Stainless steel	23.5	14
13036V	AISI 304	22.5	16

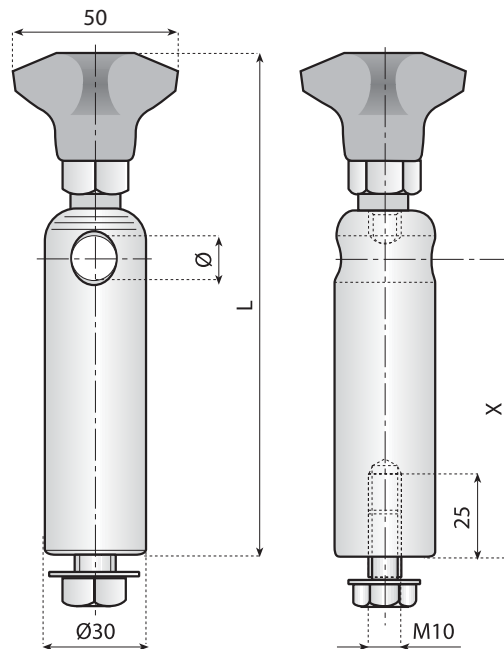

Code	L	X	For rod Ø
13121V	100	40	12
13124V	120	60	12
13127V	150	90	12
13130V	190	130	12
13122V	101	40	14
13125V	121	60	14
13128V	151	90	14
13131V	191	130	14
13123V	192	40	16
13126V	122	60	16
13129V	152	90	16
13132V	192	130	16

ADJUSTABLE HEAD WITH KNOB

Material: screws and washer in stainless steel AISI 304, knob in polyamide with hexagonal bushing in nickel plated brass.

Packaging: 50 pieces.

Quick release adjustable heads

QUICK RELEASE ADJUSTABLE HEADS

For fast line changes the new head from System Plast provides simplicity and easy in achieving the accuracy needed in adjusting multiple stations simultaneously.

- This new patented part is perfect for applications where accurate and / or frequent adjustments are required.
- Fits 12-14 mm diameter adjusting rods.
- Corrosion resistance composite components.
- Ergonomic spring loaded design.

Components:

- External Housing (polyamide)
- Internal Housing (see the table)
- Closing Cap (polyamide)
- Spring (steel)
- Screw and washer (stainless steel AISI 304)
- Nut (nickel plated brass)

Advantages:

- Rapid adjustment of guides to accommodate the choice of bottle format.
- Quick and easy maintenance.

Supply: assembled.

Packaging: 50 pieces.

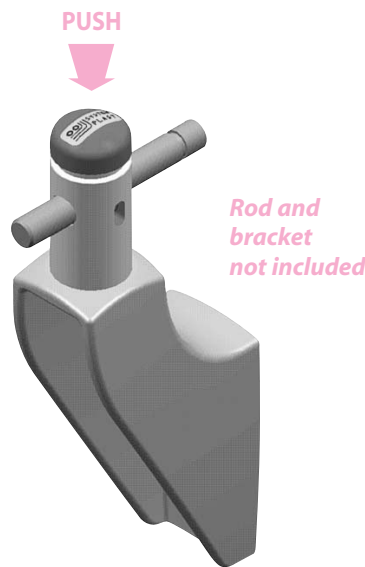

304 Stainless steel



Nickel plated brass



Polyamide



Accessories

Patent pending

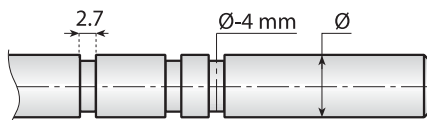

Rod dimensions

Code	Internal block	For rod Ø
13300	Reinforced polyamide	12
13301	Nickel plated brass	14
13302	Reinforced polyamide	12
13303	Nickel plated brass	14

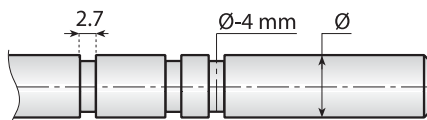
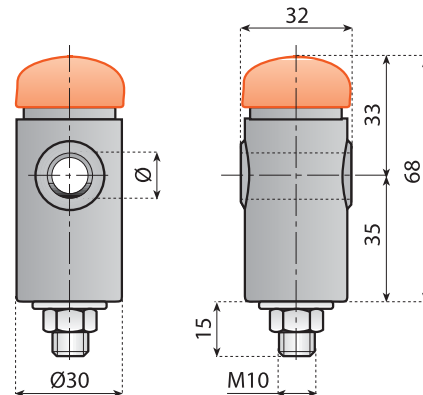

Rod dimensions

Code	Internal block	For rod Ø
13302FP	Nickel plated brass	12
13303FP	Nickel plated brass	14

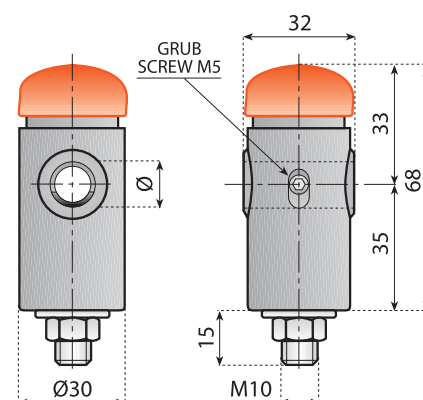

For a correct use of these products and to get the best performance, please call our engineering experts.

Dual action adjustable heads

DUAL ACTION ADJUSTABLE HEAD

For fast line changes the new Dual Action Head from System Plast provides simplicity and easy in achieving the accuracy needed in adjusting multiple stations simultaneously. By simply rotating the quick release cap, the Dual Action Head is placed in a neutral, non clamping, position. The side guides and other rails can then be moved to the desired location before returning the quick release cap to its locked position.

- This new patented part is perfect for applications where accurate and / or frequent adjustments are required.
- Fits 12-14 mm diameter adjusting rods.
- Corrosion resistance composite components.
- Ergonomic spring loaded design.

Components:

- External Housing (polyamide)
- Internal Housing (see the table)
- Closing Cap (polyamide)
- Spring (steel)
- Screw and washer (stainless steel AISI 304)
- Nut (nickel plated brass)

Supply: assembled.

Packaging: 50 pieces.

Patent pending



304 Stainless steel



Nickel plated brass



Polyamide



Accessories

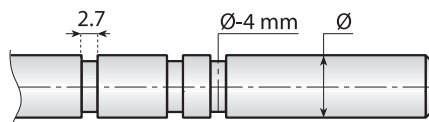

Rod dimensions



Code	Internal block	For rod Ø
13296	Reinforced polyamide	12
13297	Nickel plated brass	14
13298	Reinforced polyamide	12
13299	Nickel plated brass	14

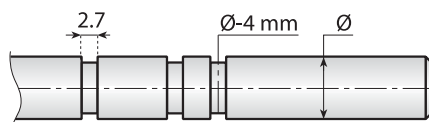
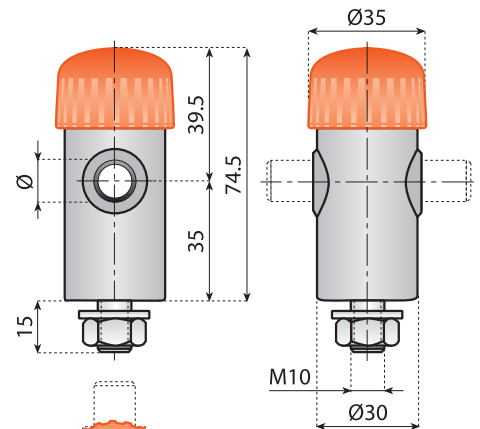

Rod dimensions



Code	Internal block	For rod Ø
13298FP	Nickel plated brass	12
13299FP	Nickel plated brass	14

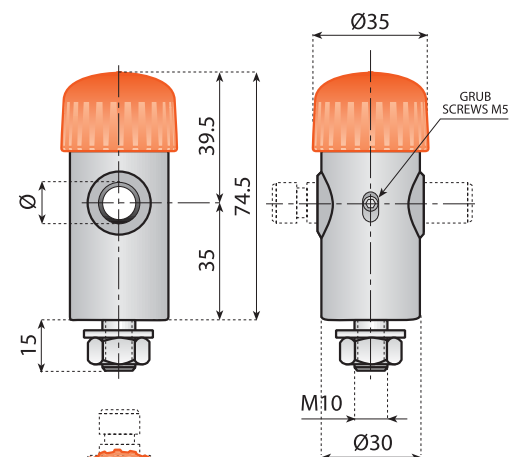

For a correct use of these products and to get the best performance, please call our engineering experts.

Spacers



Polyamide



Accessories

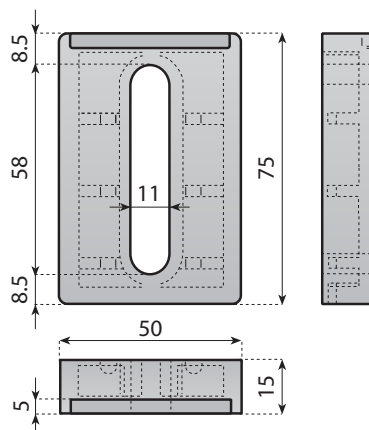

SPACER FOR BRACKETS

Material: reinforced polyamide

Application: bracket codes:

13692 - 13693 - 13696 - 13697 - 13769 - 13963

13633 - 13634 - 13635 - 13200 - 13201 - 13208

13209 - 13210.

Packaging: 50 pieces.

Code

13400

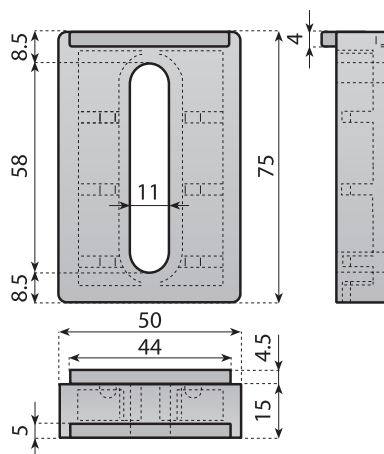

SPACER FOR BRACKETS

Material: reinforced polyamide

Application: bracket codes:

13692 - 13693 - 13696 - 13697 - 13769 - 13632

13633 - 13634 - 13635 - 13200 - 13201 - 13208

13209 - 13210 - 13040 - 13041 - 13042 - 13043

13044 - 13045 - 13046 - 13100 - 13101 - 13102

13047 - 13048 - 13049.

Packaging: 50 pieces.

Code

13399

Spacers



Polyamide



Accessories

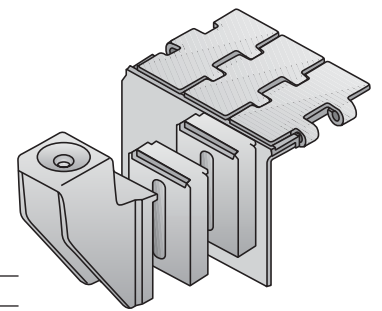
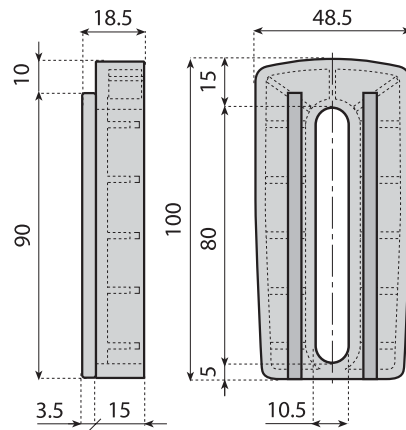

SPACER FOR BRACKETS

Material: reinforced polyamide

Application: bracket codes:

13185 - 13530 - 13531 - 13532 - 13533

13534 - 13535 - 13536 - 13537 - 13538

13539 - 13540 - 13541 - 13542 - 13543

13544 - 13545 - 13546 13547.

Packaging: 50 pieces.

Code

13187

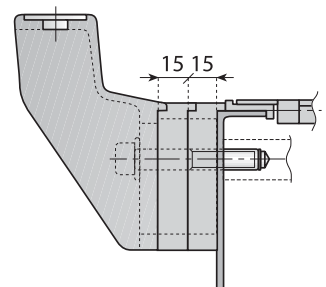
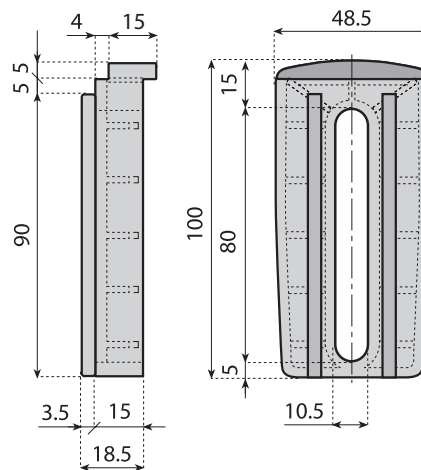

SPACER FOR BRACKETS

Material: reinforced polyamide

Application: bracket codes:

13186 - 13580 - 13581 - 13582 - 13583

13584 - 13585 - 13586 - 13587 - 13588

13589 - 13590 13591 - 13592 - 13593

13594 - 13595 - 13596 - 13597.

Packaging: 50 pieces.

Code

13188

Spacers



SPACER FOR BRACKETS

Material: reinforced polyamide

Application: bracket codes:

13020 - 13021 - 13022 - 13023 - 13024
 13025 - 13026 - 13027 - 13050 - 13051
 13052 - 13054 - 13055 - 13056 - 13088
 13089 - 13746 - 13747 - 13748 - 13749
 13750 - 13751.

Packaging: 50 pieces.

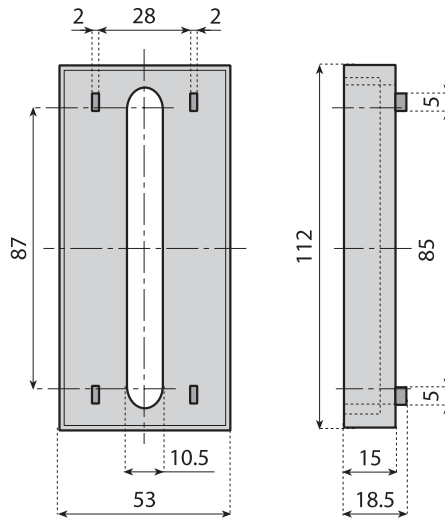

Code

13019



304 Stainless steel Polyamide Accessories

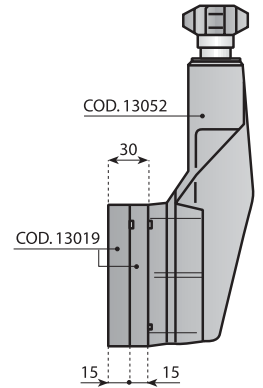

SPACER FOR BRACKETS

Material: reinforced polyamide

Application: bracket codes:

13020 - 13021 - 13088 - 13089 - 13847
 13848 - 13849 - 13054 - 13055 - 13056
 13886 - 13887 - 13888 - 13749 - 13750
 13751 - 13746 - 13747 - 13748 - 13025
 13026 - 13027 - 13022 - 13023 - 13024

Packaging: 50 pieces.

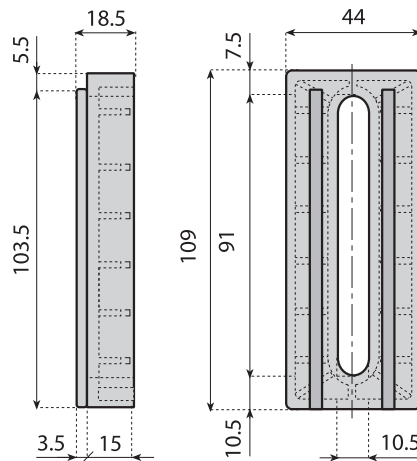

Code

13189

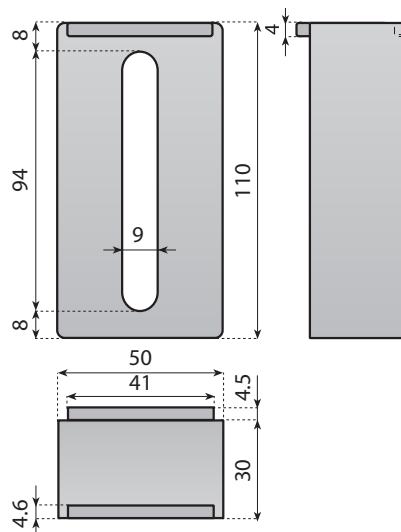

Code

13198

SPACER FOR BRACKETS

Material:

Application:

Drip tray supports



DRIP TRAY SUPPORTS

Material: metal support in stainless steel AISI 304, clamp in polyamide.

Accessories: fixing washer code 13252

Application: drip tray supports can be used with the following brackets:

13020 - 13021 - 13022 - 13023 - 13024 - 13025 - 13026 - 13027
 13050 - 13051 - 13052 - 13054 - 13055 - 13056 - 13088 - 13089
 13205 - 13206 - 13207 - 13746 - 13747 - 13748 - 13749 - 13750
 13751 - 13767 - 13768 - 13200 - 13201 - 13692 - 13693 - 13696
 13697 - 13769 - 13632 - 13633 - 13634 - 13635 - 13208 - 13209
 13210.

Drip tray supports can also be used with spacers code:
 13019 - 13399 - 13400.

Packaging: 50 pieces.

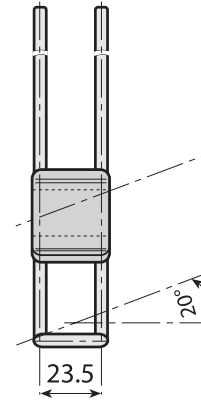

304 Stainless steel



Polyamide



Accessories

DRIP TRAY SUPPORTS - AVAILABLE VERSIONS

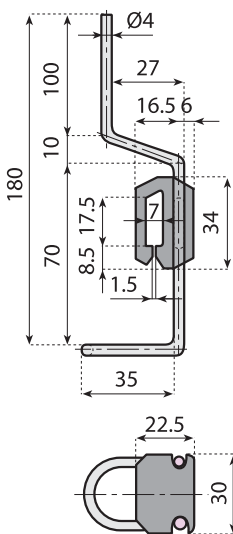

Code **13250** L 184 mm

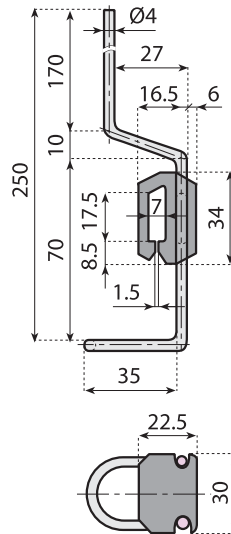

Code **13253** L 254 mm

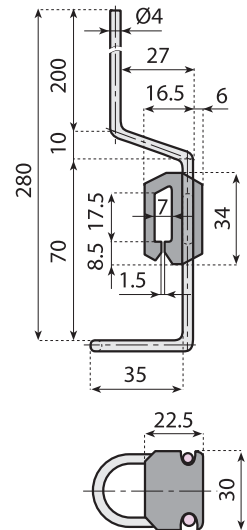

Code **13254** L 284 mm

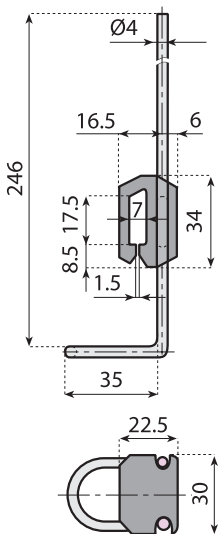

Code **13255** L 250 mm

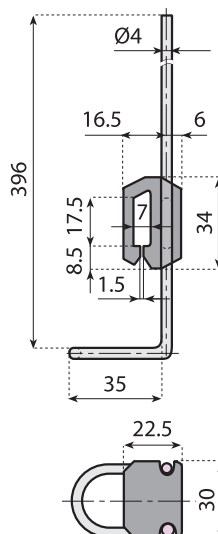

Code **13256** L 400 mm

Drip tray supports



DRIP TRAY SUPPORTS

Material: metal support in stainless steel AISI 304, clamp in polyamide.

Accessories: fixing washer code 13252

Application: drip tray supports can be used with the following brackets:

13020 - 13021 - 13022 - 13023 - 13024 - 13025 - 13026 - 13027
 13050 - 13051 - 13052 - 13054 - 13055 - 13056 - 13088 - 13089
 13205 - 13206 - 13207 - 13746 - 13747 - 13748 - 13749 - 13750
 13751 - 13767 - 13768 - 13200 - 13201 - 13692 - 13693 - 13696
 13697 - 13769 - 13632 - 13633 - 13634 - 13635 - 13208 - 13209
 13210.

Drip tray supports can also be used with spacers code:
 13019 - 13399 - 13400.

Packaging: 50 pieces.

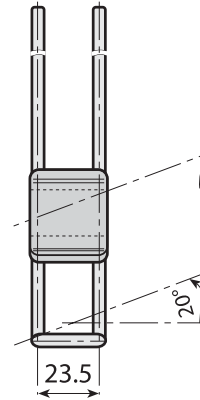

304 Stainless steel



Polyamide



Accessories

DRIP TRAY SUPPORTS - AVAILABLE VERSIONS

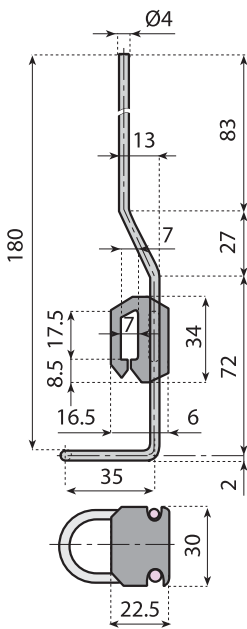

Code **13257** L 184 mm

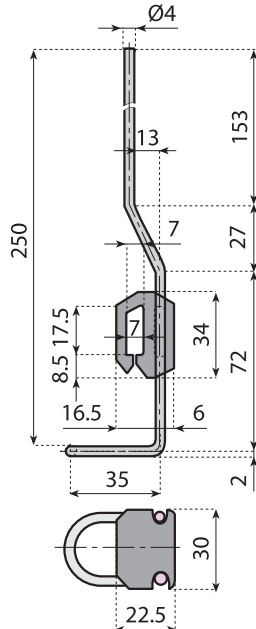

Code **13258** L 254 mm



FIXING WASHER

Material: polyamide, washer in stainless steel AISI 304.

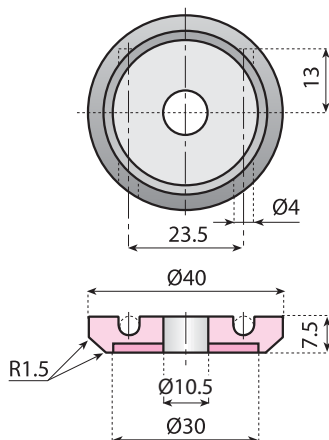

Code **13252**

